



CITY OF CUPERTINO

SIDEWALK CONSTRUCTION - MCCLELLAN ROAD

PROJECT # 2016-20

HMM
 Land Use Entitlements
 Land Planning
 Landscape Architecture
 Civil Engineering
 Utility Design
 Land Surveying
 Stormwater Compliance

1570 Oakland Road (408) 487-2200
 San Jose, CA 95131 HMMca.com



NOTES

- ALL WORK SHALL BE IN ACCORDANCE WITH THE PROJECT PLANS, STATE OF CALIFORNIA DEPARTMENT OF TRANSPORTATION STANDARD SPECIFICATIONS (2010 EDITION), AND STANDARD PLANS (2010 EDITION), AND THE CITY OF CUPERTINO STANDARD DETAILS. THE CONTRACTOR SHALL PERFORM THE WORK AS SHOWN ON THE DRAWINGS, AND TO THE SATISFACTION OF THE CITY ENGINEER.
- APPROVAL OF THESE PLANS SHALL NOT RELEASE THE OWNER OR CONTRACTOR OF THE RESPONSIBILITY FOR CORRECTIONS OF MISTAKES, ERRORS, OR OMISSIONS CONTAINED THEREIN. IF DURING THE COURSE OF CONSTRUCTION OF IMPROVEMENTS, PUBLIC INTEREST REQUIRES A MODIFICATION OF/ OR A DEPARTURE FROM THE CITY OF CUPERTINO STANDARD DETAILS OR THESE IMPROVEMENT PLANS, THE CITY ENGINEER SHALL HAVE THE AUTHORITY TO REQUIRE SUCH MODIFICATION OR DEPARTURE AND TO SPECIFY THE MANNER IN WHICH THE SAME IS TO BE COMPLETED, AT THE SOLE EXPENSE OF THE OWNER OR CONTRACTOR.
- IT SHALL BE THE RESPONSIBILITY OF THE CONTRACTOR TO ENSURE THE APPROVED PLANS OR THE LATEST REVISED PLANS ARE FURNISHED TO ITS SUBCONTRACTORS, AND TO ENSURE THE LATEST APPROVED PLANS ARE ONSITE AT ALL TIMES DURING CONSTRUCTION.
- THE CONTRACTOR SHALL NOTIFY THE INSPECTOR TWO (2) WORKING DAYS PRIOR TO REQUIRING AN INSPECTION.
- NOTIFY THE CITY INSPECTOR TWO (2) WORKING DAYS IN ADVANCE OF REQUIRING SERVICES FOR CHECKING FIELD STAKING. THREE (3) COPIES OF THE CUT SHEETS SHALL BE FURNISHED TO THE CITY INSPECTOR.
- CONSTRUCTION SURVEY STAKES OR MARKS (CONTROL STAKES) TO ESTABLISH LINES AND GRADES SHALL BE SET BY THE CONTRACTOR'S SURVEYOR OR ENGINEER.
- CITY STANDARD STREET MONUMENTS AND OTHER PERMANENT MONUMENTS DISTURBED DURING CONSTRUCTION SHALL BE REPLACED BEFORE ACCEPTANCE OF THE IMPROVEMENTS BY THE CITY ENGINEER. ATTENTION IS DIRECTED TO SECTION 8771 OF THE CALIFORNIA BUSINESS AND PROFESSIONS CODE FOR THE REQUIREMENTS CONCERNING SURVEY MONUMENTS. EXISTING SURVEY MONUMENTS SHALL BE LOCATED AND REFERENCED BY OR UNDER THE DIRECTION OF A LICENSED LAND SURVEYOR OR REGISTERED CIVIL ENGINEER PRIOR TO CONSTRUCTION OPERATIONS, AND A CORNER RECORD OR RECORD OF SURVEY SHALL BE FILED WITH THE COUNTY SURVEYOR OF THE COUNTY OF SANTA CLARA. EXISTING SURVEY MONUMENTS SHALL BE RESET TO FINISH GRADE, AND A CORNER RECORD OR RECORD OF SURVEY SHALL BE FILED WITH THE COUNTY SURVEYOR OF THE COUNTY OF SANTA CLARA PRIOR TO THE RECORDING OF THE CERTIFICATE OF COMPLETION FOR THE PROJECT.
- CONSTRUCTION AREA TRAFFIC CONTROL DEVICES SHALL BE INSTALLED PRIOR TO BEGINNING WORK.
- CONTRACTOR SHALL REPLACE IN FULL ALL PAINT MARKINGS AND STRIPES AFFECTED BY CONSTRUCTION. PLACEMENT AND REMOVAL OF PAINT STRIPING SHALL BE IN ACCORDANCE WITH CALTRANS 2010 STANDARD SPECIFICATIONS SECTION 84-3 - TRAFFIC STRIPES AND PAVEMENT MARKINGS, AND SECTION 15-2.02C - REMOVE TRAFFIC STRIPE AND PAVEMENT MARKINGS, RESPECTIVELY.
- EXISTING PAVEMENT THAT IS REMOVED OR DAMAGED DURING CONSTRUCTION SHALL BE REPLACED AS REQUIRED BY THE CITY ENGINEER.
- ALL NEW PAVEMENT SHALL MATCH THE EXISTING PAVEMENT SECTION AND SHALL CONSIST OF A MINIMUM OF 4" HOT MIX ASPHALT ON 8" CLASS 2 AGGREGATE BASE.
- CONCRETE FOR USE IN ALL CONCRETE STRUCTURES SHALL CONFORM TO CALIFORNIA DEPARTMENT OF TRANSPORTATION STANDARD SPECIFICATIONS SECTION 90, DROP INLETS, SIDEWALKS, CURBS AND GUTTERS SHALL CONTAIN 590 LBS. OF CEMENT PER CUBIC YARD AND SHALL ATTAIN A MINIMUM STRENGTH OF 3,000 PSI IN 28 DAYS.
- ONE POUND OF DISPERSING BLACK SHALL BE MIXED WITH EACH CUBIC YARD OF CONCRETE AT THE BATCH PLANT.
- DRIVEWAY CONFORMS SHALL CONSIST OF 4" PCC ON 4" CLASS 2 AB.
- A MINIMUM THICKNESS OF 5" OF CONCRETE SHALL BE REQUIRED FOR COMMERCIAL DRIVEWAY APPROACHES AND 4" FOR RESIDENTIAL. THE DRIVEWAY APPROACH SHALL BE INSTALLED CONCURRENT WITH THE CONSTRUCTION OF THE CURB AND GUTTER.
- CONTRACTOR SHALL BE RESPONSIBLE TO ENSURE COMPLIANCE WITH AMERICANS WITH DISABILITIES ACT (ADA) FOR ALL AFFECTED PAVEMENT AND SIDEWALK FEATURES.
- CURB RAMP SHALL BE CALTRANS CASE A OR CASE G PER CALTRANS 2010 STANDARD PLAN A88A DATED MAY 20, 2011. DETECTABLE WARNING SURFACE SHALL BE REPLACEABLE AND SHALL CONFORM TO CALTRANS STANDARD SPECIFICATIONS SECTION 73.
- ALL TRENCH BACKFILL, FILL AREAS, AND BASE MATERIAL SHALL ATTAIN A MINIMUM 95% RELATIVE COMPACTION. FOR TYPICAL TRENCH SECTIONS, EXCEPT FOR SANITARY SEWERS, REFER TO THE CITY STANDARD DETAILS.
- TRENCH PLATES IN THE TRAVELED WAY SHALL BE TRAFFIC RATED, PROPERLY SECURED AND SHALL BE RECESSED UPON THE REQUEST OF THE DIRECTOR OF PUBLIC WORKS.
- ALL TRENCHES LOCATED WITHIN 5' OF THE EDGE OF PAVEMENT (I.E. CURB, LIP OF GUTTER, EDGE OF PAVEMENT, ETC.) SHALL BE REPAVED TO THE EDGE OF PAVEMENT.
- THE CONTRACTOR SHALL LOCATE ALL UNDERGROUND FACILITIES IN THE AREA OF WORK. THE CONTRACTOR SHALL CONTACT UNDERGROUND SERVICE ALERT (USA) AT 811 TWO (2) WORKING DAYS IN ADVANCE OF ANY WORK FOR LOCATION OF THE UNDERGROUND FACILITIES.
- STORM DRAIN LINES MODIFIED AS PART OF THE WORK ON THESE PLANS SHALL BE CLEARED OF ALL DEBRIS AND OBSTRUCTIONS PRIOR TO FINAL ACCEPTANCE.
- DROP INLETS SHALL BE CONSTRUCTED CONFORMING TO CITY STANDARD DETAILS UNLESS OTHERWISE NOTED ON THE PLANS. DROP INLETS SHALL BE INSTALLED CONCURRENT WITH THE CONSTRUCTION OF CURB AND GUTTER "NO DUMPING FLOWS TO THE BAY." PLAQUE SHALL BE INSTALLED ON THE CURB ADJACENT TO ALL INLETS AND WILL BE FURNISHED BY THE CITY. CONTRACTOR MAY CONSTRUCT INLETS AS CAST-IN-PLACE OR AS PRECAST ELEMENTS WHICH CONFORM TO THE DIMENSIONS INDICATED ON CITY OF CUPERTINO STANDARD DETAIL 3-2.
- MANHOLE FRAMES AND COVERS AND ALL OTHER UTILITY SURFACE FACILITIES SHALL BE BROUGHT TO FINISHED GRADE PRIOR TO FINAL SIGNOFF.
- ALL WATER LINES, VALVES, HYDRANTS, AND APPURTENANCES THERETO INSTALLED WITHIN THE PUBLIC RIGHT-OF-WAY SHALL BE PROPERTY OF THE WATER UTILITY COMPANY.
- ADJUSTMENT OF UTILITY BOXES SHALL BE PERFORMED IN ACCORDANCE WITH THE SPECIFICATIONS AND REQUIREMENTS OF THE UTILITY OWNER. CONTRACTOR SHALL COORDINATE WITH APPLICABLE UTILITY COMPANIES FOR INSPECTION REQUIREMENTS INCLUDING PG&E, AT&T, SJWC, AND CSD.
- TREES, ROOTS, AND FOREIGN MATTER IN EXISTING OR PROPOSED RIGHT-OF-WAY SHALL BE REMOVED TO A DEPTH OF 2' BELOW SUBGRADE AND DISPOSED PER CALTRANS STANDARDS. IN THE CASE OF LIVE TREE ROOTS FROM CITY STREET TREES, CONTRACTOR SHALL CONTACT THE CITY FOR FIELD OBSERVATION PRIOR TO REMOVING TREE ROOTS.
- CONTRACTOR SHALL TRIM EXISTING TREES AS NECESSARY TO MAINTAIN 10' CLEARANCE ABOVE PROPOSED SIDEWALKS AND AS NECESSARY FOR CONSTRUCTION
- CONTRACTOR SHALL INSTALL TOP SOIL TO A DEPTH OF 8" BELOW FG IN ALL CONSTRUCTED PARKSTRIPS AND AREAS OF CURB, GUTTER AND SIDEWALK REMOVAL WHERE HARDSCAPE IS NOT REPLACED. FLUSH WITH BACK OF CURB, FRONT OF SIDEWALK, AND EXISTING UTILITY BOXES.

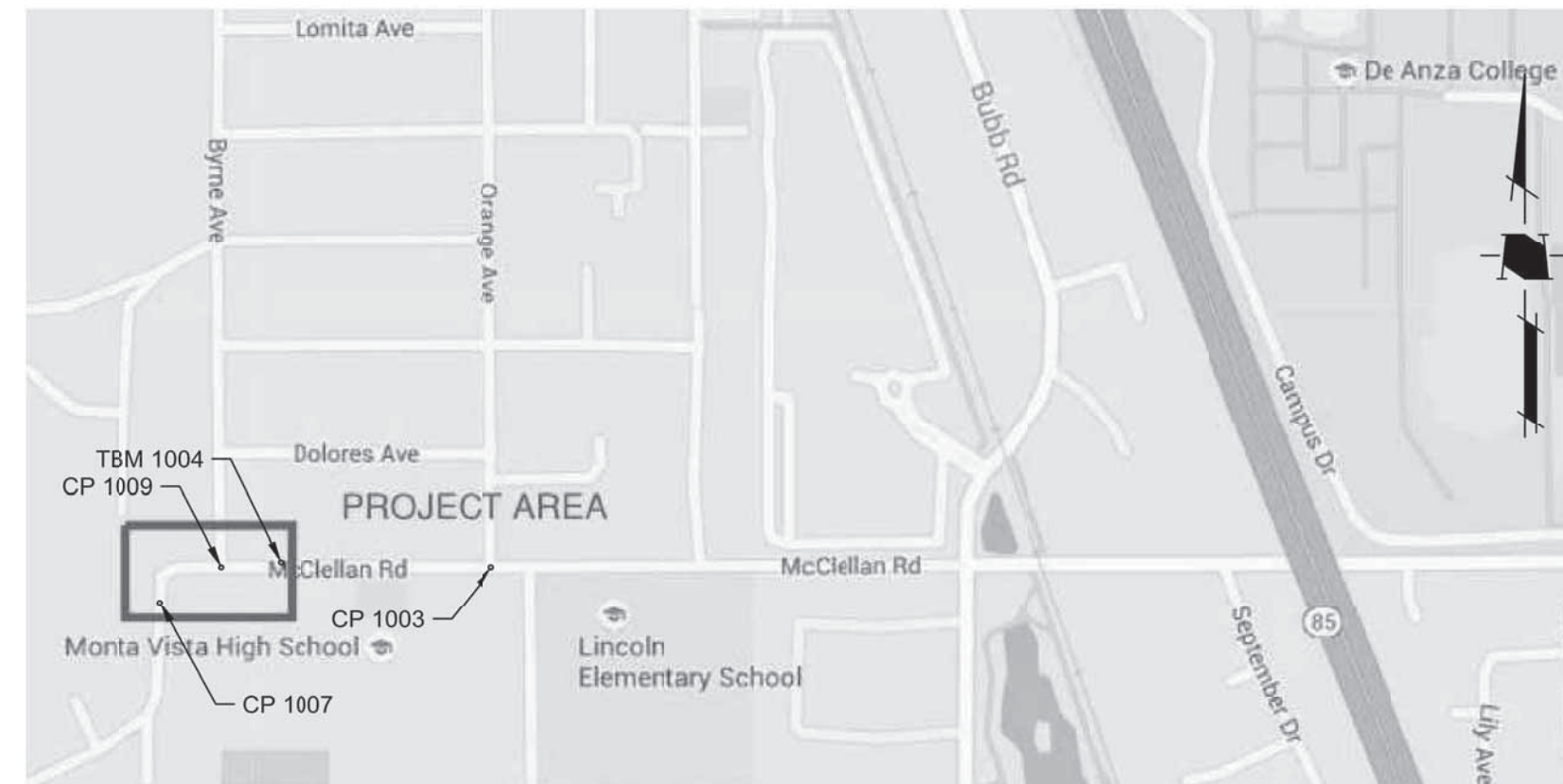

VICINITY MAP
NOT TO SCALE

HORIZONTAL CONTROL

CP	NORTHING	EASTING	DESCRIPTION
1003	1941127.11	6109318.64	FOUND IRON PIPE IN MON BOX
1007	1941090.56	6108292.15	FOUND BRASS DISK IN MON BOX
1009	1941138.21	6108477.08	FOUND GRANITE MON IN MON BOX

BENCHMARK

ELEV DATUM: SCVWD BM1071, ELEV=327.04' (NAVD88). DATE ADJUSTED MAY 4, 2010, "SCVWD BRASS DISK (R180); ON TOP OF THE SOUTHERLY CURB OF STEVENS CREEK BOULEVARD AT APPROXIMATELY 200 FEET WESTERLY OF PENINSULA/BUBB ROAD AND NEAR RAILROAD CROSSING POLE #22118. ALSO, 2.5 FEET NORTH OF THE RAILROAD CROSSING LIGHTS, AND 20 FEET WEST FROM THE CENTER OF THE TRACKS. CITY OF CUPERTINO"

PROJECT TBM: PT 1004, ELEV=372.86'. SET MAG IN AC BERM NORTH SIDE OF MCCLELLAN AVE IN FRONT OF ADDRESS 21901, ±18' FROM CENTERLINE OF DRIVEWAY

CITY OF CUPERTINO APPROVAL

APPROVED BY: _____

TIMM BORDEN, RCE 45512, DIRECTOR OF PUBLIC WORKS

DATED: _____

REVIEWED BY: _____

SHEET INDEX

SHEET	DWG	DRAWING
1	TS01	TITLE SHEET
2	DT01	DETAILS
3	DT02	DETAILS
4	DT03	DETAILS
5	IP01	IMPROVEMENT PLANS
6	IP02	IMPROVEMENT PLANS
7	EC01	CONSTRUCTION BEST MANAGEMENT PRACTICES

CITY OF CUPERTINO
MCCLELLAN ROAD
SIDEWALK CONSTRUCTION
 CUPERTINO, CALIFORNIA

NO	DATE	DESCRIPTION

PROJECT NO:	4844.00
CAD DWG FILE:	484400TS01.DWG
DESIGNED BY:	LA
DRAWN BY:	LA
CHECKED BY:	JC
DATE:	06/15/2016

HMM

TITLE SHEET

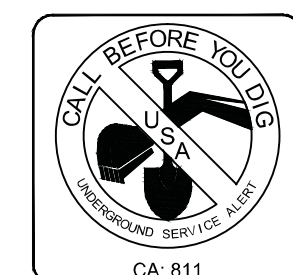

TS01

1 OF 7



Land Use Entitlements
Land Planning
Landscape Architecture
Civil Engineering
Utility Design
Land Surveying
Stormwater Compliance

1570 Oakland Road (408) 487-2200
San Jose, CA 95131 HMHca.com

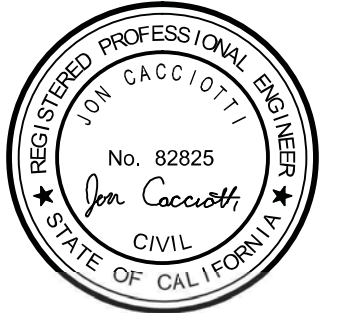

CITY OF CUPERTINO
MCCLELLAN ROAD
SIDEWALK CONSTRUCTION
CUPERTINO, CALIFORNIA

NO	DATE	DESCRIPTION

PROJECT NO.	4844.00
CAD DWG FILE:	484400D701.DWG
DESIGNED BY:	LA
DRAWN BY:	LA
CHECKED BY:	JC
DATE:	08/15/2016

HMH

DETAILS

DT01

LEGEND

PUBLIC STREET EASEMENT

FIBER OPTICS

UNDERGROUND COMMUNICATIONS

WATER

UNDERGROUND GAS

OVERHEAD ELECTRIC OR COMMUNICATIONS

UNDERGROUND ELECTRIC

STORM DRAIN

SANITARY SEWER

UNDERGROUND COMMUNICATIONS

RIGHT OF WAY

PROPERTY LINE

SAWCUT LINE

ABANDONED UTILITY

STREET LIGHT

VALVE

FIRE HYDRANT

UTILITY BOX/ WATER METER

POWER POLE

CLEANOUT

SANITARY SEWER MANHOLE

STORM DRAIN CURB INLET

STORM DRAIN INLET

STORM DRAIN MANHOLE

TREE

ROADSIDE SIGN

DRIVEWAY

DRAINAGE FLOW DIRECTION

OVERLAND RELEASE

CONCRETE

ASPHALT

MONUMENT

REMOVE EXISTING CURB, GUTTER AND SIDEWALK AND REPLACE WITH 8" TOP SOIL. SEE NOTE 29.

ABBREVIATIONS

AB	AGGREGATE BASE
AC	ASPHALTIC CONCRETE OR HOT MIX ASPHALT PER CALTRANS STANDARD SPECIFICATIONS
AT&T	AMERICAN TELEPHONE & TELEGRAPH
BOC	BACK OF CURB
BOW	BACK OF WALK
CL	CENTERLINE
CONC	CONCRETE
CONF	CONFORM
CP	CONTROL POINT
CSD	CUPERTINO SANITARY DISTRICT
DI	DROP INLET
E	EAST
EXIST	EXISTING
FC	FACE OF CURB
FG	FINISHED GRADE
FGW	FRONT OF WALK
FL	FLOW LINE
GB	GRADE BREAK
HMA	HOT MIX ASPHALT
HP	HIGH POINT
INV	INVERT
N	NORTH
OG	ORIGINAL GRADE
PG&E	PACIFIC GAS & ELECTRIC
PCC	PORTLAND CEMENT CONCRETE
PVC	POLYVINYL CHLORIDE
S	SOUTH
SD	STORM DRAIN
SDCB	STORM DRAIN CATCH BASIN
SDI	STANDARD DROP INLET PER CUPERTINO STANDARD DETAIL 3-2
SDR	STANDARD DIMENSION RATIO
SJWC	SAN JOSE WATER COMPANY
STD	STANDARD
TC	TOP OF CURB
TG	TOP OF GRATE
TOL	TOP OF LIP
TYP	TYPICAL
W	WEST

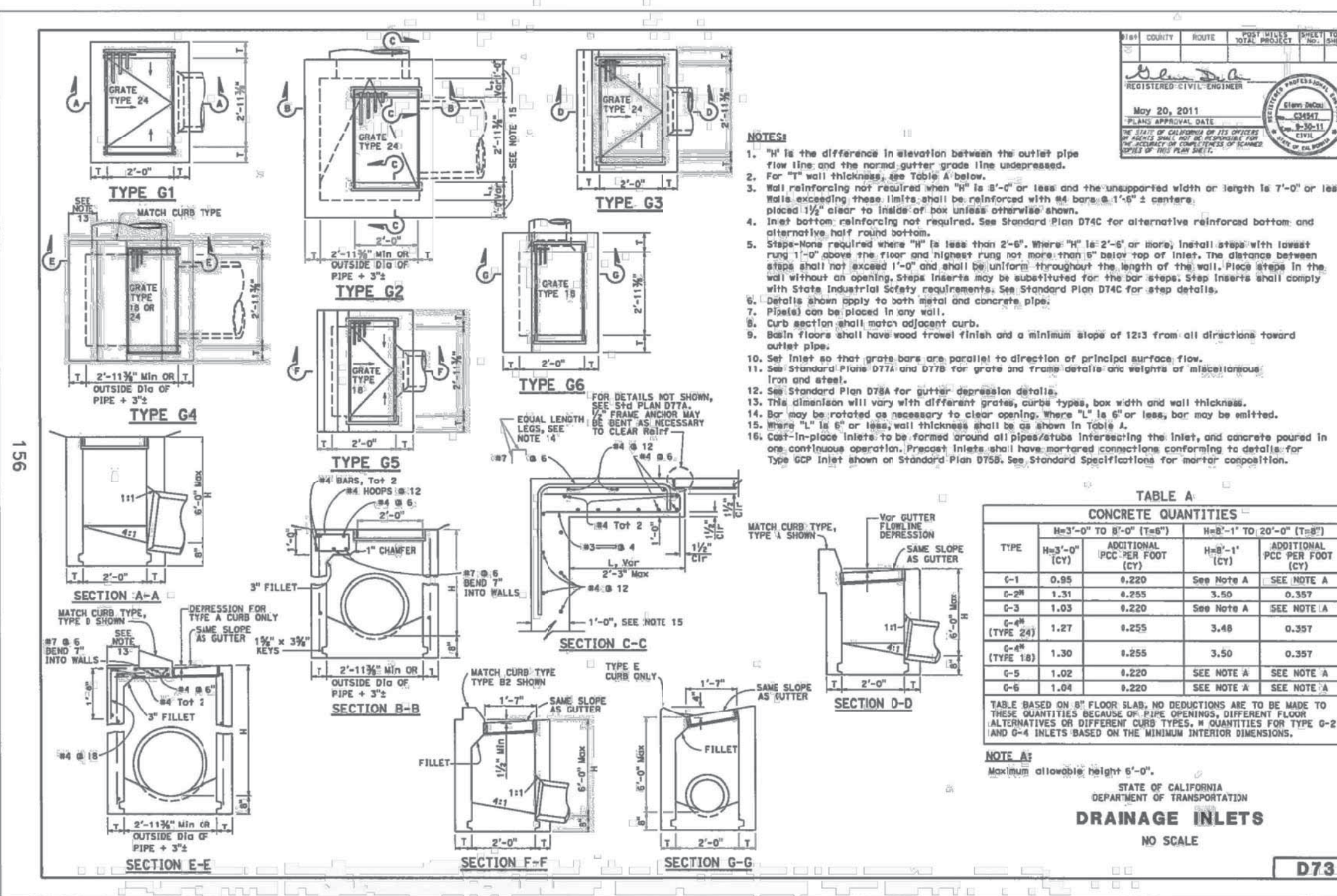
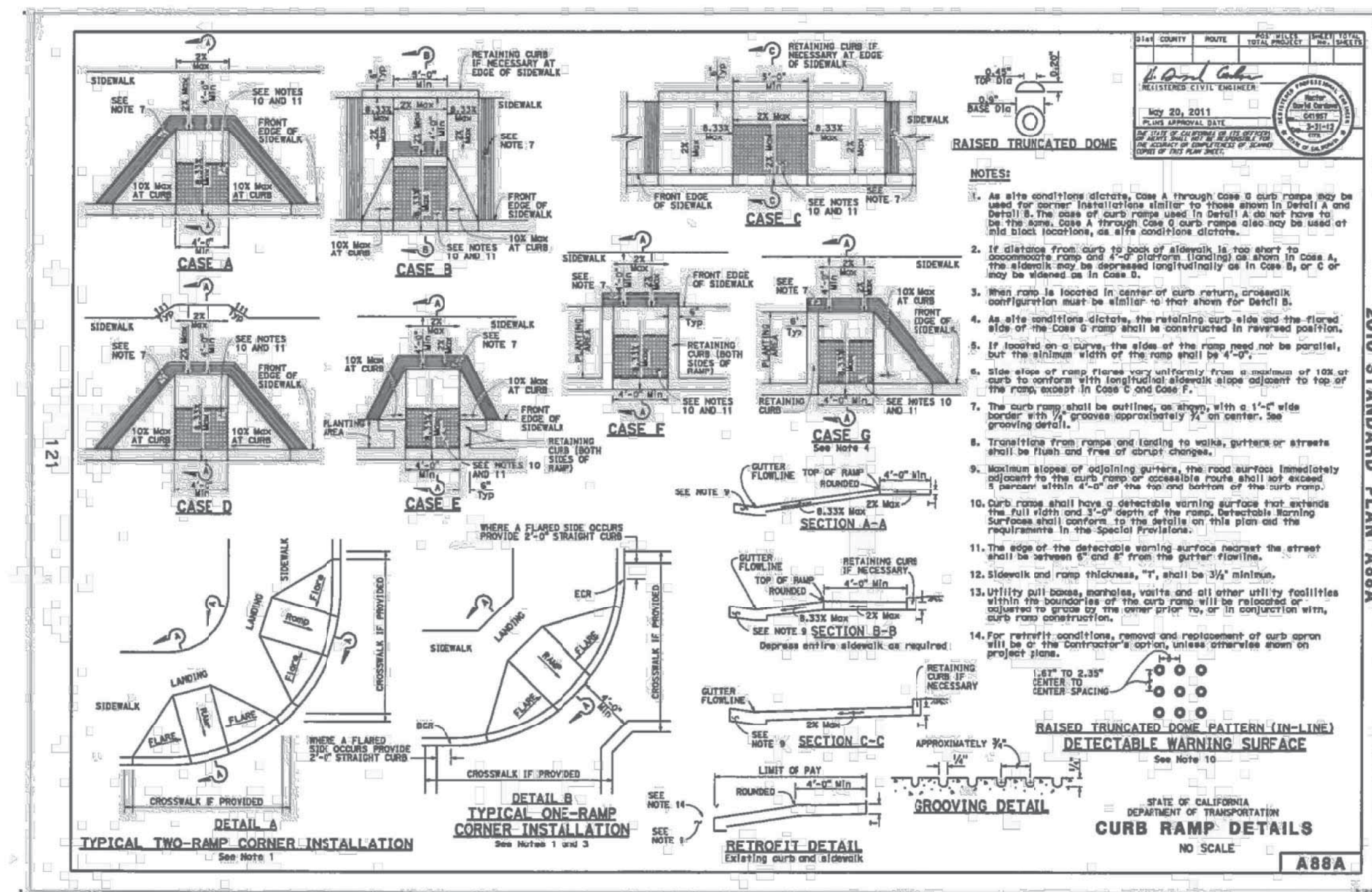

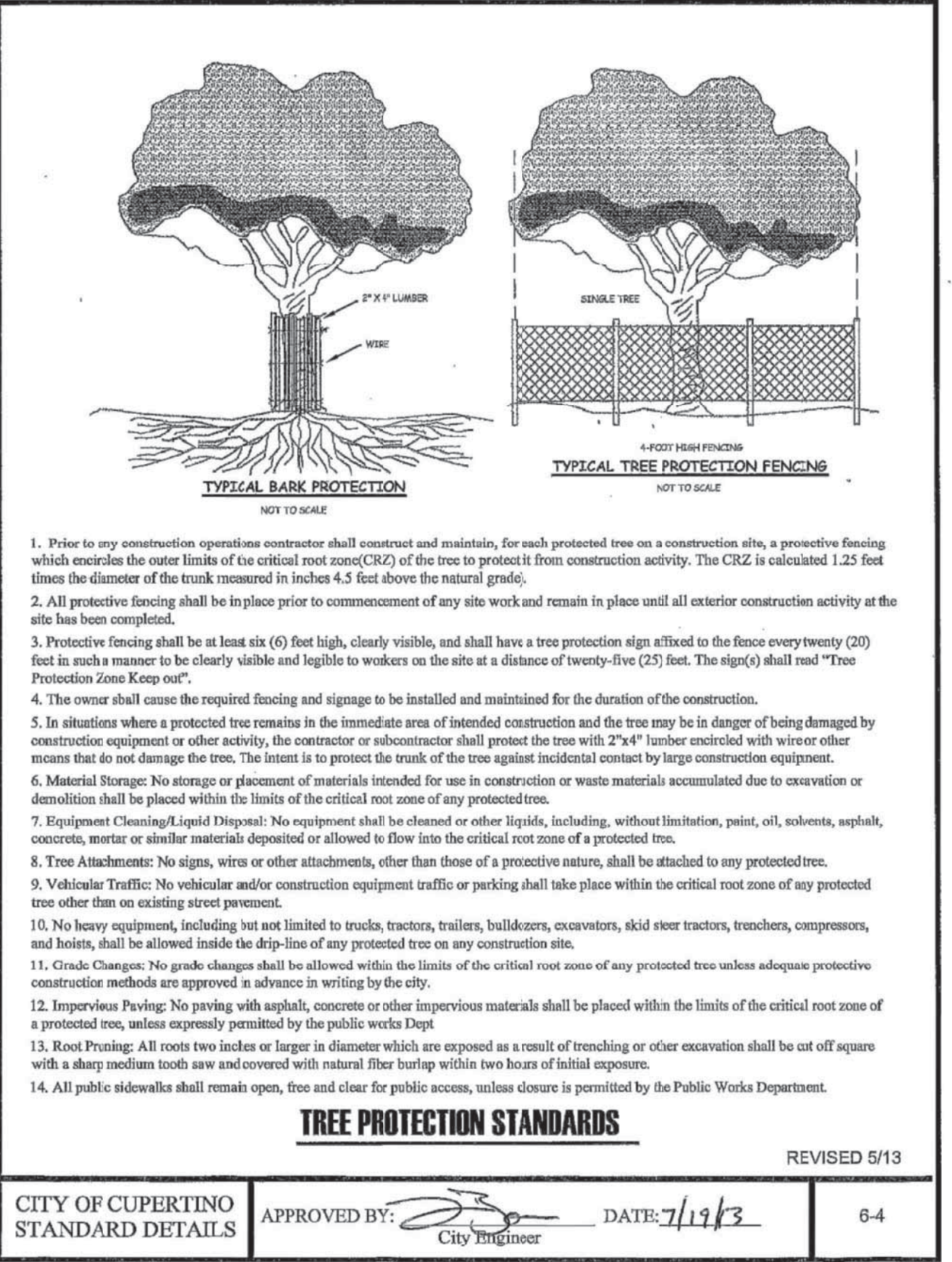
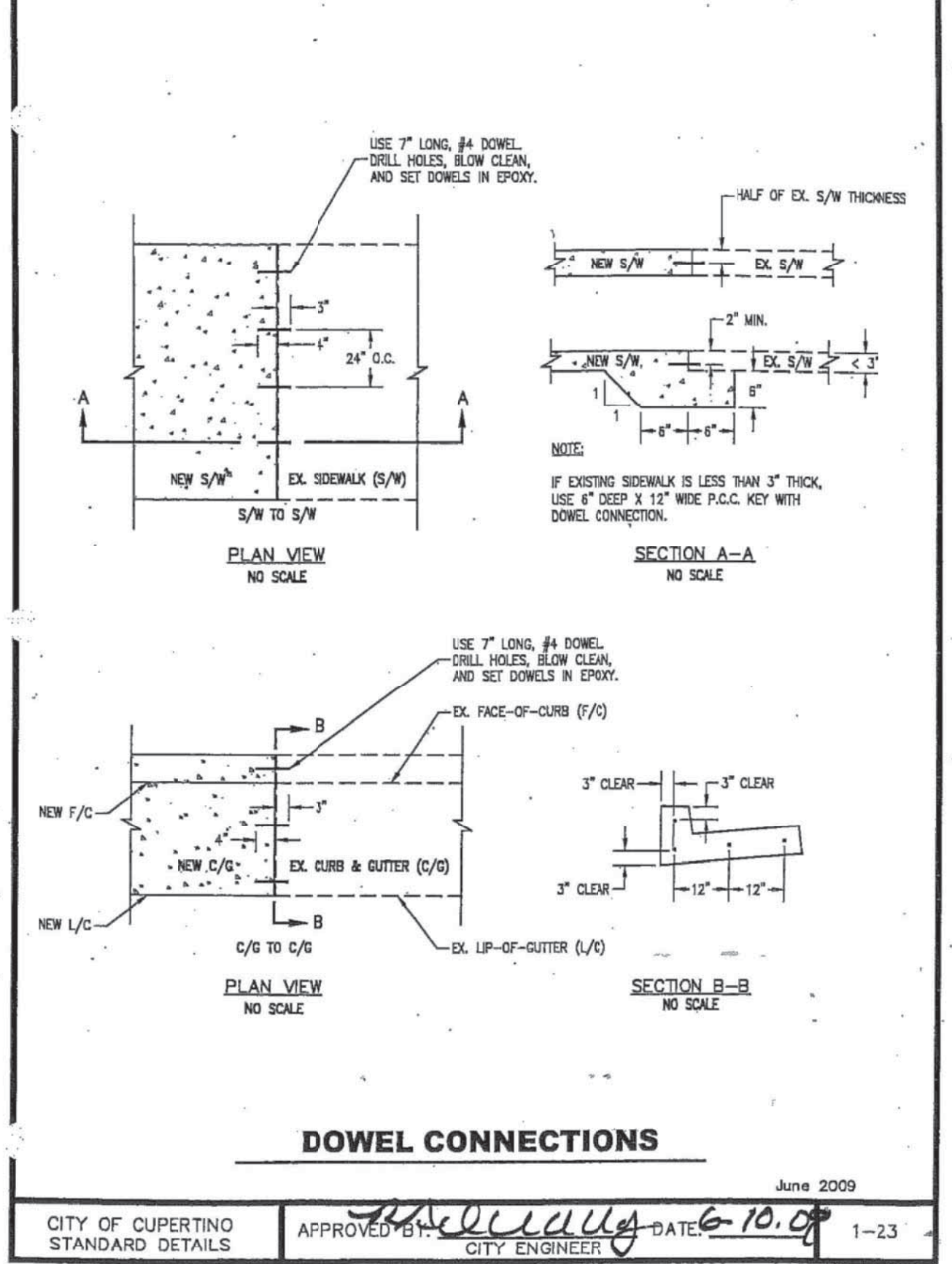
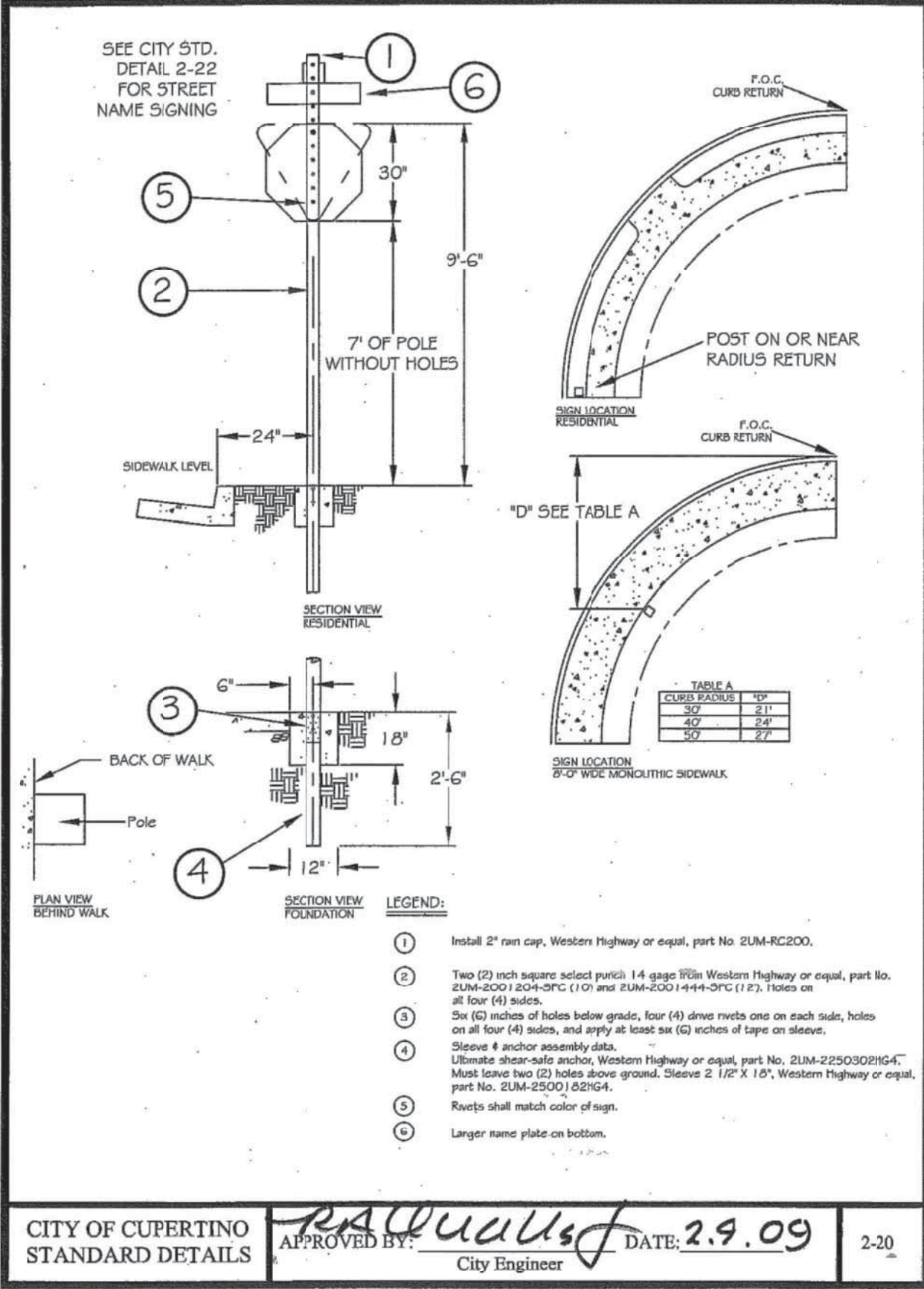
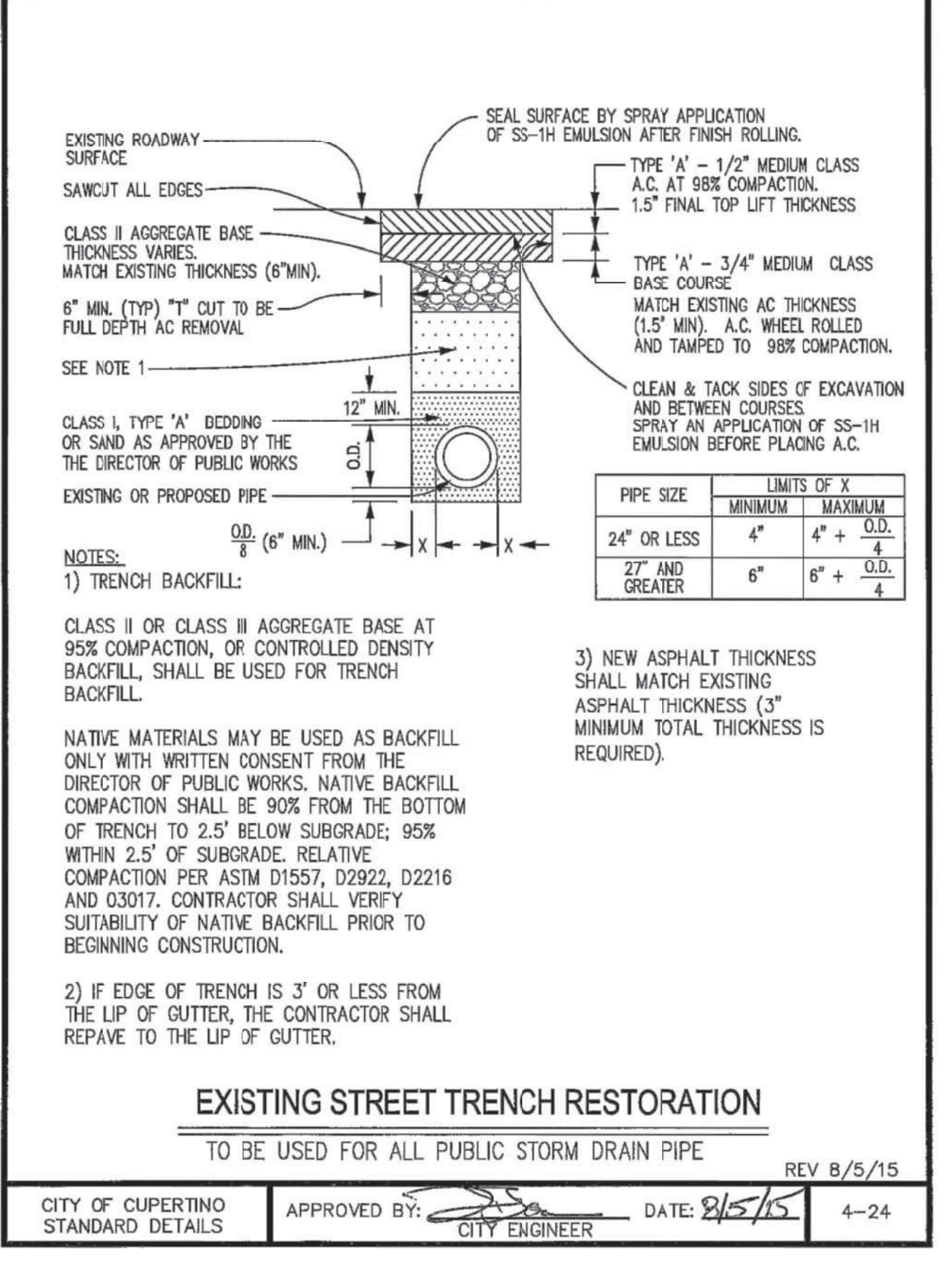
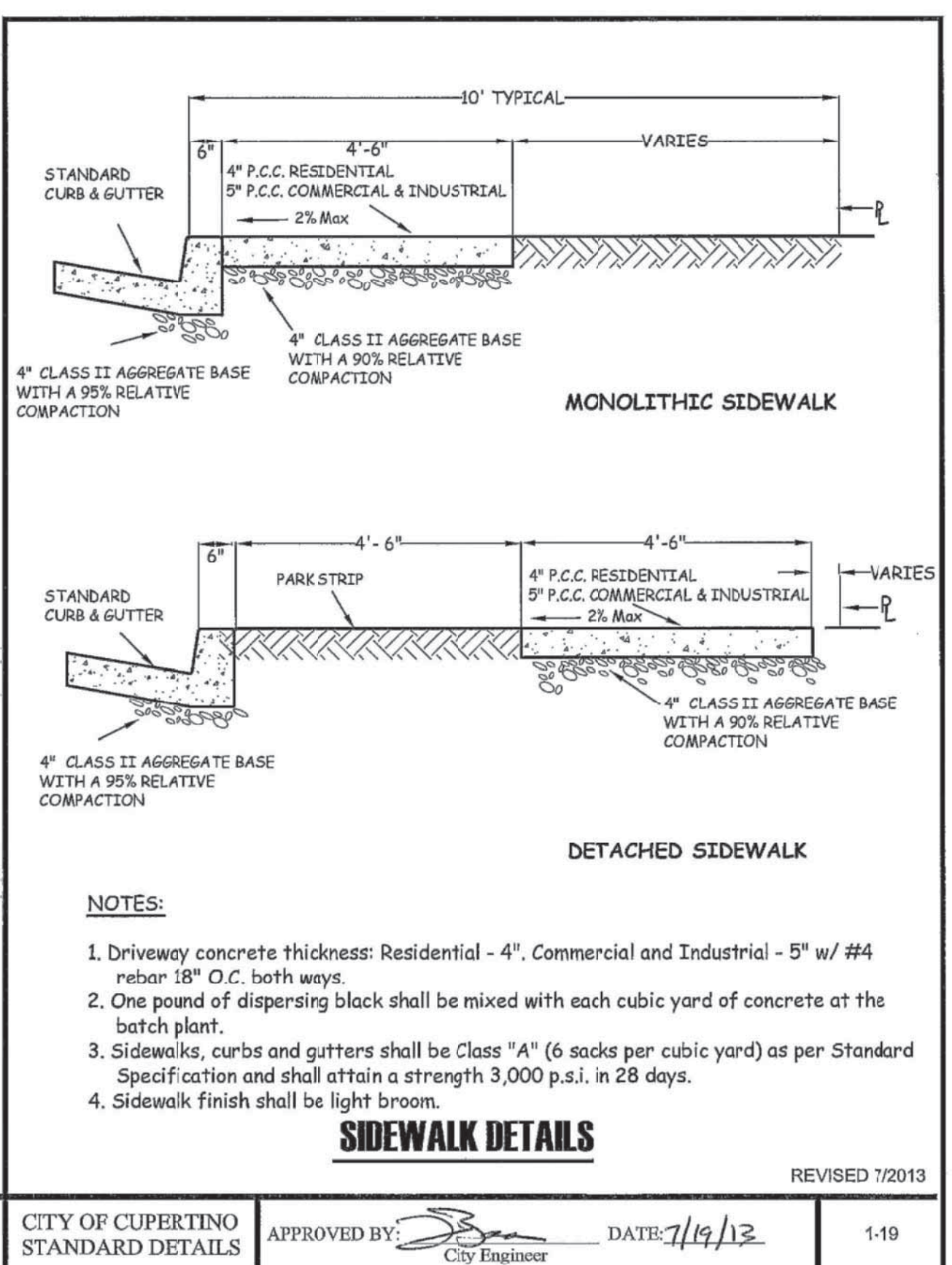
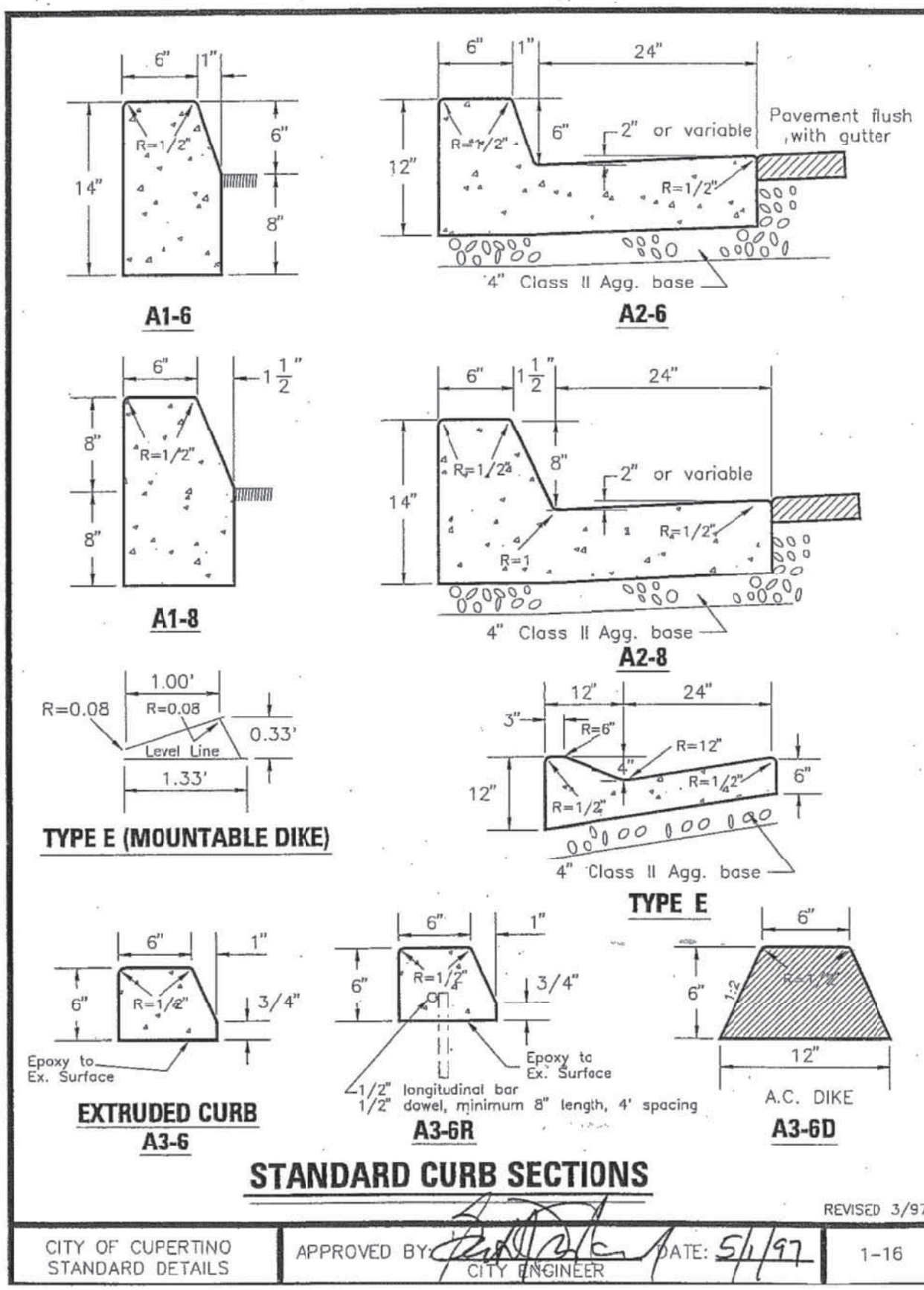

HMH

Land Use Entitlements
Land Planning
Landscape Architecture
Civil Engineering
Utility Design
Land Surveying
Stormwater Compliance

1570 Oakland Road (408) 487-2200
San Jose, CA 95131 HMHca.com



CITY OF CUPERTINO
MCCLELLAN ROAD
SIDEWALK CONSTRUCTION
CUPERTINO, CALIFORNIA

NO	DATE	DESCRIPTION
PROJECT NO:		4844.00
CAD DWG FILE:		484400D01.DWG
DESIGNED BY:		LA
DRAWN BY:		LA
CHECKED BY:		JC
DATE:		06/15/2016

HMH

DETAILS

DT02

3 OF 7

S:\PROJECTS\484400D01\DWG\DRAWINGS\484400D01.DWG

PLOTED: 6/15/2016 4:31 PM



CUPERTINO

CITY OF CUPERTINO MCCLELLAN ROAD SIDEWALK CONSTRUCTION CUPERTINO, CALIFORNIA

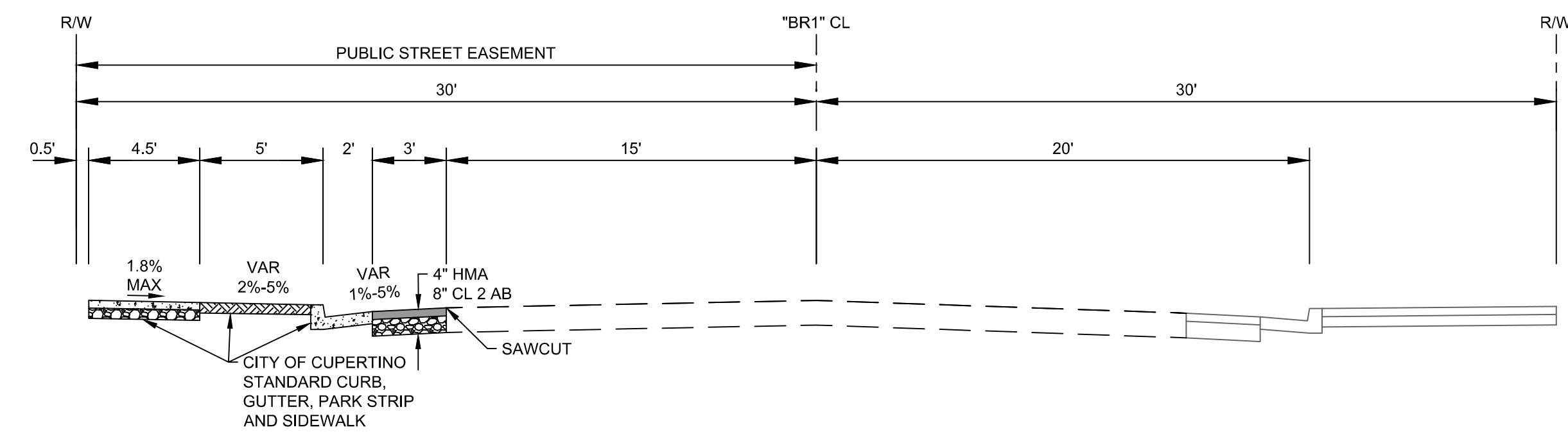
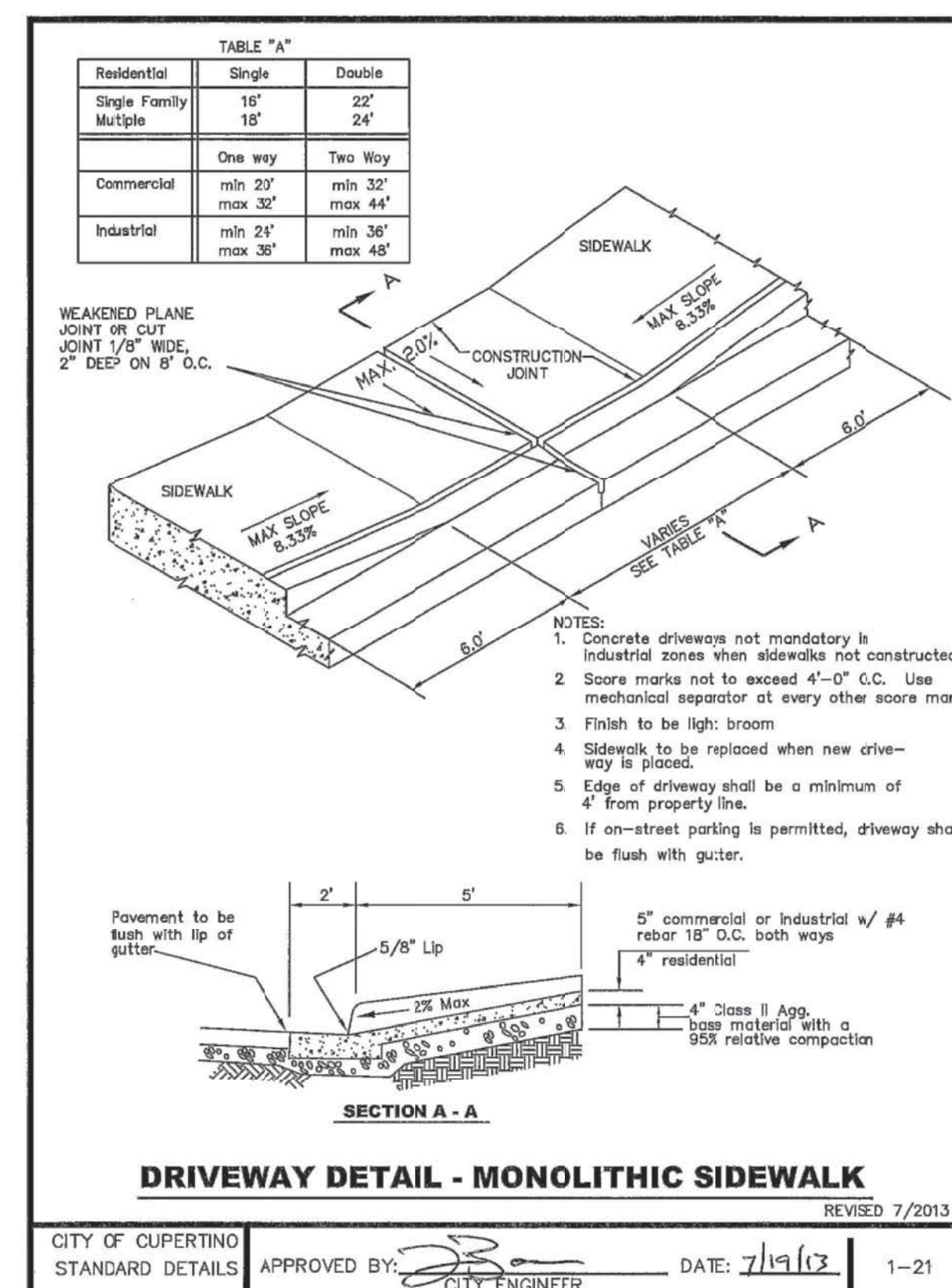
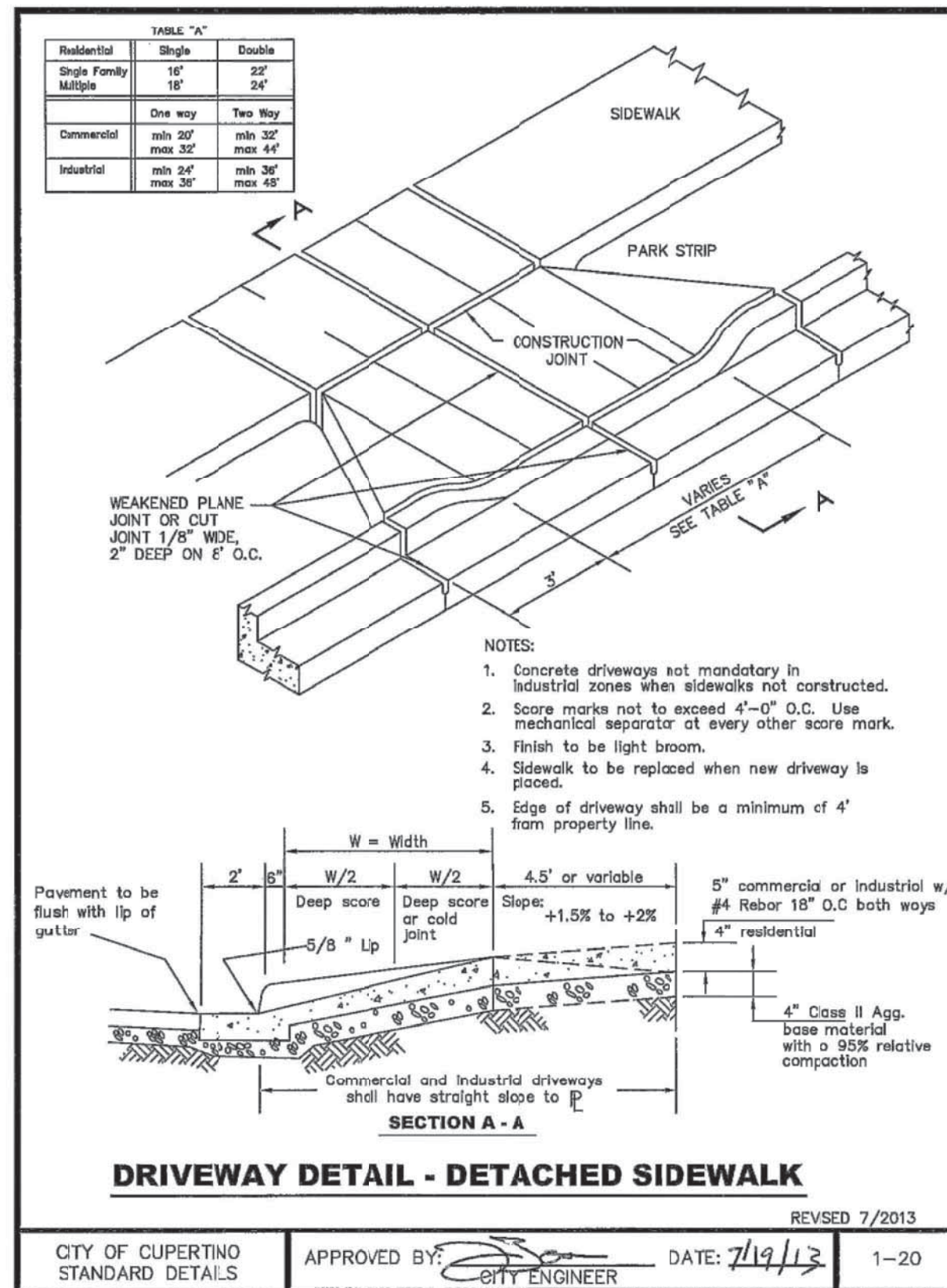

TYPICAL SECTION - BYRNE AVE
NTS

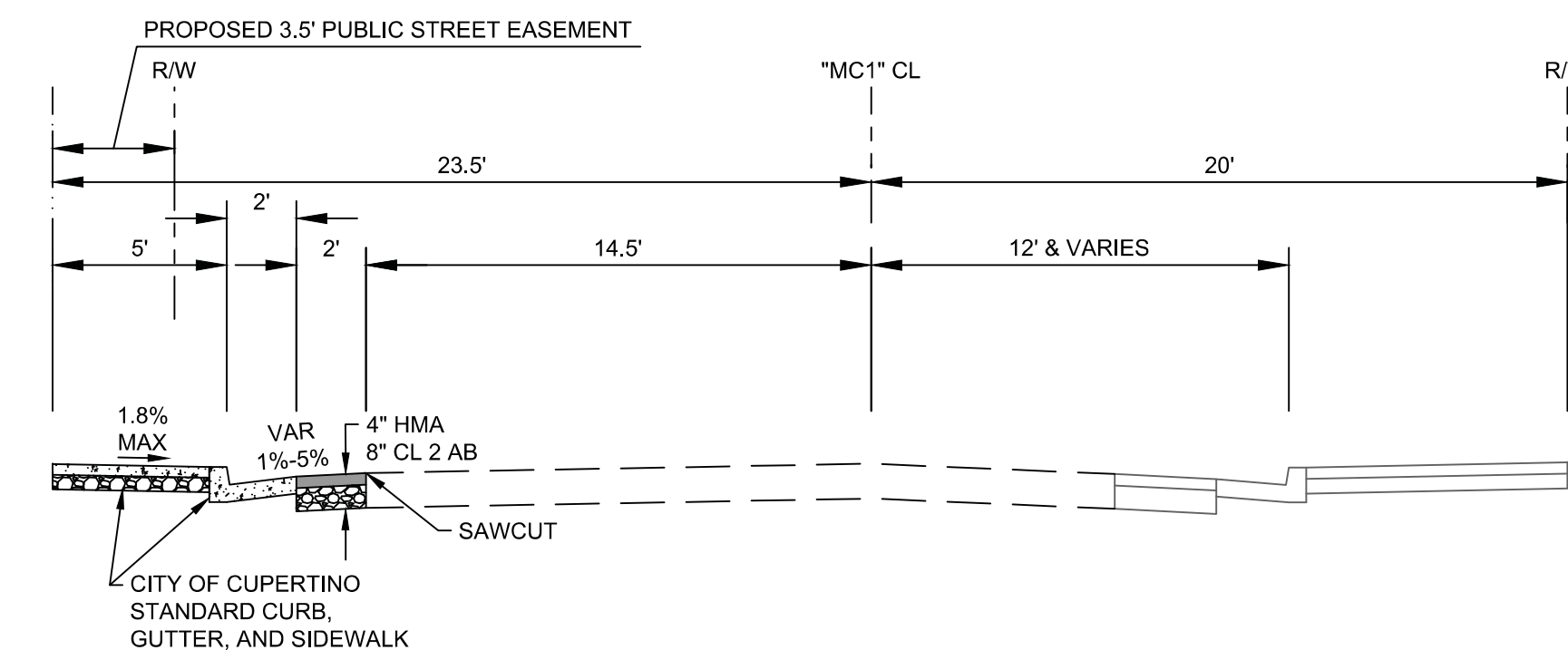

TYPICAL SECTION - MCCLELLAN RD
NTS

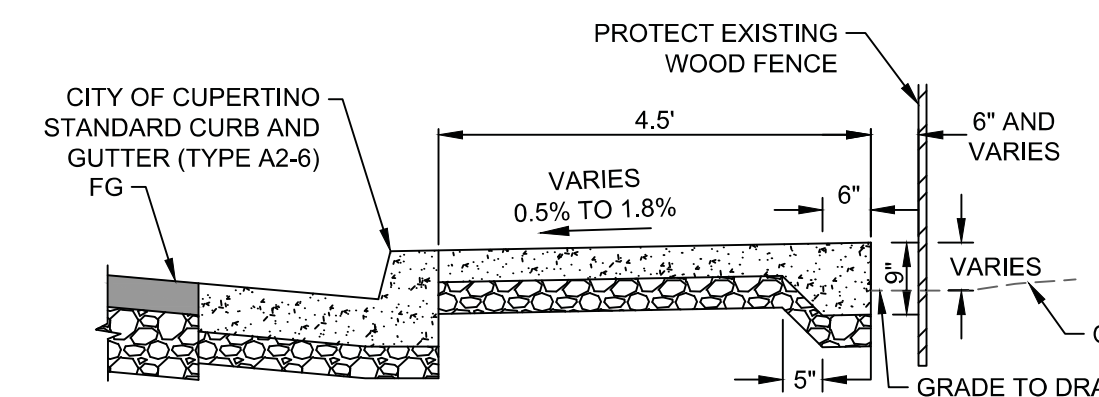
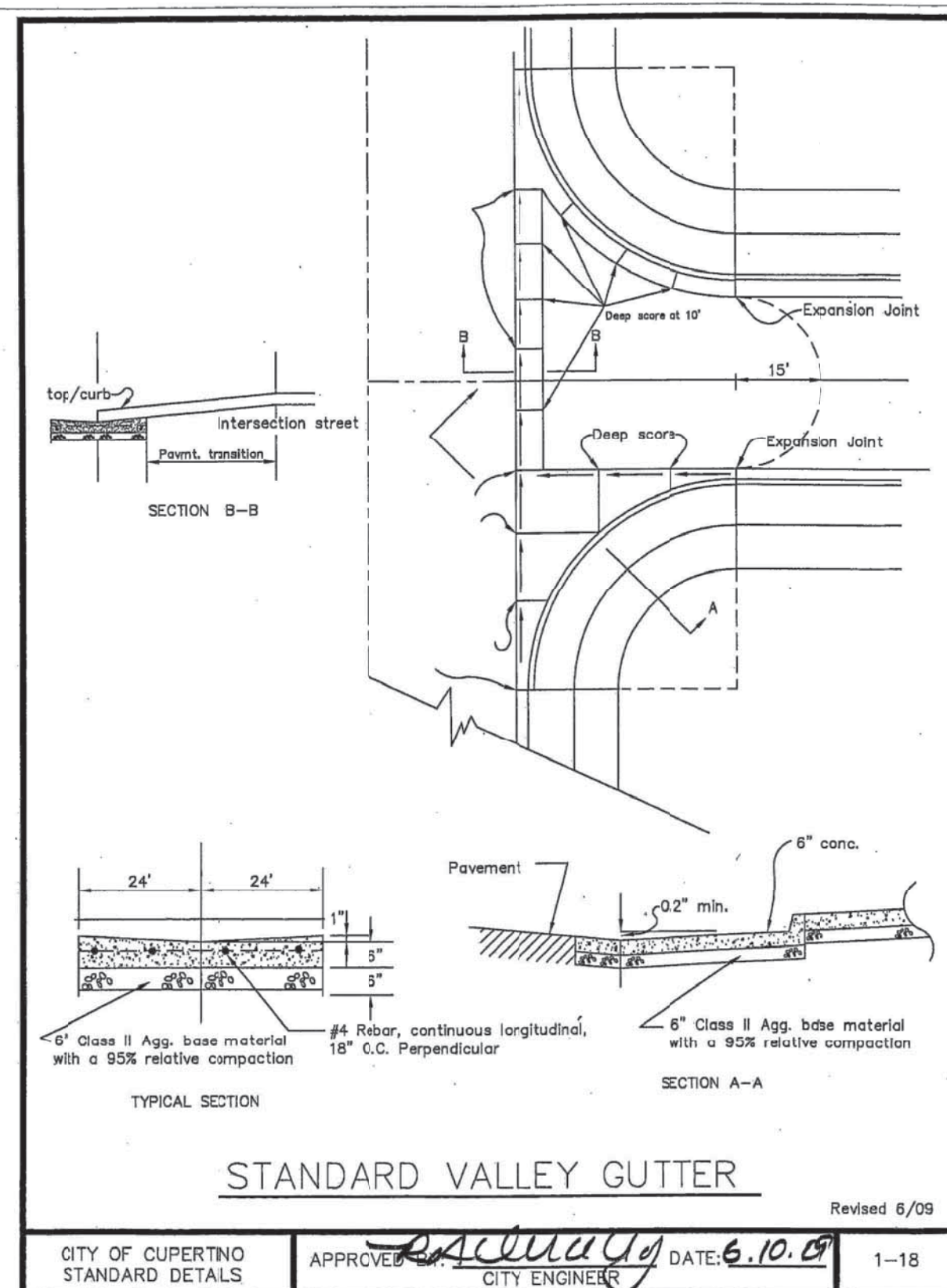

THICKENED SIDEWALK DETAIL
NTS

S:\PROJECTS\44400\FW\LOT DRAWINGS\84400T01.DWG

PLotted: 6/15/2016 5:44 PM

DETAILS

DT03

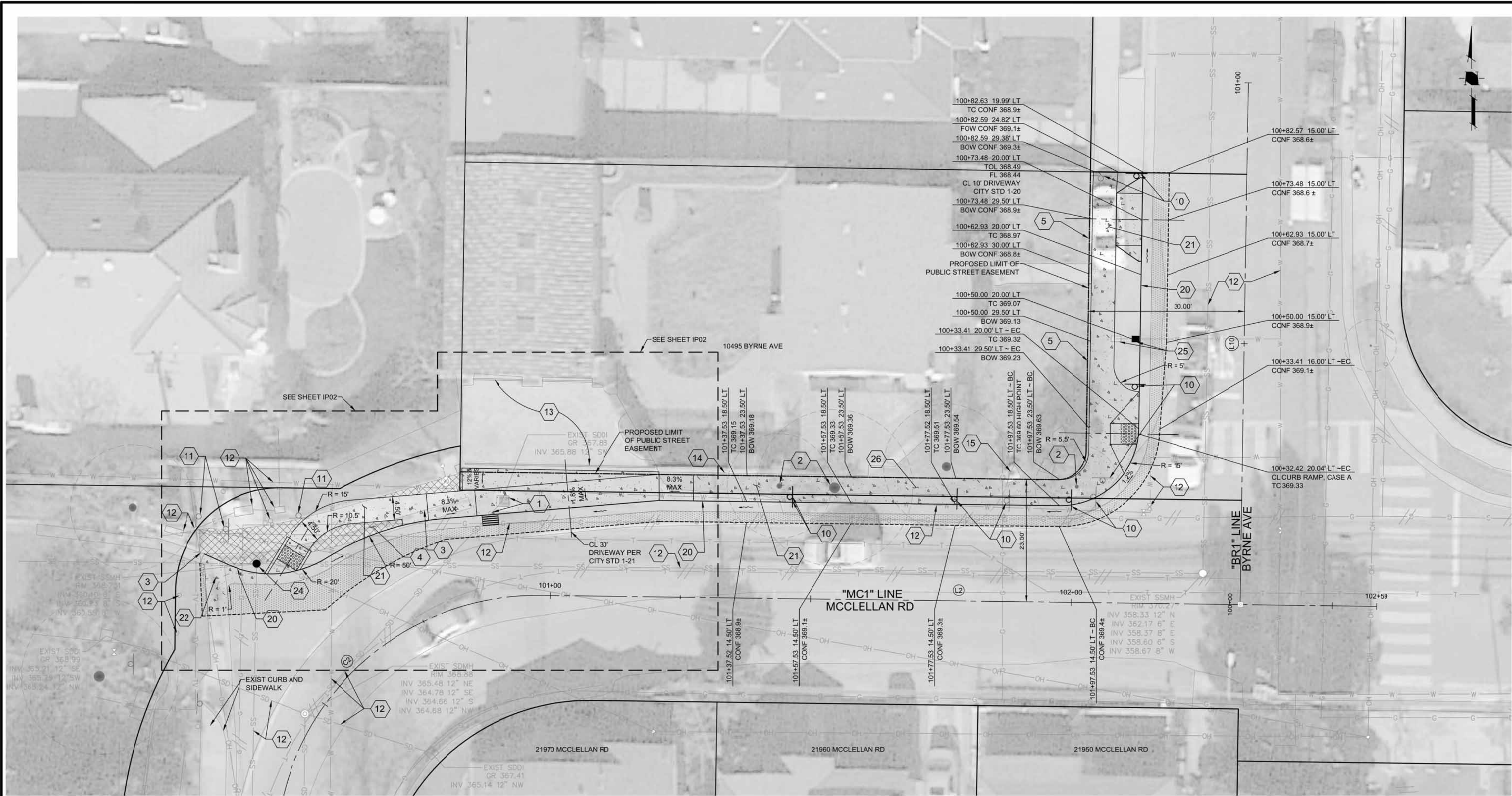

PLAN
SCALE: 1" = 10'

"MC1" ALIGNMENT DATA TABLE						
SEGMENT	LENGTH	BEARING/DELTA	RADIUS	TANGENT	START	END
L1	19.63'	N00°44'25"E			STA: 100+00.00 N: 1941070.97 E: 6108291.92	STA: 100+19.63 N: 1941090.60 E: 6108292.17
C2	78.55'	90°00'43"	50.00'	50.01'	STA: 100+19.63 N: 1941090.60 E: 6108292.17	STA: 100+98.18 N: 1941139.95 E: 6108342.82
L2	160.40'	S89°14'52"E			STA: 100+98.18 N: 1941139.95 E: 6108342.82	STA: 102+58.57 N: 1941137.84 E: 6108503.21

"BR1" ALIGNMENT DATA TABLE						
SEGMENT	LENGTH	BEARING/DELTA	RADIUS	TANGENT	START	END
L10	100.00'	N00°53'48"E			STA: 100+00.00 N: 1941138.19 E: 6108477.08	STA: 101+00.00 N: 1941238.17 E: 6108478.65

SHEET KEYNOTES

- REMOVE EXIST STORM DRAIN INLET AND PIPE
- REMOVE EXIST TREE
- REMOVE EXIST CURB AND GUTTER
- REMOVE EXIST SIDEWALK
- REMOVE WOODEN HEADER BOARD
- RELOCATE ROADSIDE SIGN
- PROTECT EXIST SIGN IN PLACE
- PROTECT EXIST UTILITY IN PLACE
- PROTECT EXIST PAVERS
- PROTECT EXIST FENCE
- RELOCATE BOULDER (ON SITE)
- CONSTRUCT A2-6 CURB AND GUTTER PER CITY OF CUPERTINO STANDARD DETAIL 1-16
- CONSTRUCT SIDEWALK PER CITY OF CUPERTINO STANDARD DETAIL 1-19
- CONSTRUCT CONCRETE VALLEY GUTTER PER CITY OF CUPERTINO STANDARD DETAIL 1-18
- NOT USED
- ADJUST MANHOLE TO GRADE
- WATER METER RELOCATED BY OTHERS ADJUST BOX TO GRADE
- CONSTRUCT THICKENED SIDEWALK DETAIL PER SHEET DT03. FOR DETAILS NOT SHOWN SEE CUPERTINO STD 1-19. DETAIL EXTENDS ALONG MCCLELLAN RD FROM 101+27.18 TO 101+97.53.

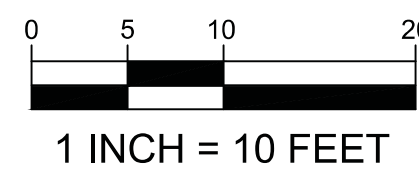

**CITY OF CUPERTINO
MCCLELLAN ROAD
SIDEWALK CONSTRUCTION
CUPERTINO, CALIFORNIA**

NO	DATE	DESCRIPTION
PROJECT NO:		4844.00
CAD DWG FILE:		484400IP01.DWG
DESIGNED BY:		LA
DRAWN BY:		LA
CHECKED BY:		JC
DATE:		08/15/2016

HMH

IMPROVEMENT PLAN

IP01

S:\PROJECTS\44400\DWG\LOT DRAWINGS\44400P01.DWG

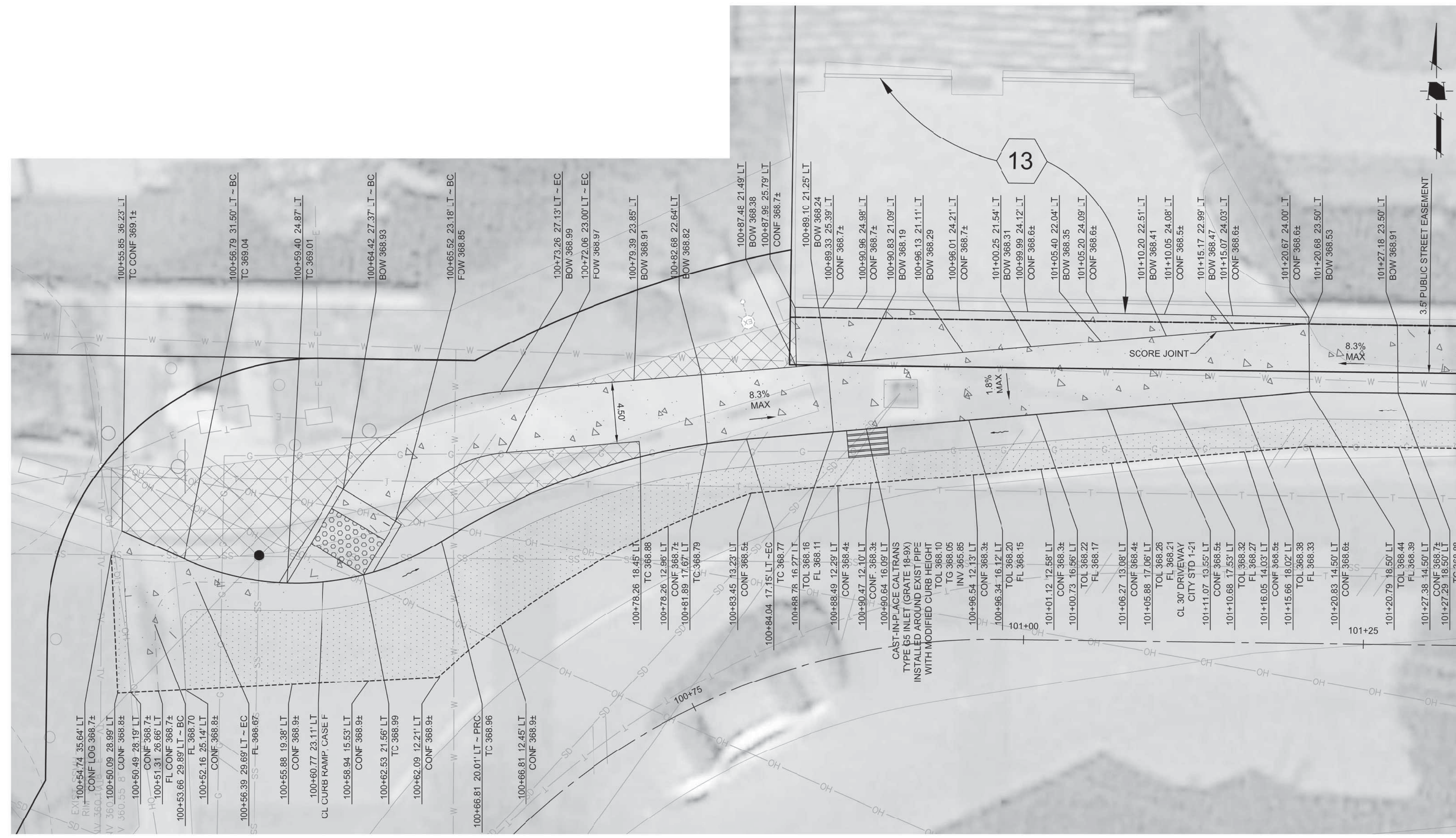

PLAN
SCALE: 1" = 5'

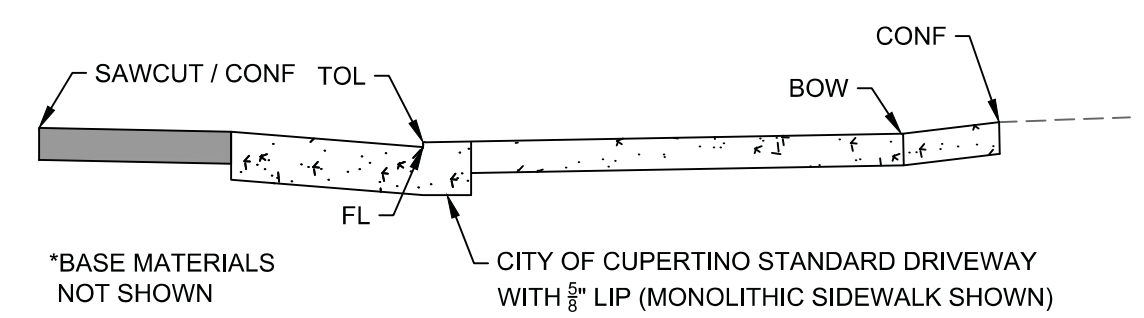

DRIVEWAY ANNOTATION LEGEND
NTS

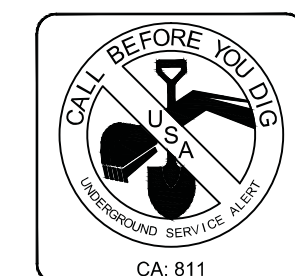
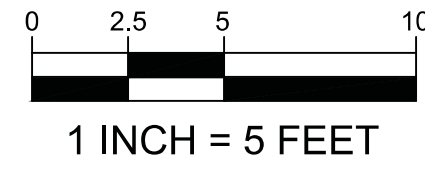

SHEET KEYNOTES

1. REMOVE EXIST STORM DRAIN INLET AND PIPE
2. REMOVE EXIST TREE
3. REMOVE EXIST CURB AND GUTTER
4. REMOVE EXIST SIDEWALK
5. REMOVE WOODEN HEADER BOARD
10. RELOCATE ROADSIDE SIGN
11. PROTECT EXIST SIGN IN PLACE
12. PROTECT EXIST UTILITY IN PLACE
13. PROTECT EXIST PAVERS
14. PROTECT EXIST FENCE
15. RELOCATE BOULDER (ON SITE)
20. CONSTRUCT A2-6 CURB AND GUTTER PER CITY OF CUPERTINO STANDARD DETAIL 1-16
21. CONSTRUCT SIDEWALK PER CITY OF CUPERTINO STANDARD DETAIL 1-19
22. CONSTRUCT CONCRETE VALLEY GUTTER PER CITY OF CUPERTINO STANDARD DETAIL 1-18
23. NOT USED
24. ADJUST MANHOLE TO GRADE
25. WATER METER RELOCATED BY OTHERS ADJUST BOX TO GRADE
26. CONSTRUCT THICKENED SIDEWALK DETAIL PER SHEET DT03. FOR DETAILS NOT SHOWN SEE CUPERTINO STD 1-19. DETAIL EXTENDS ALONG MCCLELLAN RD FROM 101+27.18 TO 101+97.53.



**CITY OF CUPERTINO
MCCLELLAN ROAD
SIDEWALK CONSTRUCTION**
CUPERTINO, CALIFORNIA

NO	DATE	DESCRIPTION

PROJECT NO:	4844.00
CAD DWG FILE:	484400P01.DWG
DESIGNED BY:	LA
DRAWN BY:	LA
CHECKED BY:	JC
DATE:	08/15/2016

HMH

IMPROVEMENT PLAN

IP02

PLotted: 8/22/2016 9:30 AM

