

Existing Conditions

- Trail Connection Point / Enlargement Area
- Gateway
- City Limits

Existing Connections

- Class 1 Bike Path
- Bike Lanes on Street
- Bike Route
- Crosswalk
- Stop Sign
- Traffic Signal

Trail Types

Alternative #1

- Pedestrian Trail, less than 16'-0"

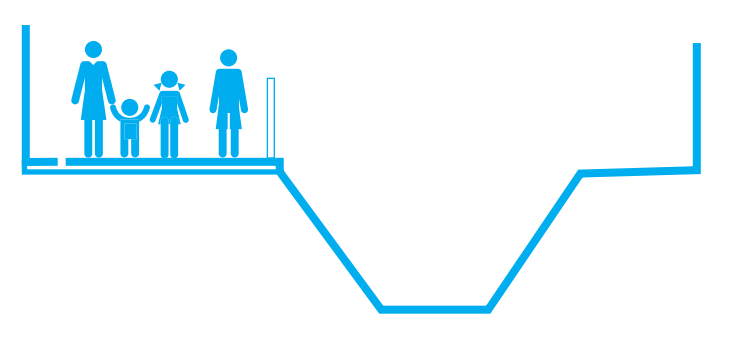

Alternative #2

- Covered Ditch, Class 1 Multi-Use Trail, 16'-0" minimum

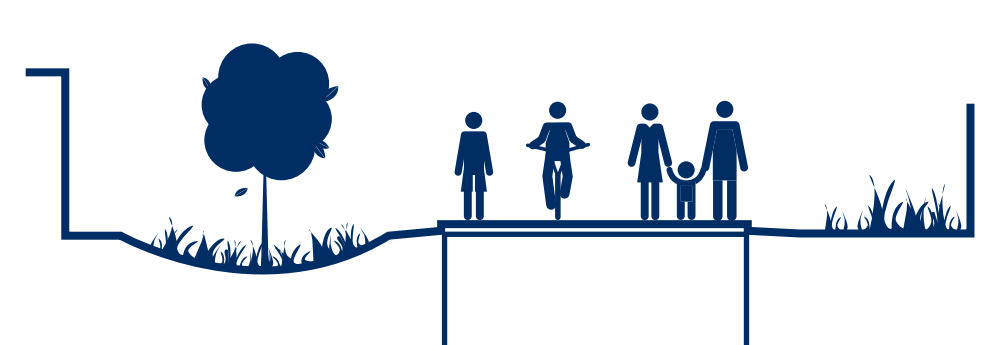

Standard

- Class 1 Multi-Use Trail, 16'-0" minimum

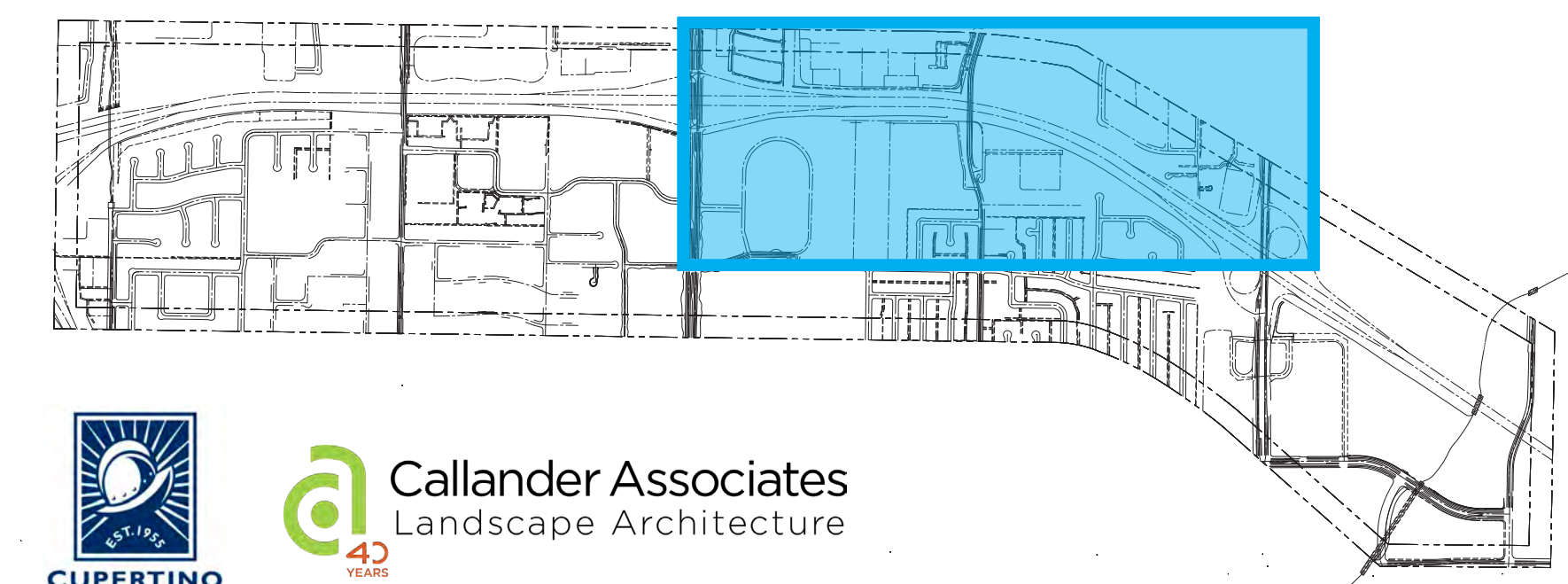

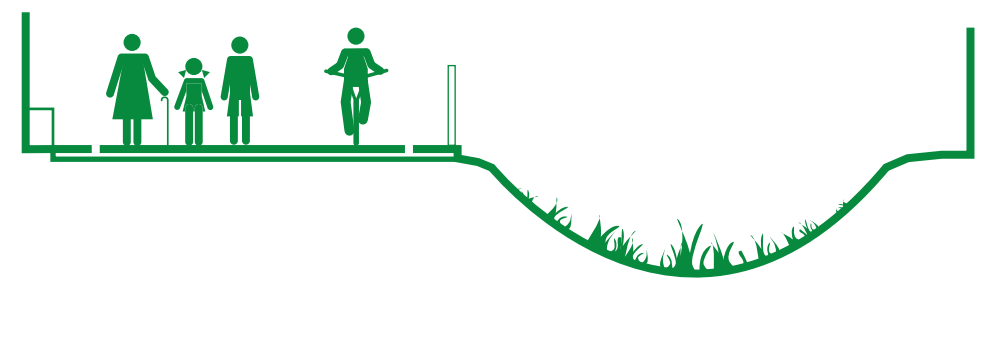

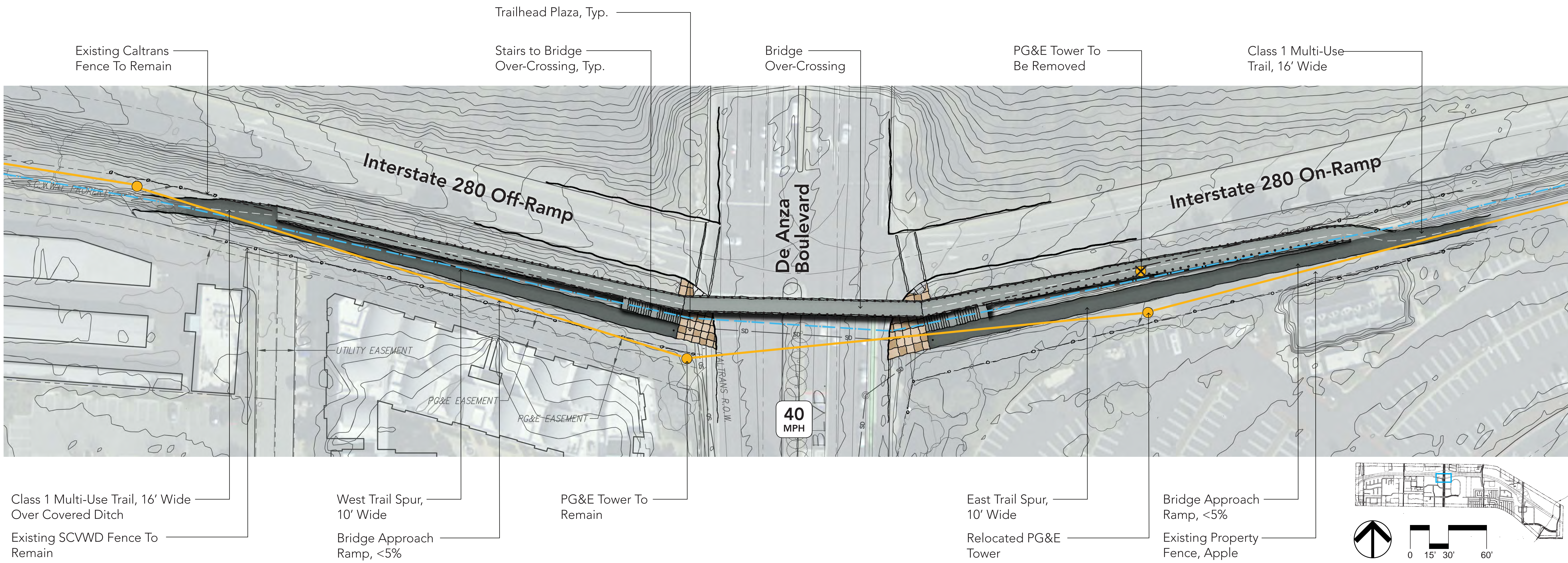

De Anza Boulevard Intersection Enlargement Bridge Over-Crossing

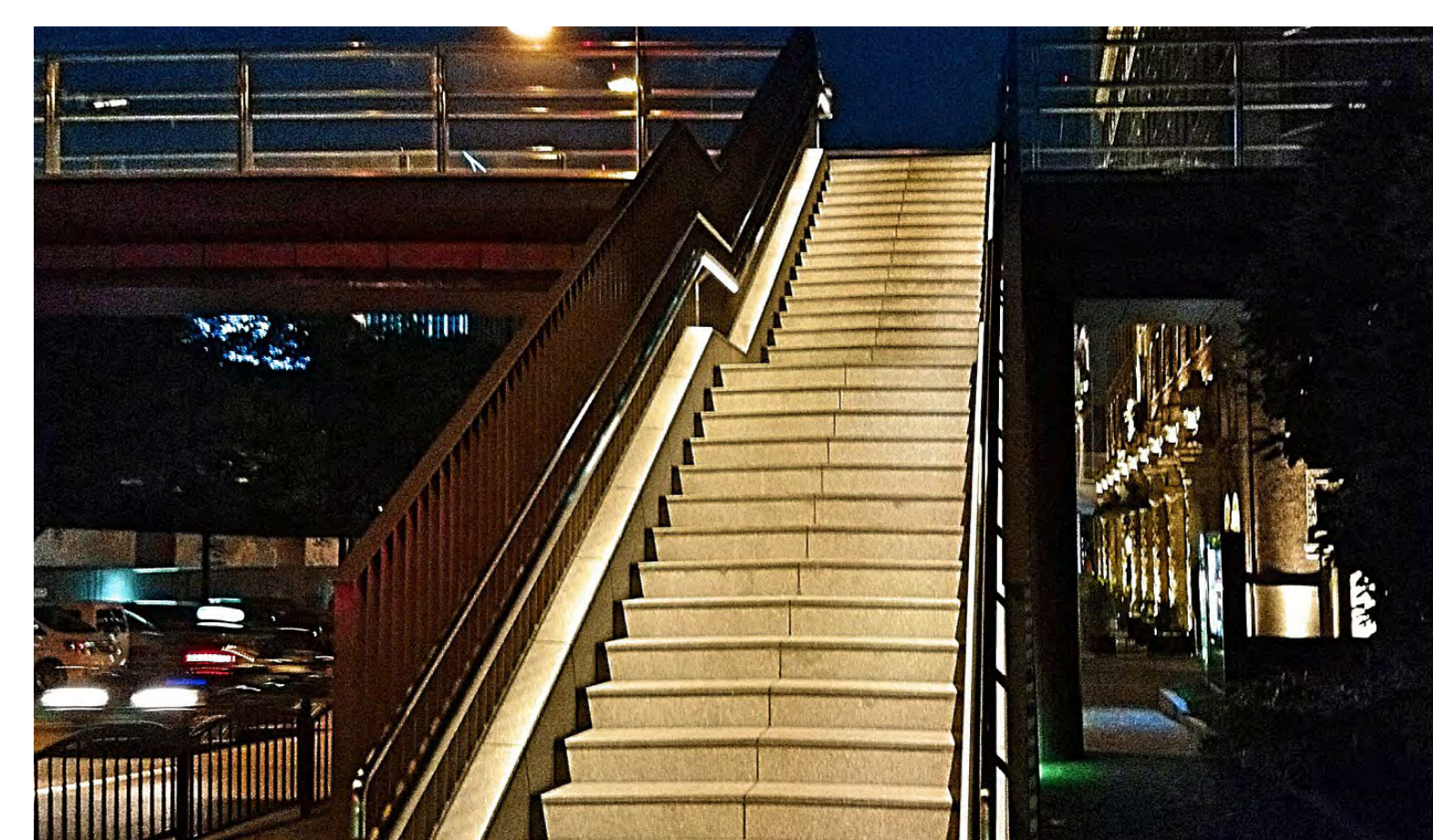
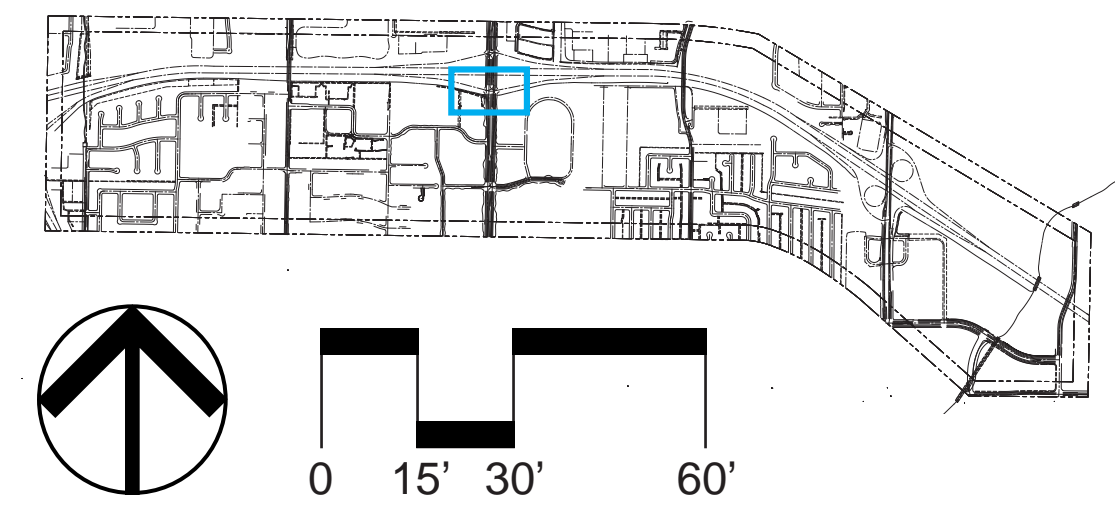

Bicycle / Pedestrian Bridge Over-Crossing Examples

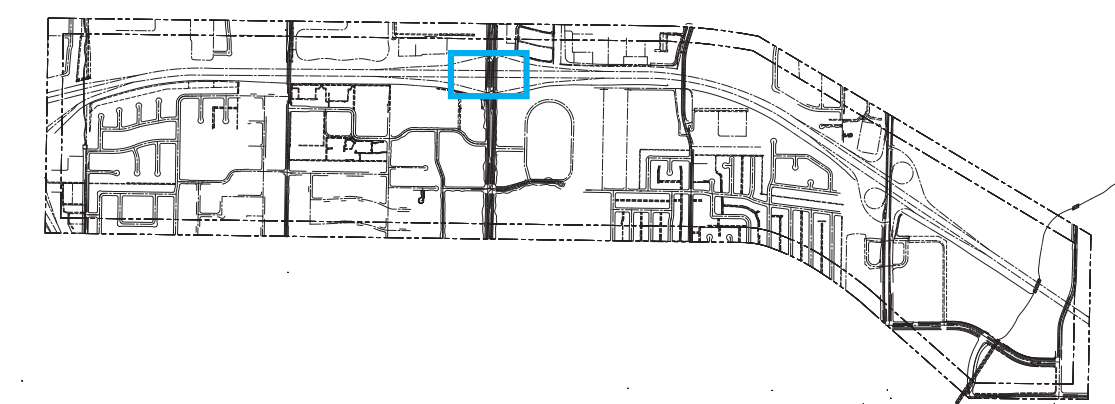

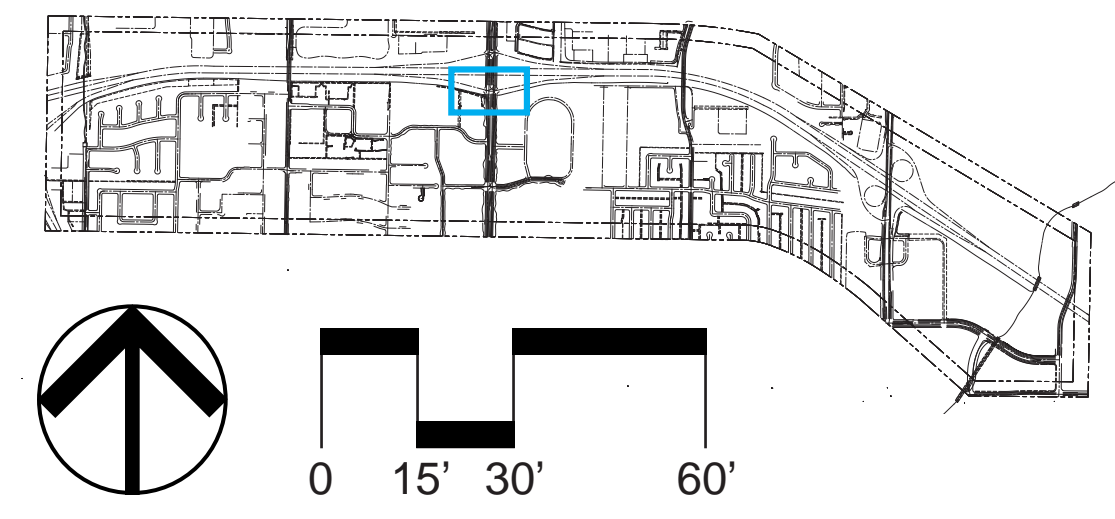
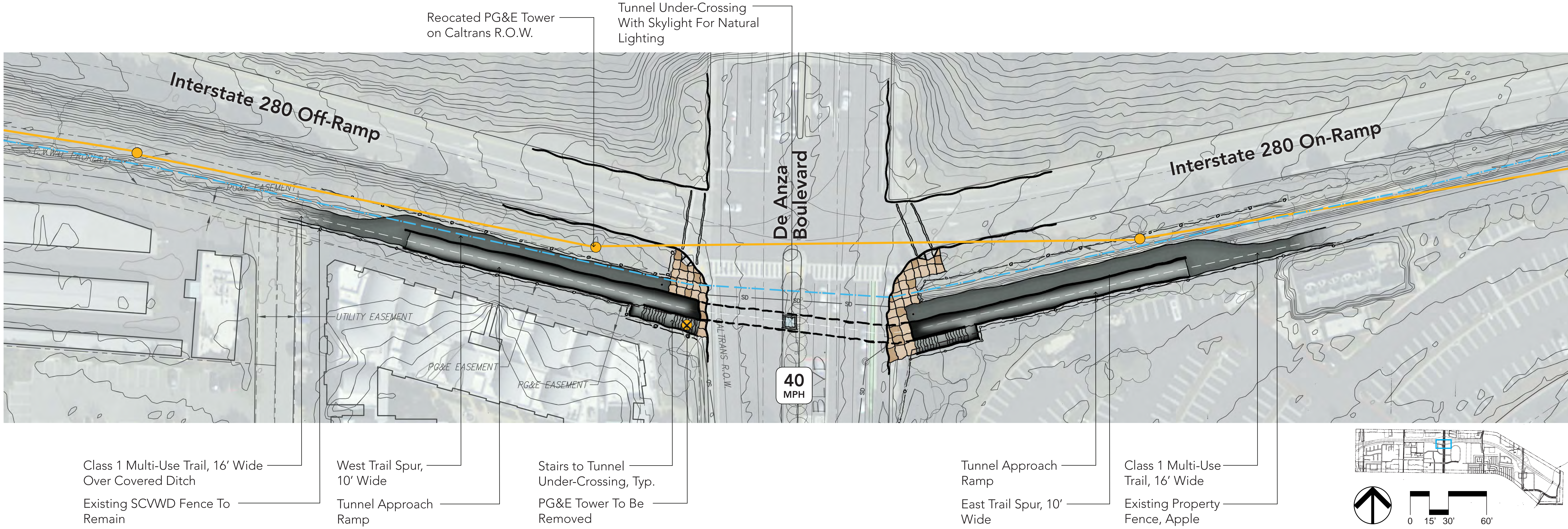

De Anza Boulevard Intersection Enlargement Tunnel Under-Crossing

- Enlargement Legend**
- Drainage Ditch (When Covered)
 - Primary Voltage Overhead
 - Secondary Voltage Overhead

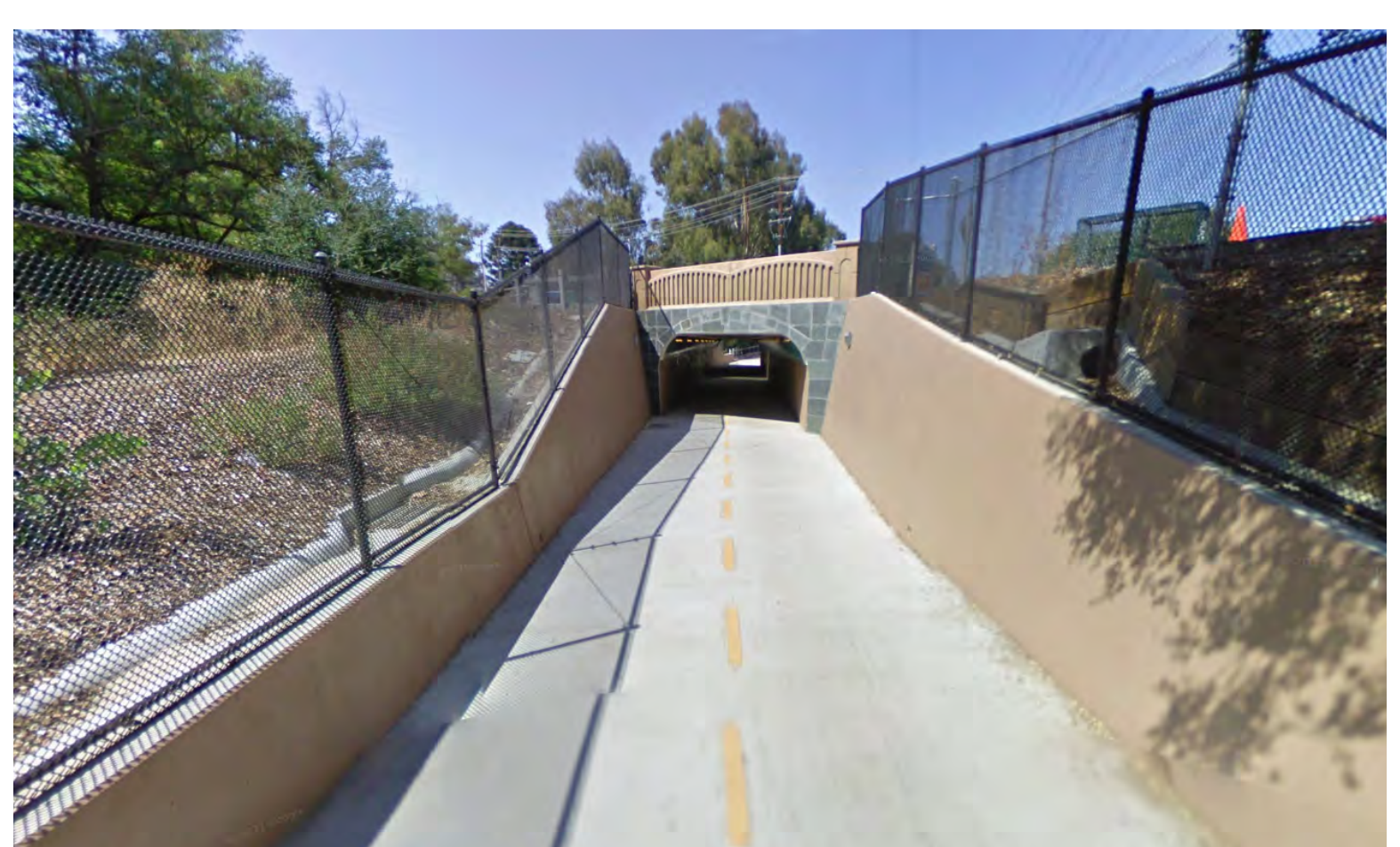
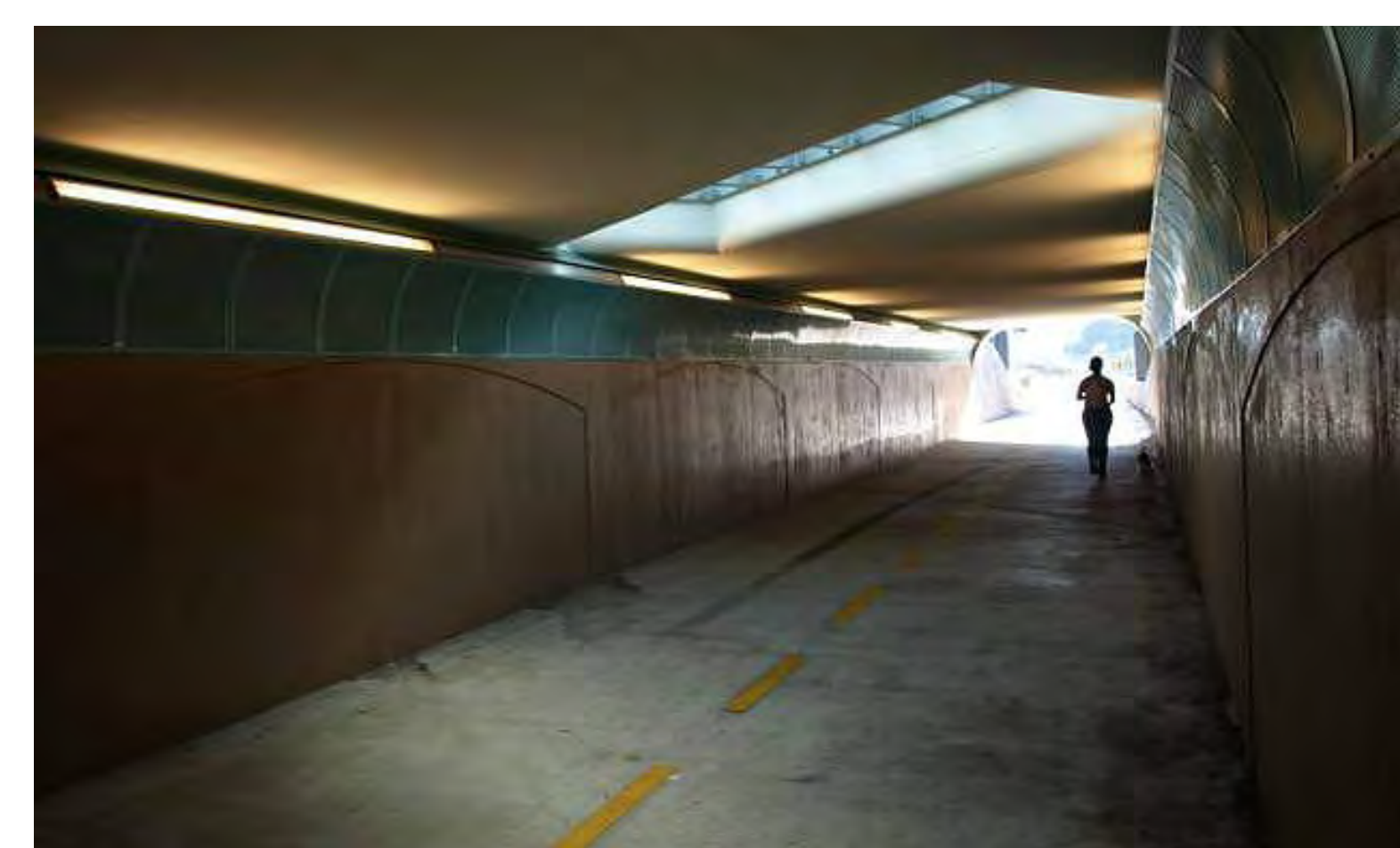

Bicycle / Pedestrian Under-Crossing Examples

Local Example: Stevens Creek Trail, Mountain View Under-Crossing Below El Camino Real With Center Skylight And Lighting

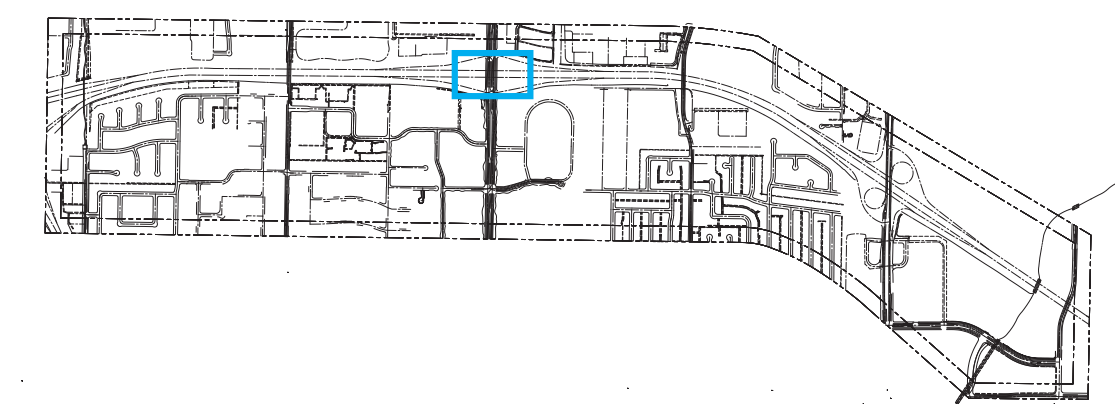

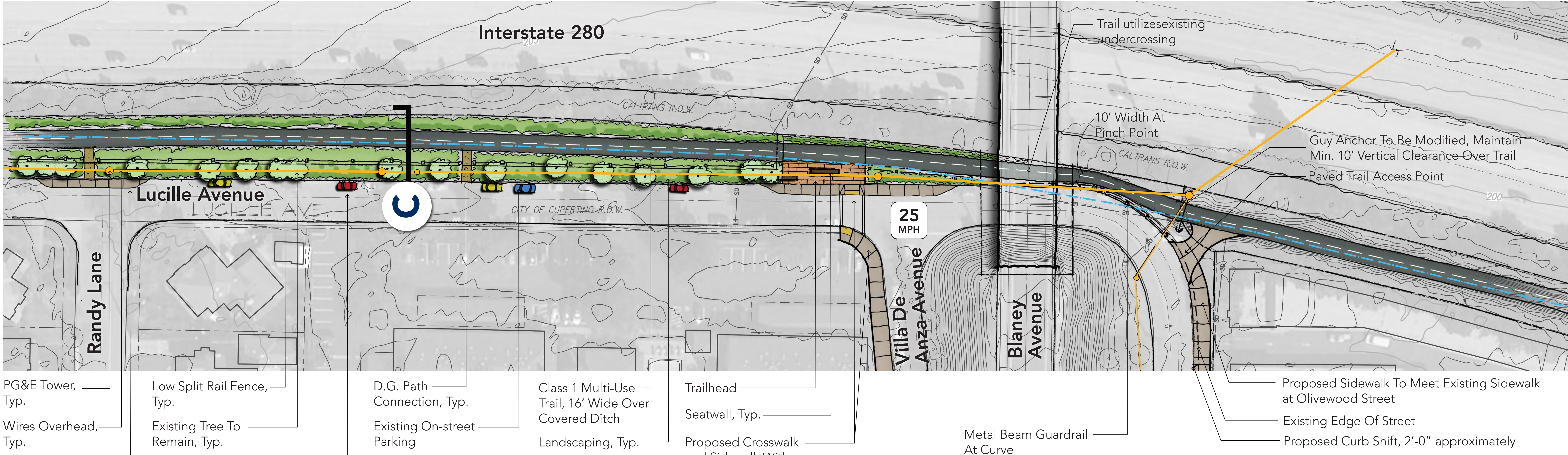

- PG&E Tower, Typ.
- Wires Overhead, Typ.
- Curb Bulbout, Typ.
- Low Split Rail Fence, Typ.
- Existing Tree To Remain, Typ.
- Trail Parking, explore extension of permit parking on Lucille
- D.G. Path Connection, Typ.
- Existing On-street Parking
- Class 1 Multi-Use Trail, 16' Wide Over Covered Ditch
- Landscaping, Typ.
- Trailhead
- Seatwall, Typ.
- Proposed Crosswalk and Sidewalk With Ramps
- Trail utilizes existing undercrossing
- 10' Width At Pinch Point
- Guy Anchor To Be Modified, Maintain Min. 10' Vertical Clearance Over Trail
- Paved Trail Access Point
- Proposed Sidewalk To Meet Existing Sidewalk at Olivewood Street
- Existing Edge Of Street
- Proposed Curb Shift, 2'-0" approximately
- Metal Beam Guardrail At Curve

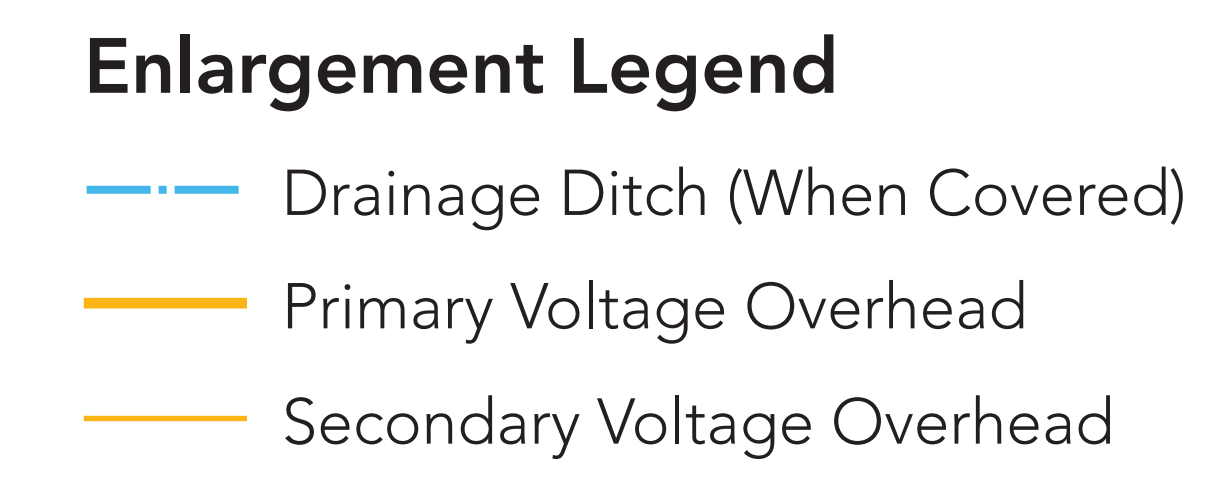

Blaney Avenue Intersection Enlargement

C SECTION C

Existing

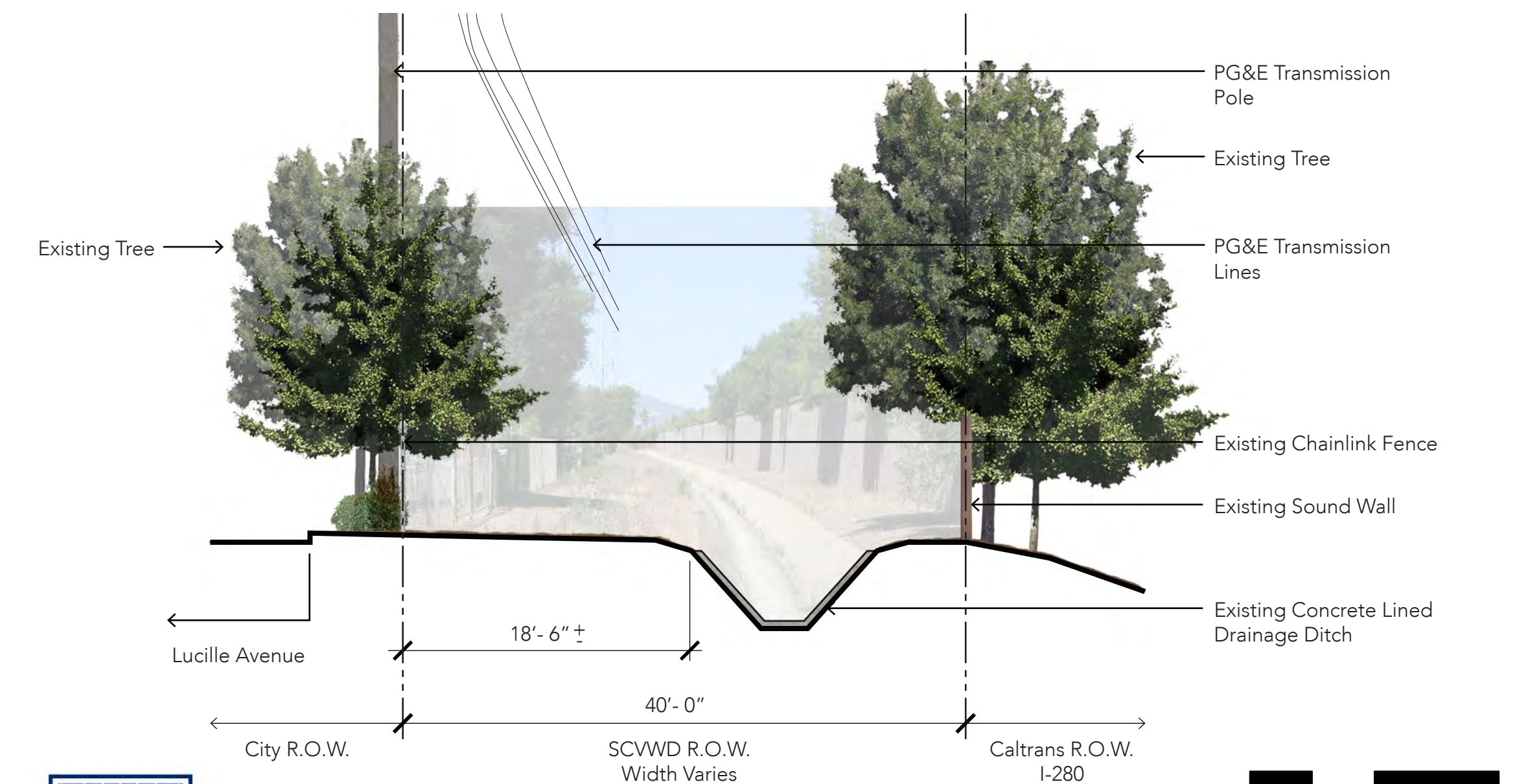

Alternative #1

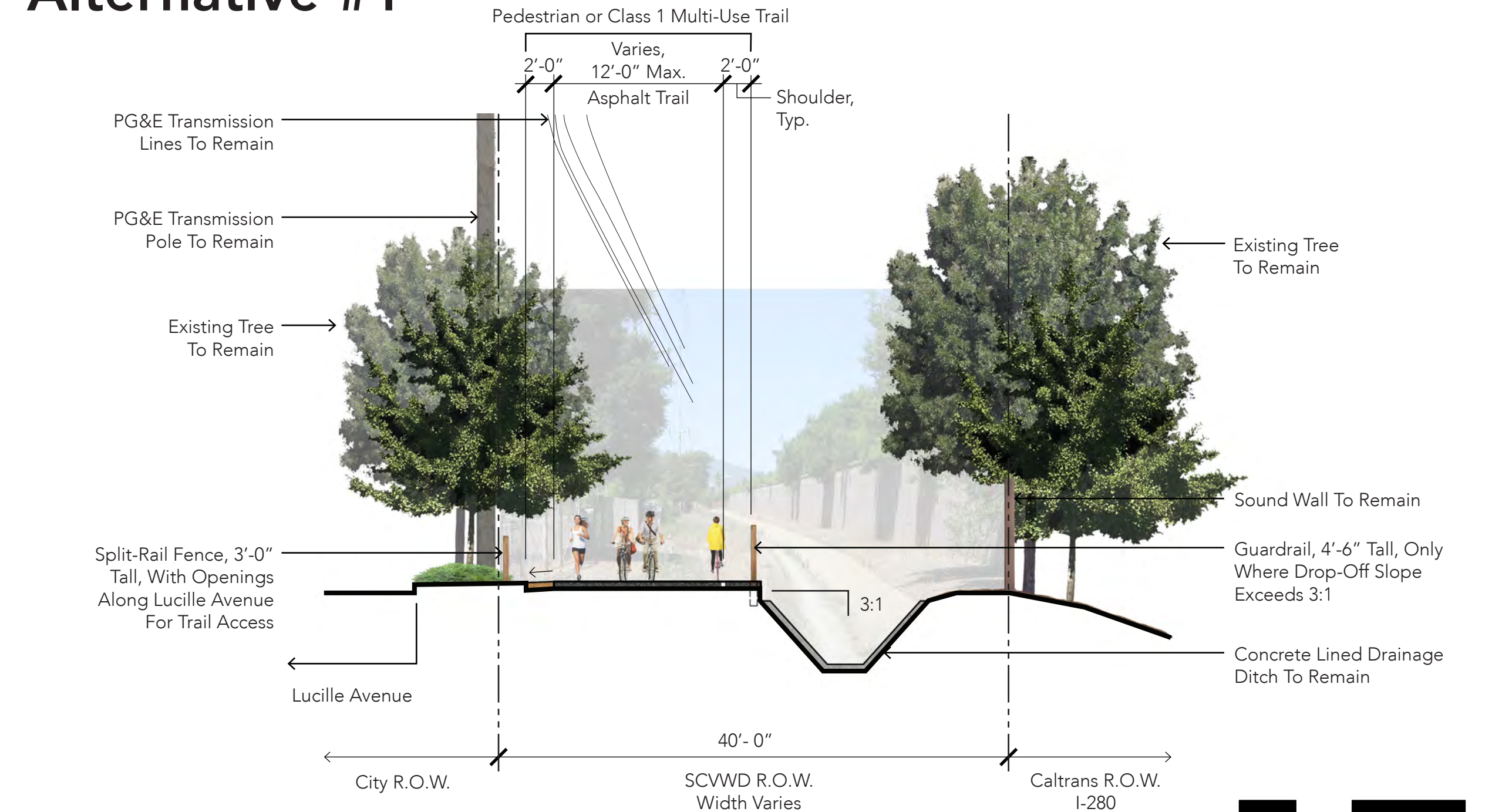

Alternative #2

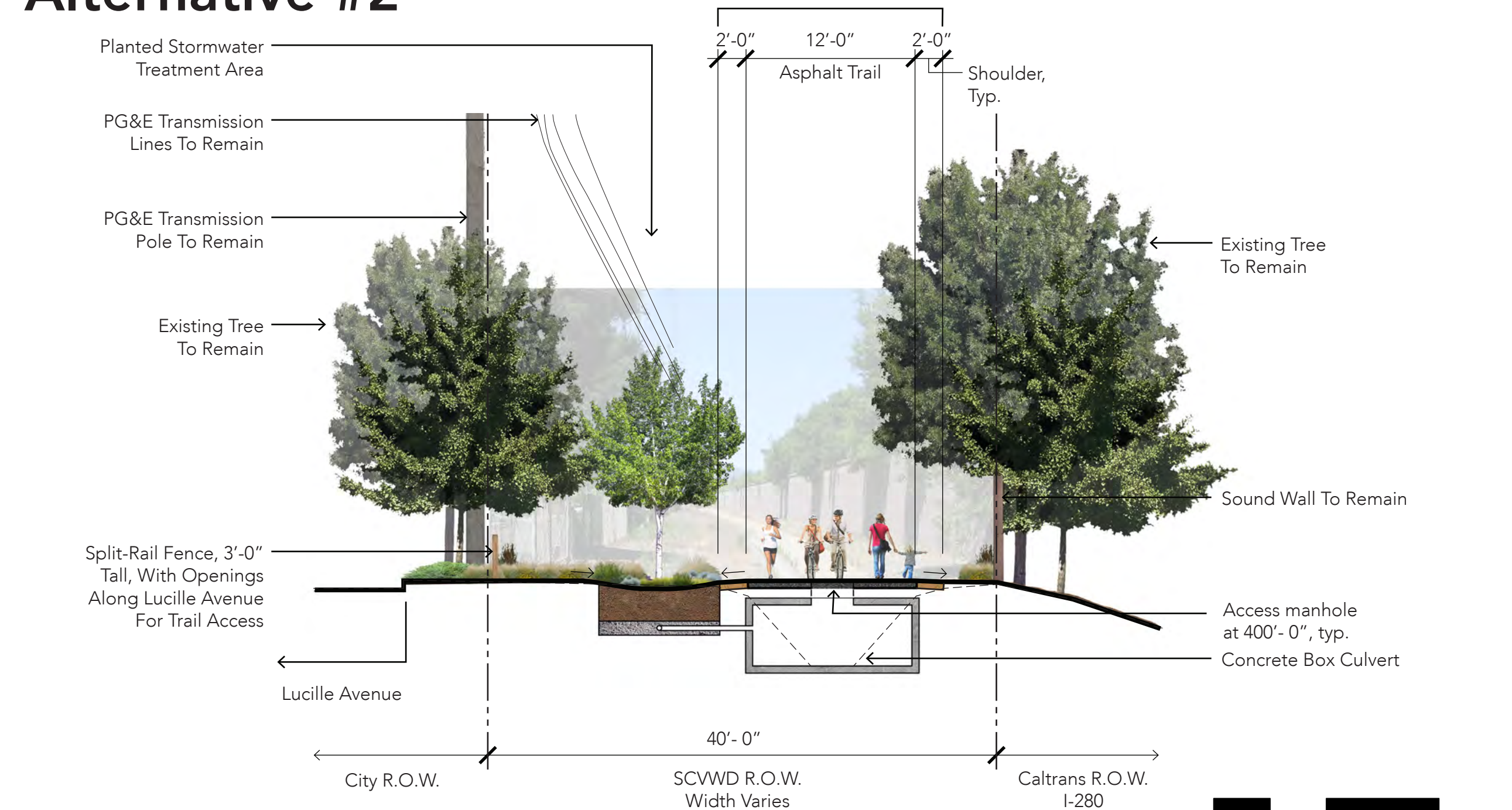



North Portal Avenue Spur Trail Enlargement

