

VALLCO TOWN CENTER

OWNER - VALLCO PROPERTY OWNER LLC
965 PAGE MILL ROAD, PALO ALTO, CA 94304
T. 650-344-1500

ARCHITECTURE - RAFAEL VINOLY ARCHITECTS
50 VANDAM STREET, NEW YORK, NY 10013
T. 212-924-0500

ARCHITECTURE - RAFAEL VINOLY ARCHITECTS
1033 N. WOLFE ROAD, CUPERTINO, CA 95014
T. 408-627-7000

LANDSCAPE ARCHITECTURE - OLIN PARTNERSHIP LTD.
150 S. INDEPENDENCE MALL, IV, SUITE 1103, PHILADELPHIA, PA 19106
T. 215-440-0030

CIVIL - SANDIS CIVIL ENGINEERS SURVEYORS PLANNERS, INC.
1705 S. WINCHESTER BLVD, SUITE 200, CAMPBELL, CA 95008
T. 408-636-0500

TRANSPORTATION ENGINEERING - ARUP NORTH AMERICA, LTD.
860 MISSION STREET, SUITE 700, SAN FRANCISCO, CA 94105
T. 415-567-9445

LIGHTING - ONE LUX STUDIO
158 WEST 29TH STREET, 10TH FLOOR, NEW YORK, NY 10001
T. 212-201-6750

SIGNAGE - EXIT
1617 JPK BLVD, SUITE 1665, PHILADELPHIA, PA 19103
T. 215-681-1150

PARKING ENGINEERING - WATRY DESIGN, INC.
2099 GATEWAY PLACE, SUITE 550, SAN JOSE, CA 95110
T. 408-392-7000

WASTE MANAGEMENT - CINLITTLE INTERNATIONAL
535 NORTH BRAND BLVD, STE 710 GLENDALE, CA 92103
T. 626-441-7700

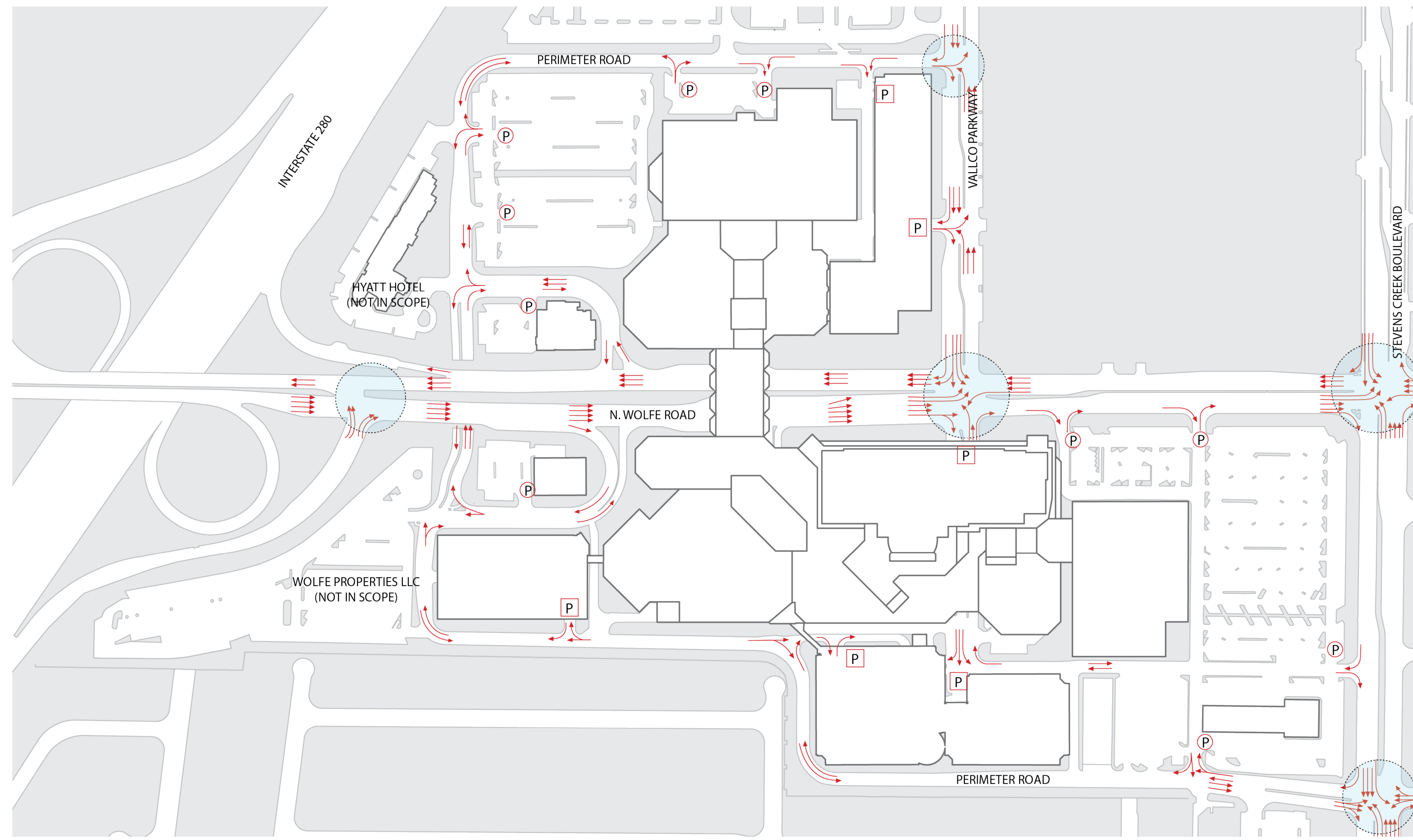

- LEGEND
- P OPEN AIR PARKING ENTRANCE / EXIT
 - P STRUCTURED PARKING ENTRANCE / EXIT
 - SIGNALIZED INTERSECTIONS

EXISTING VEHICLE ACCESS PLAN
N.T.S.

2

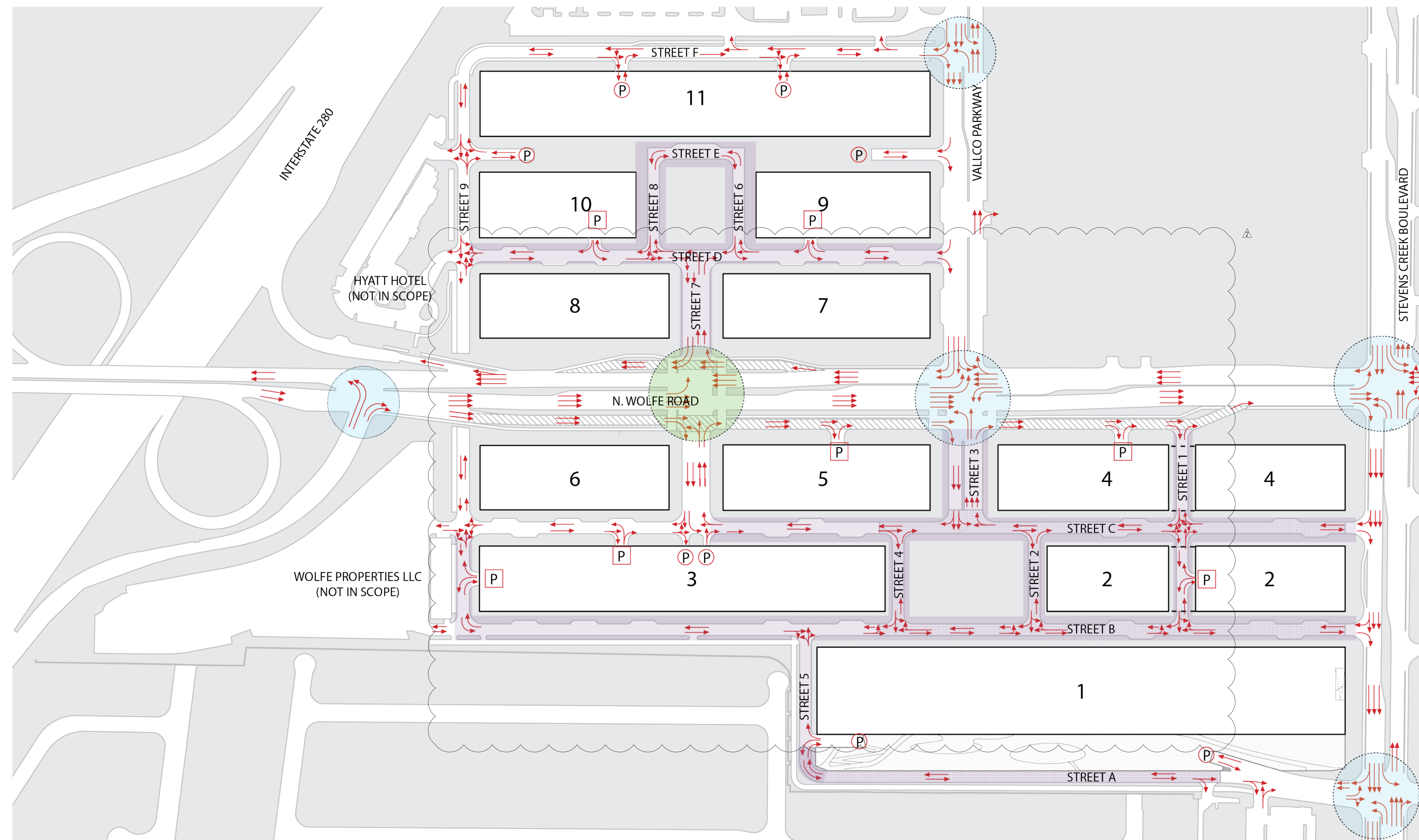

- LEGEND
- P UNDERGROUND PARKING ENTRANCE / EXIT
 - P STRUCTURED PARKING ENTRANCE / EXIT
 - SIGNALIZED INTERSECTIONS
 - PROPOSED SIGNALIZED INTERSECTIONS
 - VEHICLE CIRCULATION
 - RESTRICTED VEHICLE ACCESS DURING COMMUNITY EVENTS
 - WOLFE FRONTAGE ROAD

NOTE:
- RESTRICTED VEHICLE ACCESS DURING COMMUNITY EVENTS, EMERGENCY VEHICLE AND LOCAL RESIDENT ACCESS WILL REMAIN UNBLOCKED BY ANY STRUCTURES AT ALL TIMES DURING THE CLOSURE.

PROPOSED VEHICLE ACCESS PLAN
N.T.S.

1

NOT FOR CONSTRUCTION

DISCLAIMER
THE ARCHITECT / ENGINEER SHALL HAVE NO RESPONSIBILITY FOR ANY LIABILITY, LOSS, COST, DAMAGE OR EXPENSE ARISING FROM OR RELATING TO ANY USE OF THIS DOCUMENT FOR ANY PURPOSE OTHER THAN ITS INTENDED PURPOSE ON THIS PROJECT. THIS DOCUMENT IS TO BE CONSIDERED IN CONJUNCTION WITH ALL RELATED DOCUMENTATION. ANY DISCREPANCIES IDENTIFIED IN THIS DOCUMENT MUST BE REPORTED IMMEDIATELY TO THE ARCHITECT BEFORE PROCEEDING. CONTRACTORS MUST VERIFY ALL DIMENSIONS PRIOR TO PROCEEDING WITH ANY WORK. ONLY FIGURED DIMENSIONS ARE TO BE USED FOR VERIFICATION.

SB-35 DEVELOPMENT APPLICATION

REV	DESCRIPTION	DATE
REV-0	SB-35 DEVELOPMENT APPLICATION	03/27/2018
REV-1	SB-35 APPLICATION REVISIONS	01/31/2018
REV-2	SB-35 APPLICATION REVISIONS	09/22/2018

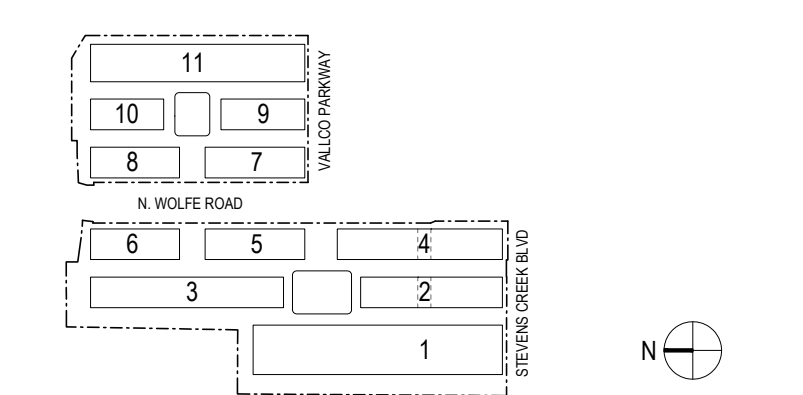

ARCHITECTS PROJECT NUMBER: 708011

PROJECT PHASE: SB-35 DEVELOPMENT APPLICATION

IF THIS DRAWING IS NOT 36"X48" IT IS A REDUCED PRINT. REFER TO GRAPHIC SCALE.



SCALE: N.T.S.

SITE DIAGRAMS - VEHICULAR CIRCULATION

SHEET TITLE:

P-0505

SHEET NUMBER: © 2018 RAFAEL VINOLY ARCHITECTS P.C.

VALLCO TOWN CENTER

OWNER - VALLCO PROPERTY OWNER LLC
965 PAGE MILL ROAD, PALO ALTO, CA 94304
T. 650-344-1500

ARCHITECTURE - RAFAEL VINOLY ARCHITECTS
50 VANDAM STREET, NEW YORK, NY 10013
T. 212-929-0500

ARCHITECTURE - RAFAEL VINOLY ARCHITECTS
1033 N. WOLFE ROAD, CUPERTINO, CA 95014
T. 408-627-7900

LANDSCAPE ARCHITECTURE - OLIN PARTNERSHIP LTD.
150 S. INDEPENDENCE MALL, IV, SUITE 1100, PHILADELPHIA, PA 19106
T. 215-440-0000

CIVIL - SANDIS CIVIL ENGINEERS SURVEYORS PLANNERS, INC.
1705 S. WINCHESTER BLVD, SUITE 200, CAMPBELL, CA 95008
T. 408-636-0000

TRANSPORTATION ENGINEERING - ARUP NORTH AMERICA, LTD.
560 MISSION STREET, SUITE 700, SAN FRANCISCO, CA 94105
T. 415-557-9445

LIGHTING - ONE LUX STUDIO
158 WEST 20TH STREET, 10TH FLOOR, NEW YORK, NY 10011
T. 212-201-5750

SIGNAGE - EXIT
1617 JFK BLVD, SUITE 1665, PHILADELPHIA, PA 19103
T. 215-561-1150

PARKING ENGINEERING - WATRY DESIGN, INC.
2099 GATEWAY PLACE, SUITE 550, SAN JOSE, CA 95110
T. 408-352-7900

WASTE MANAGEMENT - CH2M HILL INTERNATIONAL
535 NORTH BRAND BLVD, STE 710 GLENDALE, CA 92103
T. 626-441-7700

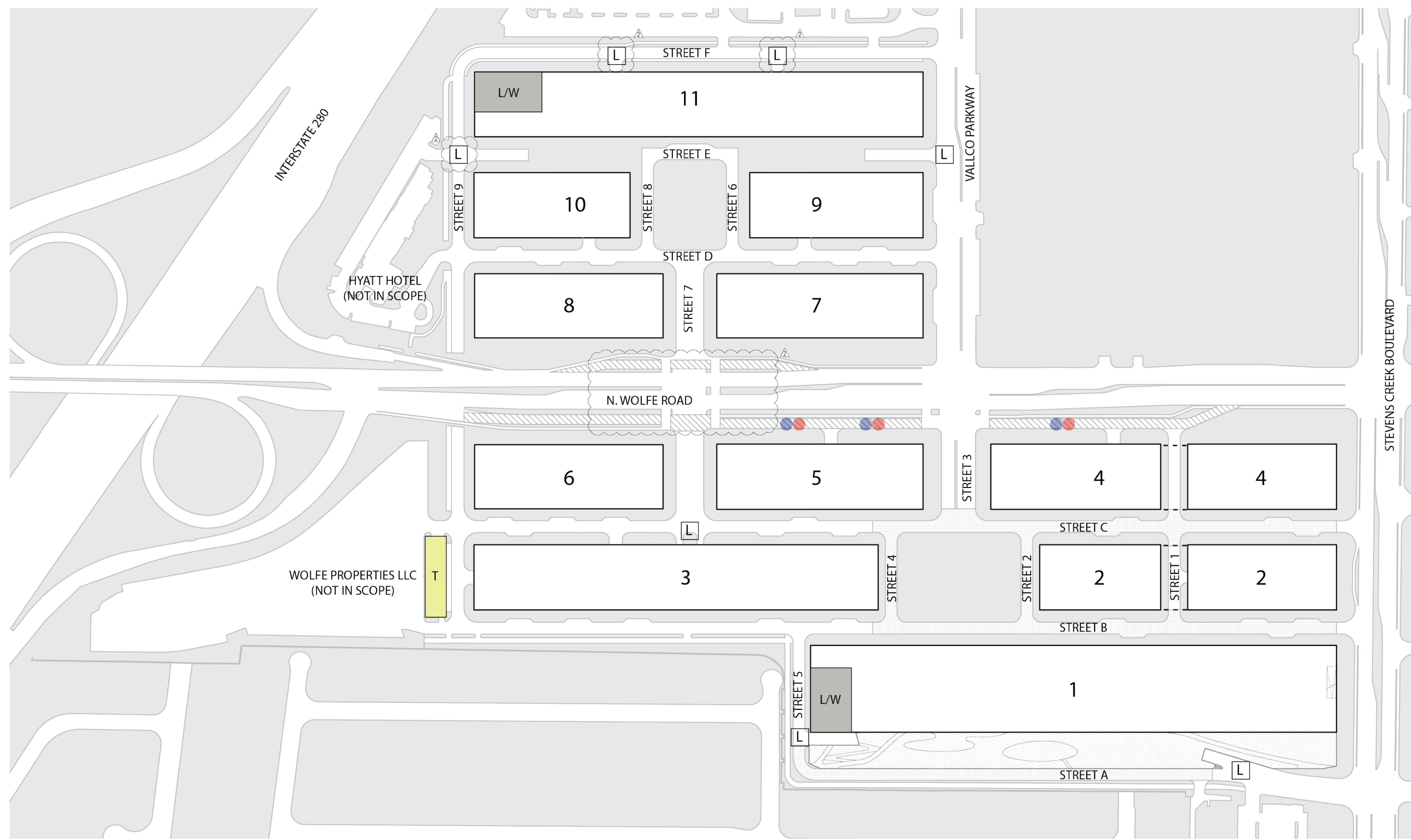

- LEGEND
- T PLANT / OPTIONAL AUXILIARY FIRE STATION
 - L LOADING ENTRANCE TO BASEMENT
 - L/W CENTRAL WASTE MANAGEMENT CENTER
 - TIME LIMITED LOADING ZONE
 - PUBLIC DROP-OFF / PICK-UP ZONE

LOADING & TRASH AREA DIAGRAM - STREET LEVEL
N.T.S. 2

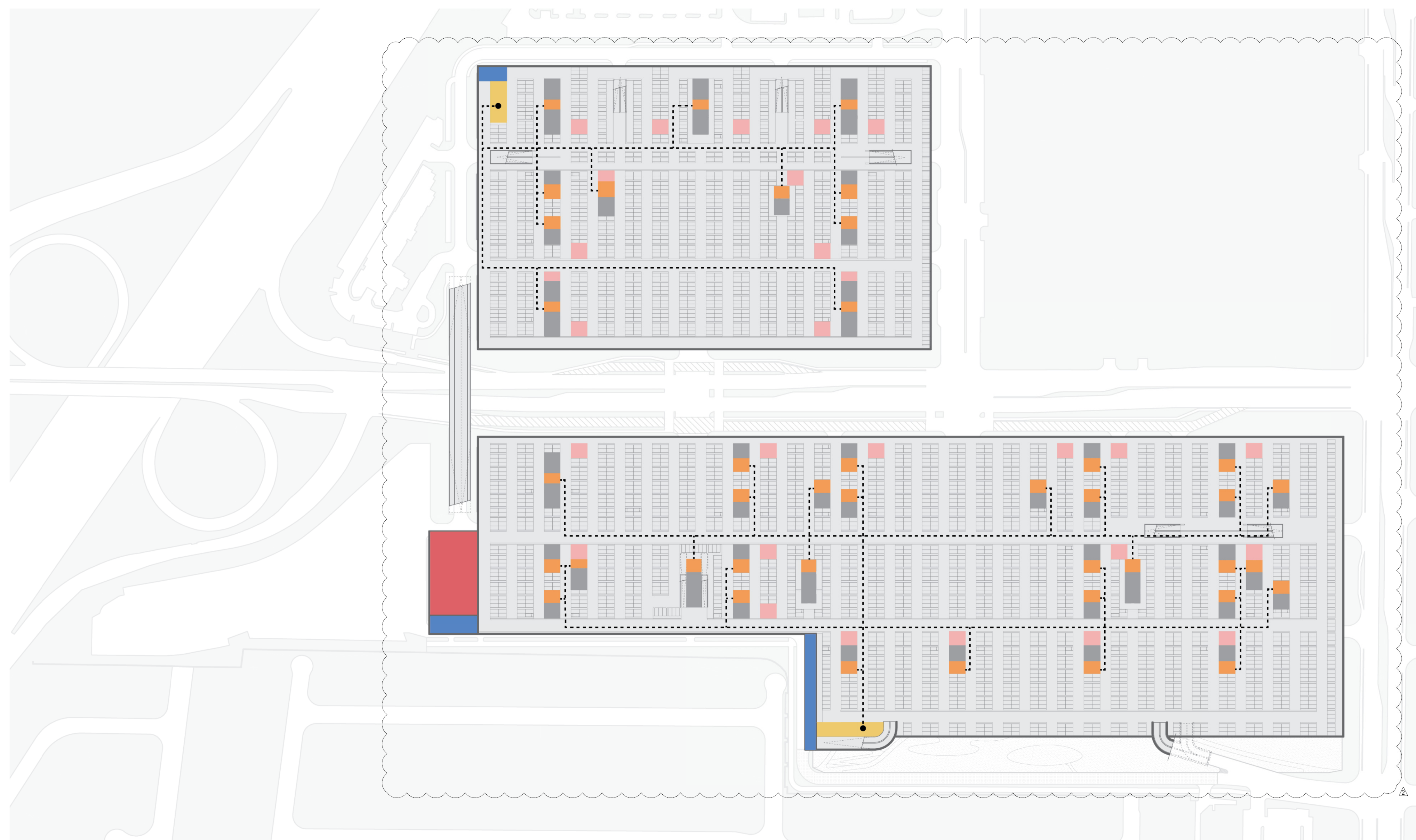

- LEGEND
- UTILITY TRUCK ROUTE
 - TRASH COLLECTION ROOMS
 - TIME LIMITED LOADING ZONE
 - BUILDING ELEVATOR / STAIR CORES
 - CENTRAL PLANT
 - WASTE MANAGEMENT COLLECTION STATION
 - CISTERNS (RAIN CAPTURE / GREY WATER)

LOADING & TRASH AREA DIAGRAM - B1 PARKING LEVEL
N.T.S. 1

NOT FOR CONSTRUCTION

DISCLAIMER
THE ARCHITECT / ENGINEER SHALL HAVE NO RESPONSIBILITY FOR ANY LIABILITY, LOSS, COST, DAMAGE OR EXPENSE ARISING FROM OR RELATING TO ANY USE OF THIS DOCUMENT FOR ANY PURPOSE OTHER THAN ITS INTENDED PURPOSE ON THIS PROJECT. THIS DOCUMENT IS TO BE CONSIDERED IN CONJUNCTION WITH ALL RELATED DOCUMENTATION. ANY DISCREPANCIES IDENTIFIED IN THIS DOCUMENT MUST BE REPORTED IMMEDIATELY TO THE ARCHITECT BEFORE PROCEEDING. CONTRACTORS MUST VERIFY ALL DIMENSIONS PRIOR TO PROCEEDING WITH ANY WORK. ONLY FIGURED DIMENSIONS ARE TO BE USED FOR VERIFICATION.

SB-35 DEVELOPMENT APPLICATION

REV	DESCRIPTION	DATE
REV-0	SB-35 DEVELOPMENT APPLICATION	03/27/2018
REV-1	SB-35 APPLICATION REVISIONS	07/31/2018
REV-2	SB-35 APPLICATION REVISIONS	09/22/2018

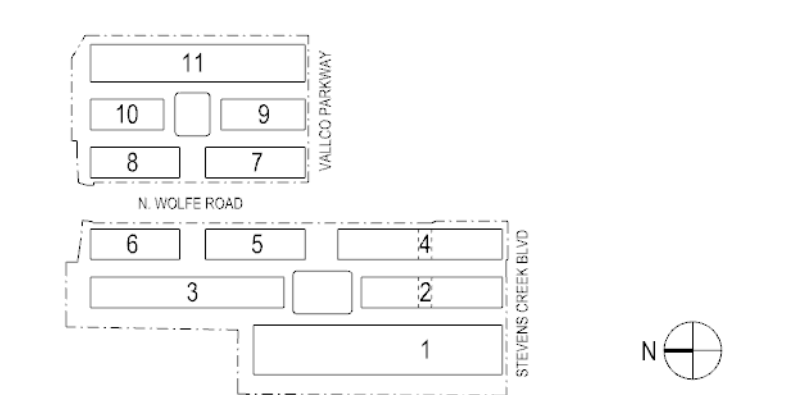

ARCHITECTS PROJECT NUMBER: 708011
PROJECT PHASE: SB-35 DEVELOPMENT APPLICATION

IF THIS DRAWING IS NOT 36"X48" IT IS A REDUCED PRINT. REFER TO GRAPHIC SCALE.



SITE DIAGRAMS - LOADING & TRASH AREA

SHEET TITLE

P-0509

SHEET NUMBER: © 2018 RAFAEL VINOLY ARCHITECTS PCL