

**Westport Development
Senior Advisory Council
21267 Stevens Creek Boulevard**

January 24, 2022



CUPERTINO



Timeline

- August 2020 – City Council Approved
- July 2021 – Staff approved modification to underground parking
- September 2021 – City Council approved modification to add parcel
- December 2021 – City Council approved modification of Building 1

Project Location



- Mix of uses
- Heart of the City Specific Plan Special Area
- Oaks Gateway

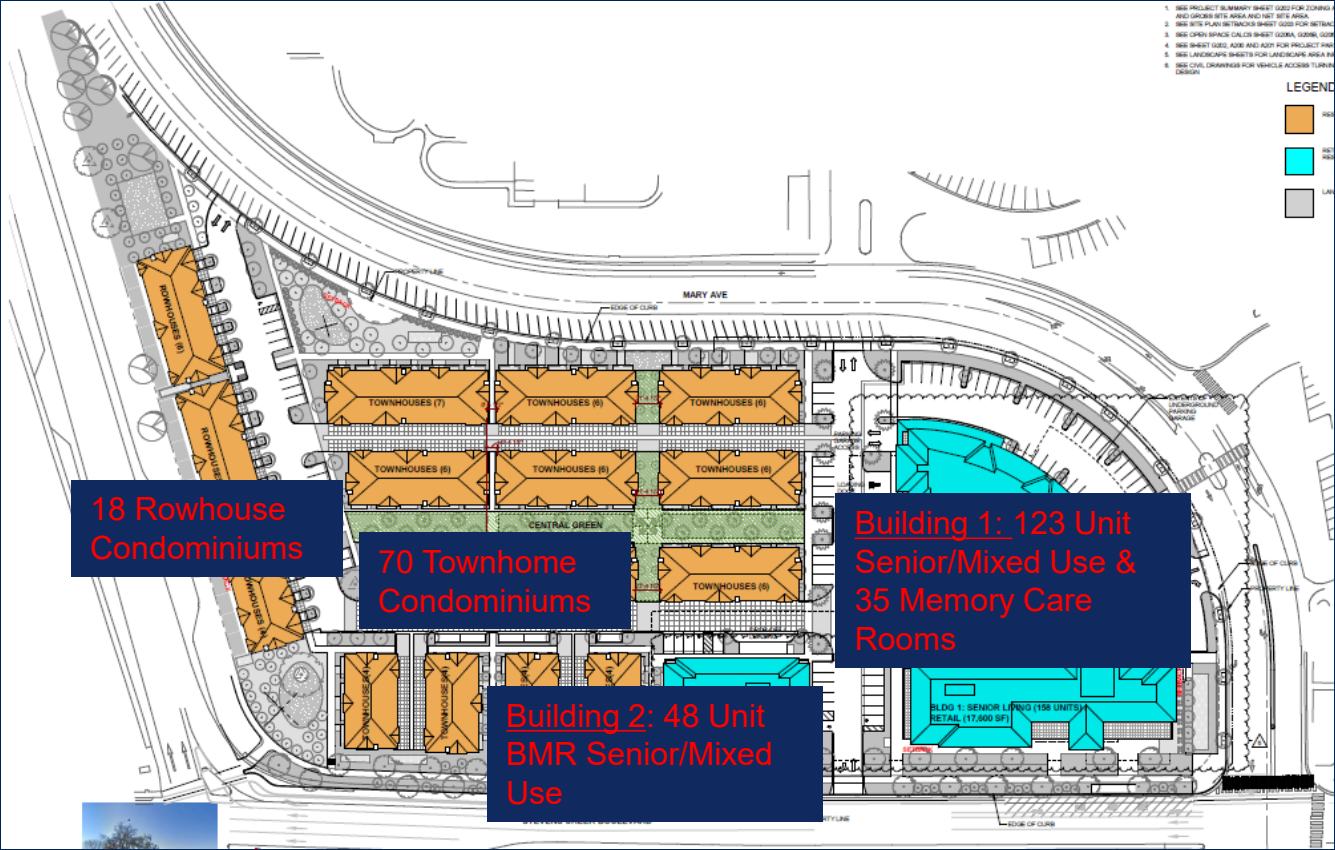

**18 Rowhouse
Condominiums**

**70 Townhome
Condominiums**

**Building 1: 123 Unit
Senior/Mixed Use &
35 Memory Care
Rooms**

**Building 2: 48 Unit
BMR Senior/Mixed
Use**



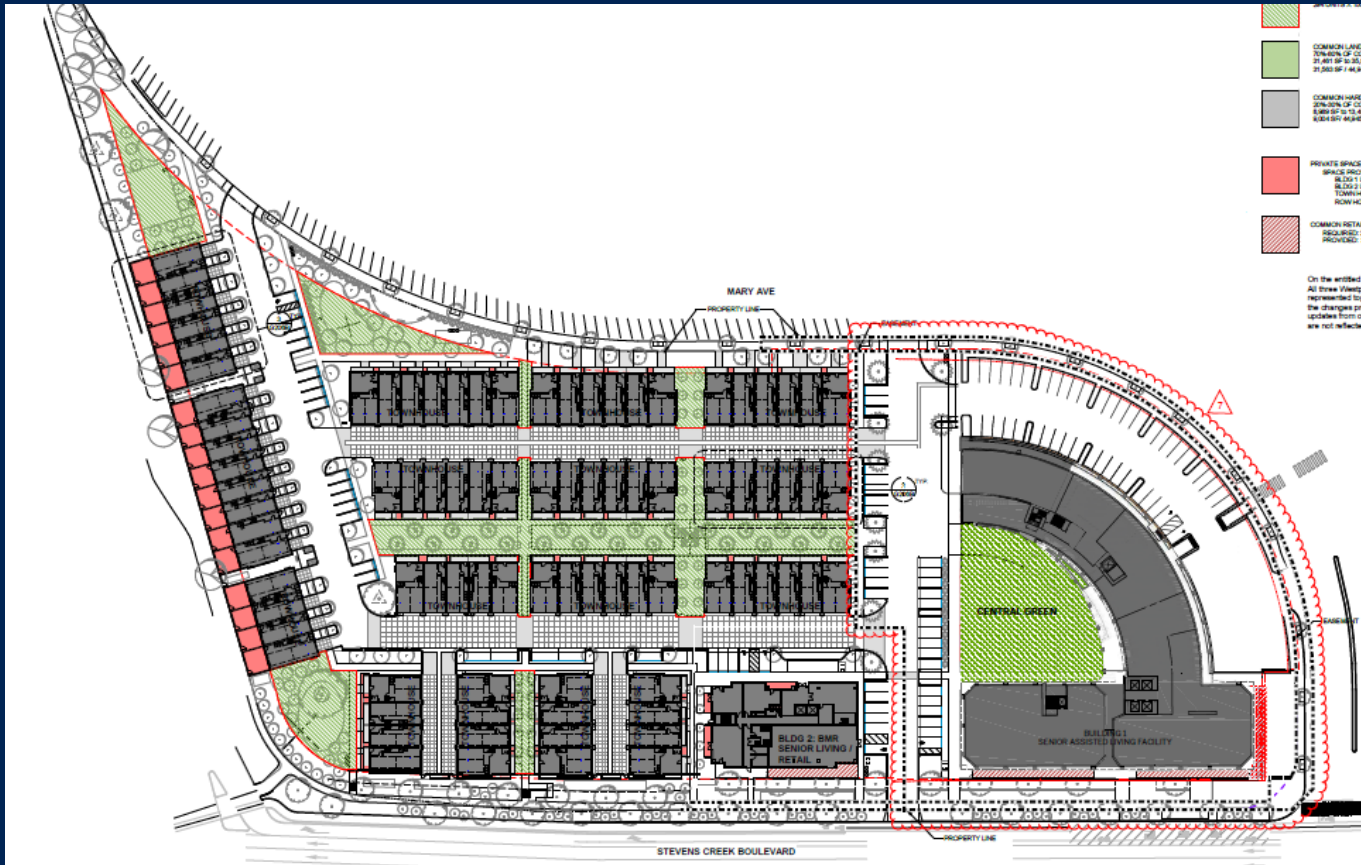

Architectural Design

View from Mary Avenue

Building 1

Building 2

Townhomes

Rowhouses



View from Stevens Creek Boulevard

Rowhouses

Townhomes

Building 2

Building 1



Building 1



STEVENS CREEK BLVD - SOUTH ELEVATION 3
SCALE 1/8" = 1'-0"



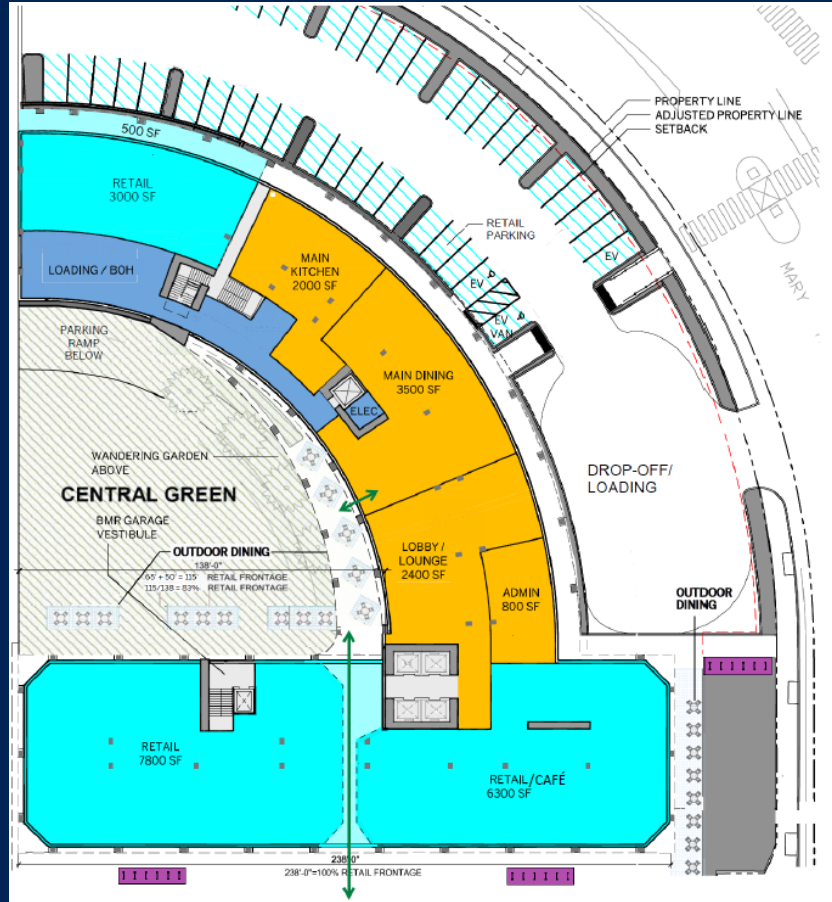

Building 2



Townhouses



2 TOWNHOUSE 4 UNIT - FRONT ELEVATION
302' x 110'



Rowhouses



2 ROWHOUSE 7 UNIT - EAST ELEVATION
302' x 110'



