

CALABAZAS CREEK

4-STORY  
OFFICE  
BUILDING

TANTAU AVENUE

VALLCO PARKWAY

PROPOSED 12' H.  
VEHICULAR POLE  
LIGHT, TYP.

PROPOSED 10' H.  
PENDENT LIGHT, TYP.

PROPOSED TREE  
UP LIGHT, TYP.

PROPOSED 12' H.  
PEDESTRIAN POLE LIGHT,  
TYP.

PROPOSED  
43' H.  
BOLLARD  
LIGHT, TYP.

PROPOSED RECESSED NICHE  
LIGHT UNDER ACCENT WALL,  
TYP.

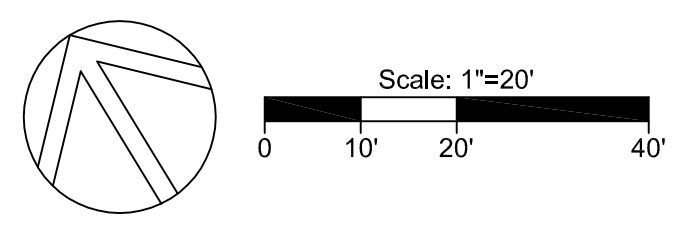

**L04.1 - Site Lighting Plan**

**Apple, Inc.**  
05.23.2022 Scale: 1" = 20'-0"

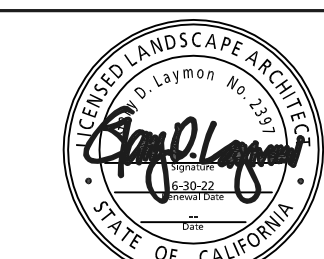

The Guzzardo Partnership, Inc.  
Landscape Architects | Land Planners  
181 Greenwich Street  
San Francisco, CA 94111  
415.433.8777 | www.tgpa.com

**STUDIOS**  
architecture

COPYRIGHT © 2020 BY STUDIOS architecture

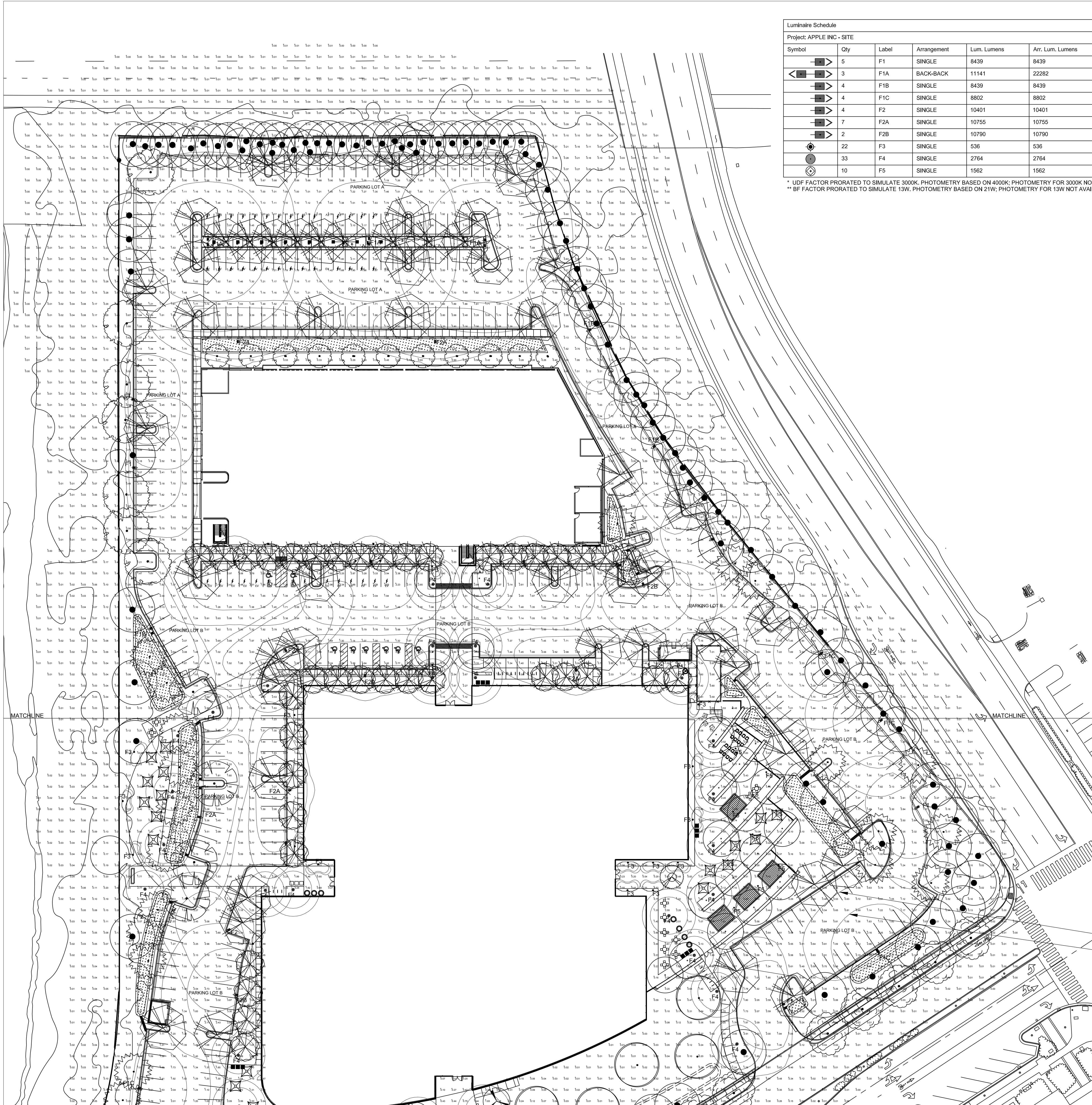

Symbol	Qty	Label	Arrangement	Lum. Lumens	Arr. Lum. Lumens	LLF	LDD	LLD	UDF *	BF **	Description	Filename	Lum. Watts
[Symbol]	5	F1	SINGLE	8439	8439	0.850	0.900	0.944	N.A.	N.A.	GARDCO P26-48L-500-NW-G2-AR-3-VOLT-HIS-(SINGLE) - 21' L.C.	p26-48l-500-nw-g2-3-his.ies	74.35753
[Symbol]	3	F1A	BACK-BACK	11141	22282	0.850	0.900	0.944	N.A.	N.A.	GARDCO P26-48L-500-NW-G2-AR-6W-VOLT-XX-(TWIN) - 21' L.C.	p26-48l-500-nw-g2-6w.ies	74.35753
[Symbol]	4	F1B	SINGLE	8439	8439	0.850	0.900	0.944	N.A.	N.A.	GARDCO P26-48L-500-NW-G2-AR-2-VOLT-HIS-(SINGLE) - 21' L.C.	p26-48l-500-nw-g2-2-his.ies	74.35753
[Symbol]	4	F1C	SINGLE	8902	8902	0.850	0.900	0.944	N.A.	N.A.	GARDCO P26-48L-500-NW-G2-AR-4-VOLT-HIS-(SINGLE) - 21' L.C.	p26-48l-500-nw-g2-4-his.ies	74.35753
[Symbol]	4	F2	SINGLE	10401	10401	0.850	0.900	0.944	N.A.	N.A.	GARDCO P26-48L-500-NW-G2-AR-3-VOLT-(SINGLE) - 21' L.C.	p26-48l-500-nw-g2-3.ies	74.35753
[Symbol]	7	F2A	SINGLE	10755	10755	0.850	0.900	0.944	N.A.	N.A.	GARDCO P26-48L-500-NW-G2-AR-2-VOLT-(SINGLE) - 21' L.C.	p26-48l-500-nw-g2-2.ies	74.35753
[Symbol]	2	F2B	SINGLE	10790	10790	0.850	0.900	0.944	N.A.	N.A.	GARDCO P26-48L-500-NW-G2-AR-4-VOLT-(SINGLE) - 21' L.C.	p26-48l-500-nw-g2-4.ies	74.35753
[Symbol]	22	F3	SINGLE	536	536	0.850	0.900	0.944	N.A.	N.A.	LOUIS POULSEN FLINDT 43.3 IN-XX-XX-15W LED3000K-548-VOLT - 3.1' L.C.	US_Light_Measurement_FLINDT_B_CORTEN_30K_V01_B0065_louis_poulsen.ies	15
[Symbol]	33	F4	SINGLE	2764	2764	0.850	0.900	0.944	N.A.	N.A.	LOUIS POULSEN ALBERTSLUND MINI POST X-39W LED3000K-2827-VOLT-U2-XX - 12' POLE	US_Light_Measurement_ALB_MINI_PT_30K_U2_V00_A0420_louis_poulsen.ies	39
[Symbol]	10	F5	SINGLE	1562	1562	0.620	0.900	0.944	0.960	0.760	BK LIGHTING DE-LED-TR-X99-FL-XXX-9-C - 10' L.C.	DE-LED-TR-X125-FL-9-C-13563921.06.ies	21.7398

\* UDF FACTOR PRORATED TO SIMULATE 3000K. PHOTOMETRY BASED ON 4000K; PHOTOMETRY FOR 3000K NOT AVAILABLE AT THE TIME OF THIS ANALYSIS. FIELD RESULTS MAY VARY.  
 \*\* BF FACTOR PRORATED TO SIMULATE 13W. PHOTOMETRY BASED ON 21W; PHOTOMETRY FOR 13W NOT AVAILABLE AT THE TIME OF THIS ANALYSIS. FIELD RESULTS MAY VARY.

Label	CalcType	Units	Avg	Max	Min	Avg/Min	Max/Min	# Pts
PARKING LOT A	Illuminance	Fc	1.02	5.11	0.36	4.50	14.19	682
PARKING LOT B	Illuminance	Fc	1.74	5.36	0.38	4.58	14.11	962

\*Site Lighting to comply with CMC Section 19.102.040.

0.5FC  
1.0FC

\*\*\*LIGHTING LAYOUT VERIFICATION\*\*\*

\*See L04.0 for Lighting Plan with Light Fixture Locations/Information

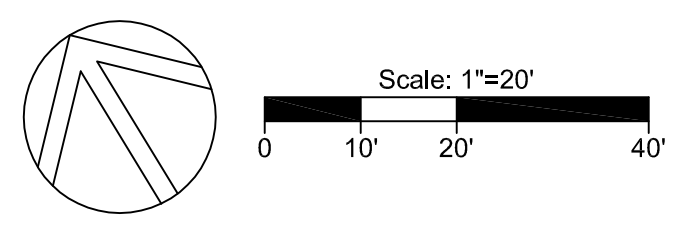

L04.2 - Photometric Plan  
Apple, Inc.

05.23.2022 Scale: 1" = 20'-0"

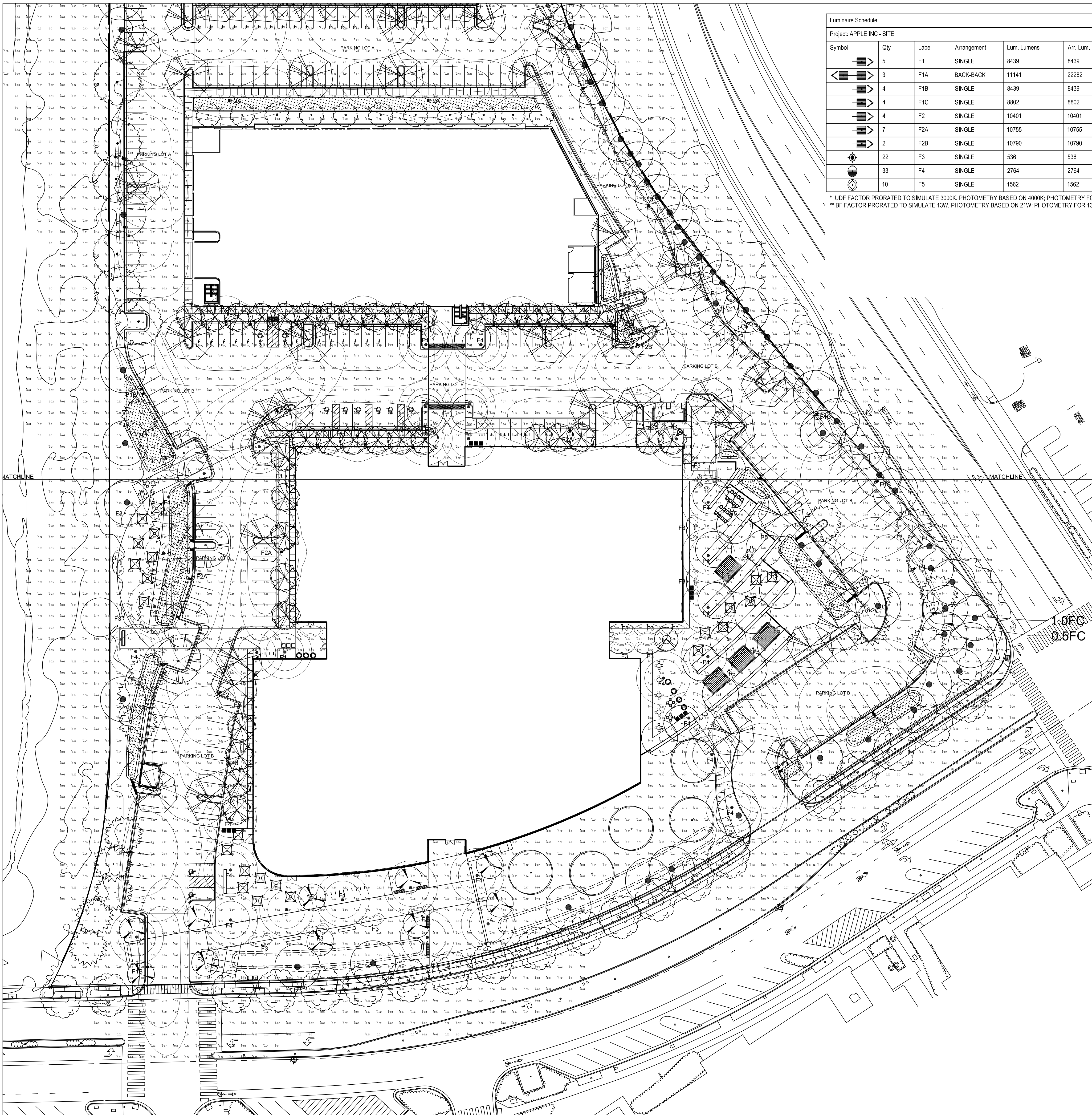

Symbol	Qty	Label	Arrangement	Lum. Lumens	Arr. Lum. Lumens	LLF	LDD	LLD	UDF *	BF **	Description	Filename	Lum. Watts
➡	5	F1	SINGLE	8439	8439	0.850	0.900	0.944	N.A.	N.A.	GARCCO P26-48L-500-NW-G2-AR-3-VOLT-HIS-(SINGLE) - 21' L.C.	p26-48l-500-nw-g2-3-his.ies	74.35753
⬅➡	3	F1A	BACK-BACK	11141	22282	0.850	0.900	0.944	N.A.	N.A.	GARCCO P26-48L-500-NW-G2-AR-5W-VOLT-XX-(TWIN) - 21' L.C.	p26-48l-500-nw-g2-5w.ies	74.35753
➡	4	F1B	SINGLE	8439	8439	0.850	0.900	0.944	N.A.	N.A.	GARCCO P26-48L-500-NW-G2-AR-2-VOLT-HIS-(SINGLE) - 21' L.C.	p26-48l-500-nw-g2-2-his.ies	74.35753
➡	4	F1C	SINGLE	8802	8802	0.850	0.900	0.944	N.A.	N.A.	GARCCO P26-48L-500-NW-G2-AR-4-VOLT-HIS-(SINGLE) - 21' L.C.	p26-48l-500-nw-g2-4-his.ies	74.35753
➡	4	F2	SINGLE	10401	10401	0.850	0.900	0.944	N.A.	N.A.	GARCCO P26-48L-500-NW-G2-AR-3-VOLT-(SINGLE) - 21' L.C.	p26-48l-500-nw-g2-3.ies	74.35753
➡	7	F2A	SINGLE	10755	10755	0.850	0.900	0.944	N.A.	N.A.	GARCCO P26-48L-500-NW-G2-AR-2-VOLT-(SINGLE) - 21' L.C.	p26-48l-500-nw-g2-2.ies	74.35753
➡	2	F2B	SINGLE	10790	10790	0.850	0.900	0.944	N.A.	N.A.	GARCCO P26-48L-500-NW-G2-AR-4-VOLT-(SINGLE) - 21' L.C.	p26-48l-500-nw-g2-4.ies	74.35753
⊙	22	F3	SINGLE	536	536	0.850	0.900	0.944	N.A.	N.A.	LOUIS POULSEN FLINDT 43.3-IN-XX-XX-15W LED/3000K-548-VOLT - 3.1' L.C.	US_Light_Measurement_FLINDT_B_CORTEN_30K_V01_B0065_louis_poulsen.ies	15
⊙	33	F4	SINGLE	2764	2764	0.850	0.900	0.944	N.A.	N.A.	LOUIS POULSEN ALBERTSLUND MINI POST X-39W LED/3000K-2827-VOLT-U2-XX - 12' POLE	US_Light_Measurement_ALB_MINI_PT_30K_U2_V00_A0420_louis_poulsen.IES	39
⊙	10	F5	SINGLE	1562	1562	0.820	0.900	0.944	0.960	0.780	BK LIGHTING DE-LED-TR-x99-FL-XXX-9-C - 10' L.C.	DE-LED-TR-X125-FL-9-C-13583921.06.ies	21.7398

\* UDF FACTOR PRORATED TO SIMULATE 3000K. PHOTOMETRY BASED ON 4000K. PHOTOMETRY FOR 3000K NOT AVAILABLE AT THE TIME OF THIS ANALYSIS. FIELD RESULTS MAY VARY.  
 \*\* BF FACTOR PRORATED TO SIMULATE 13W. PHOTOMETRY BASED ON 21W; PHOTOMETRY FOR 13W NOT AVAILABLE AT THE TIME OF THIS ANALYSIS. FIELD RESULTS MAY VARY.

Label	CalcType	Units	Avg	Max	Min	Avg/Min	Max/Min	# Pts
PARKING LOT A	Illuminance	Fc	1.62	5.11	0.36	4.50	14.19	682
PARKING LOT B	Illuminance	Fc	1.74	5.36	0.38	4.58	14.11	982

\*Site Lighting to comply with CMC Section 19.102.040.

\*\*\*LIGHTING LAYOUT VERIFICATION\*\*\*

\*See L04.1 for Lighting Plan with Light Fixture Locations/Information

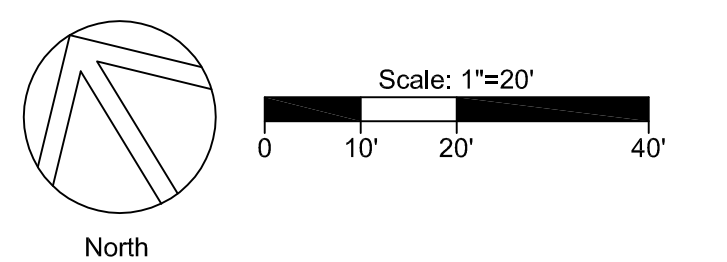

## Outdoor Workspace Systems (Concept)



Covered, Enclosed Private Patio



## Wood and Metal Benches



Wooden and Metal Seating Benches



## Paving Materials and Patterns



Plaza Paving Pattern



Pedestrian Walkway Paving Pattern

## Accent and Seat Walls



Breezeblock Accent Wall, Multiple Heights, See Plans



Accent Feature Wall and Seat Walls

## Utilities and Facilities



Decorative Metal Picket Fence, 6' tall

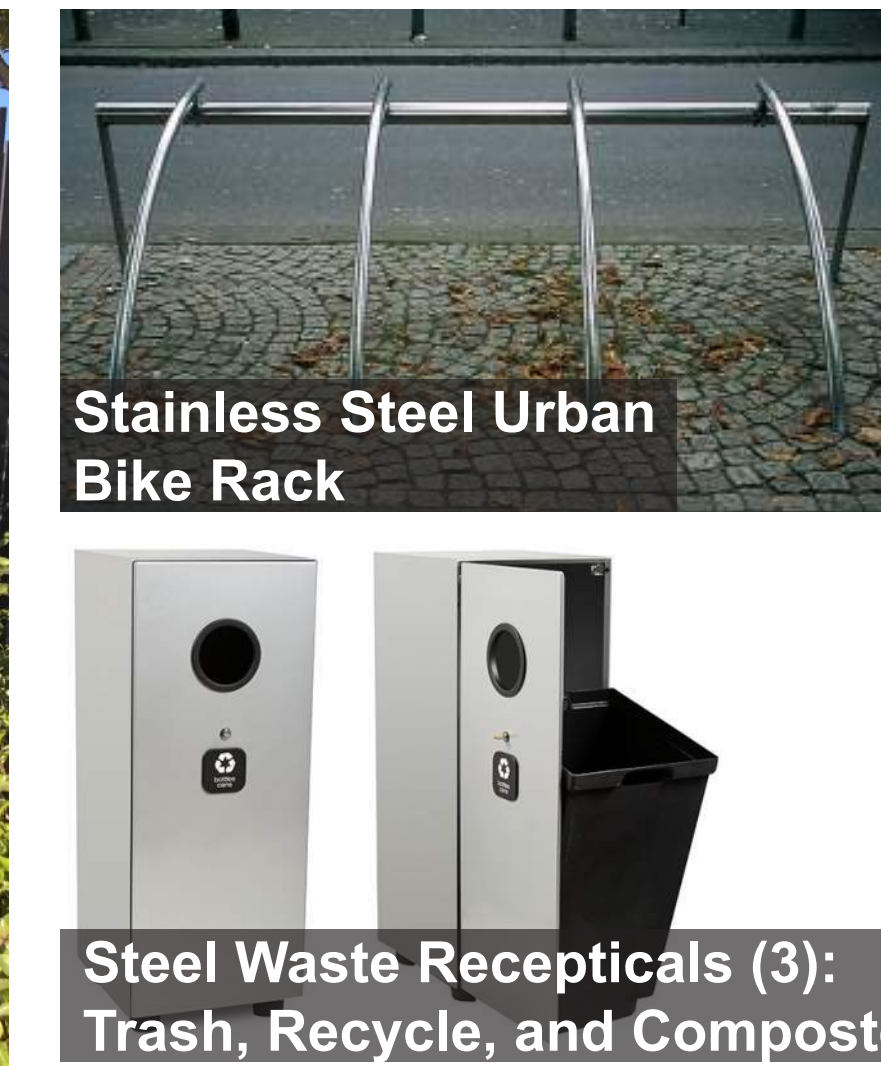

Stainless Steel Urban Bike Rack



Steel Waste Recepticals (3): Trash, Recycle, and Composte



Stainless Steel Urban Ashtray



Stainless Steel Umbrella Canopy Unit (Single/Double)

## Utility Screen Fences

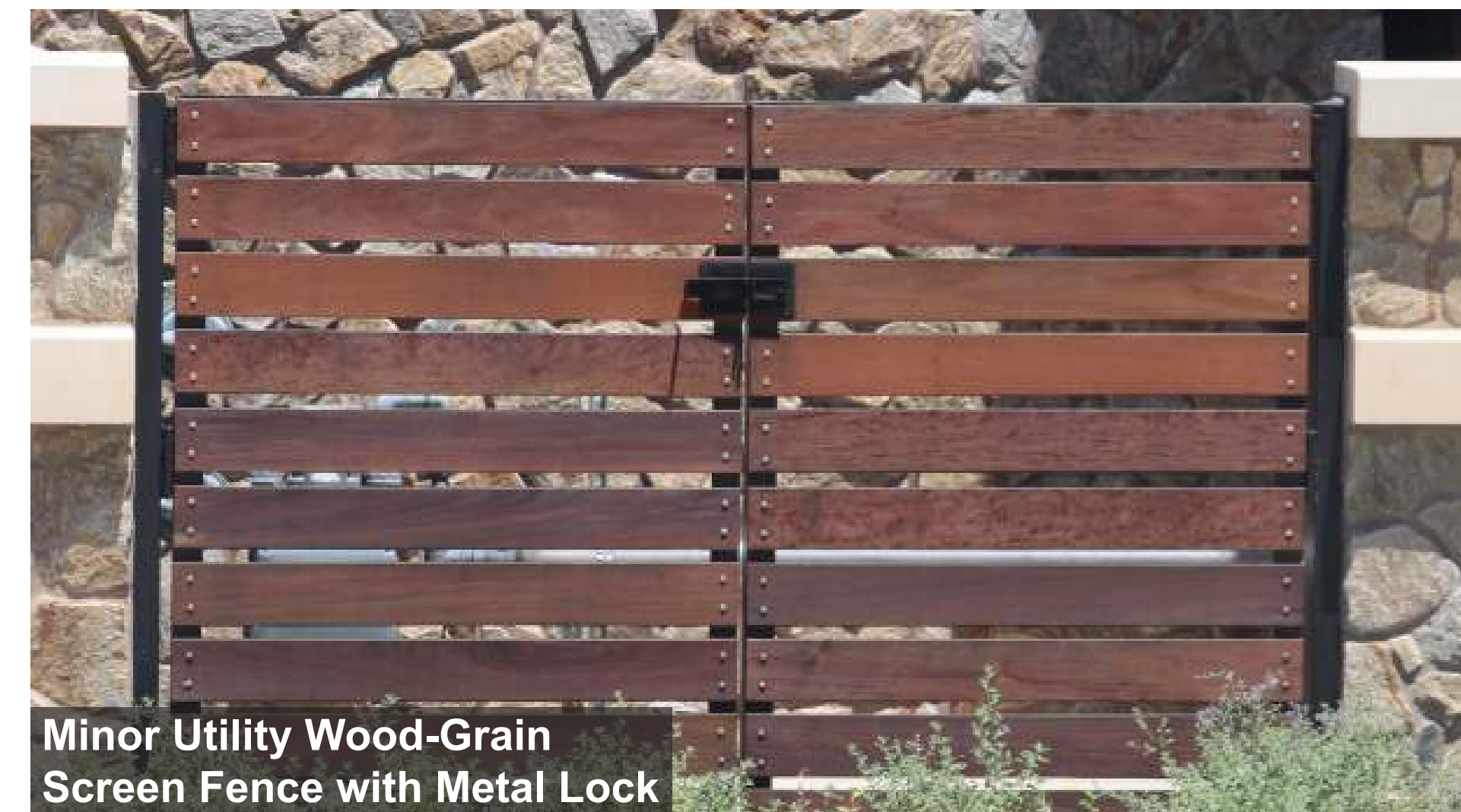

Minor Utility Wood-Grain Screen Fence with Metal Lock



Major Utility Wood-Grain Screen Fence with Utility Access

## Sleek Landscape and Pedestrian Light Fixtures

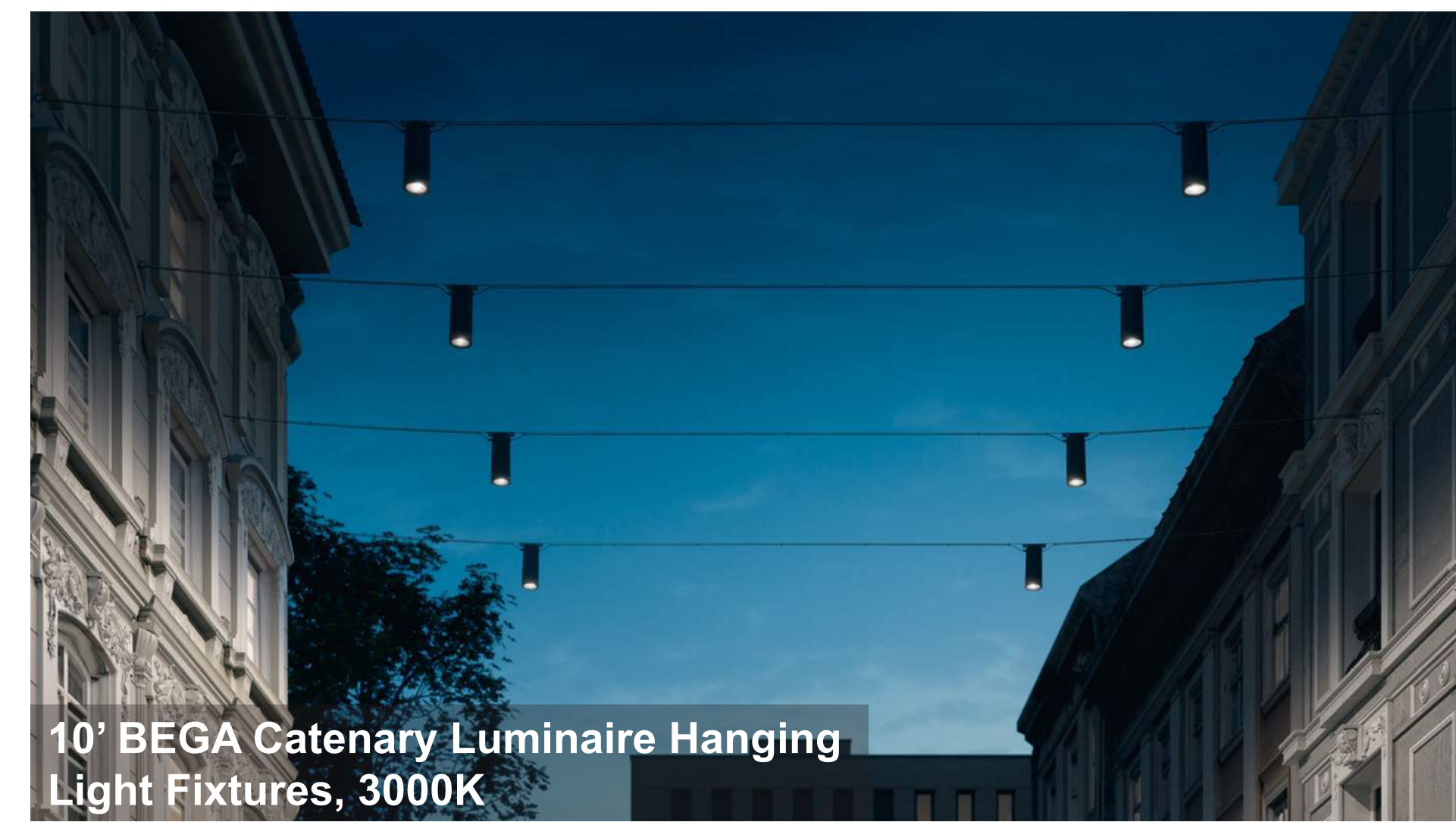

10' BEGA Catenary Luminaire Hanging Light Fixtures, 3000K



Simple 21' Guardco Pole Light Fixture, 3000K

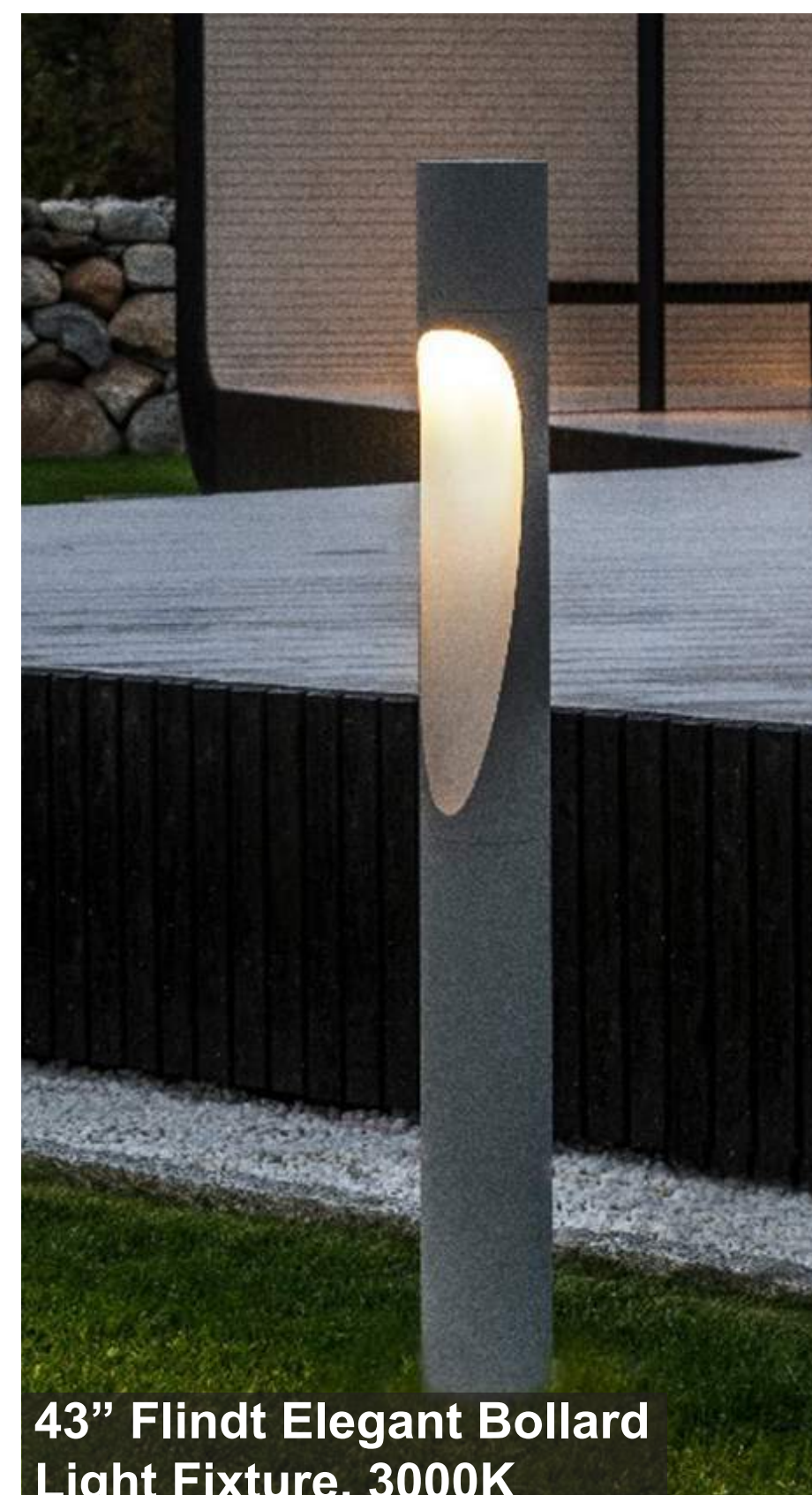

43' Flindt Elegant Bollard Light Fixture, 3000K



12' Poulsen Pole Light Fixture, 3000K

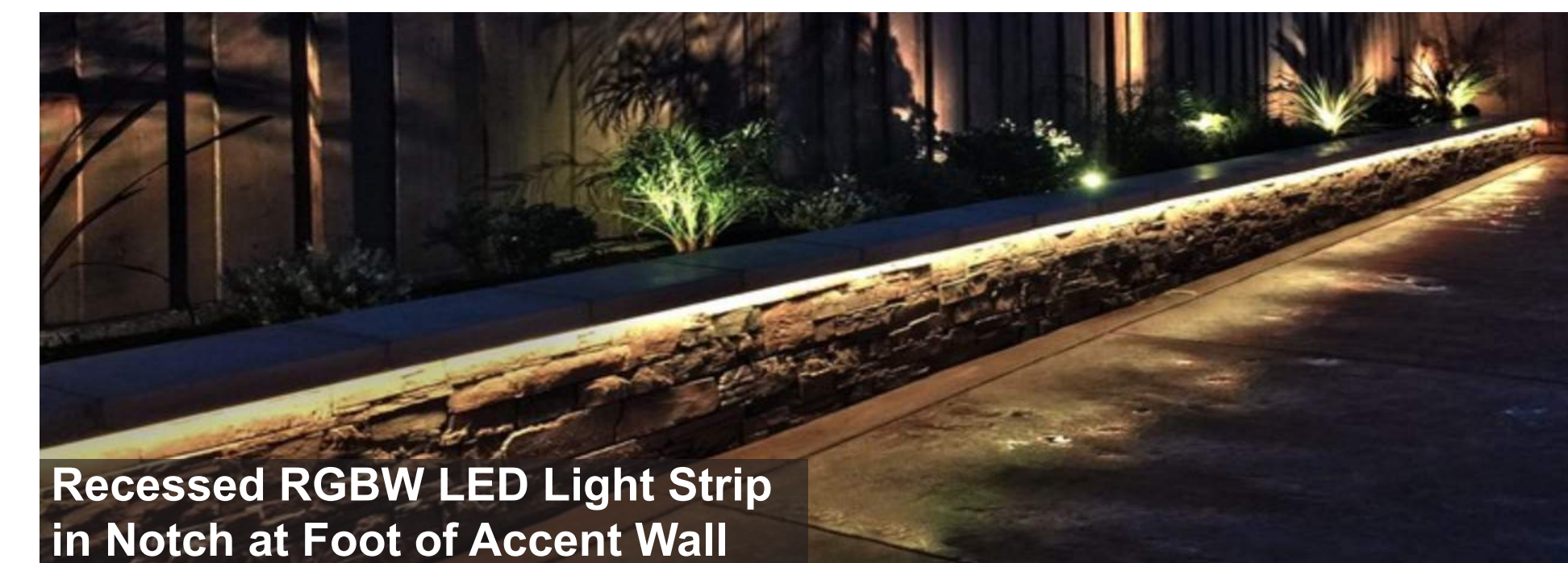

Recessed RGBW LED Light Strip in Notch at Foot of Accent Wall

# TREES

*Aesculus californica*

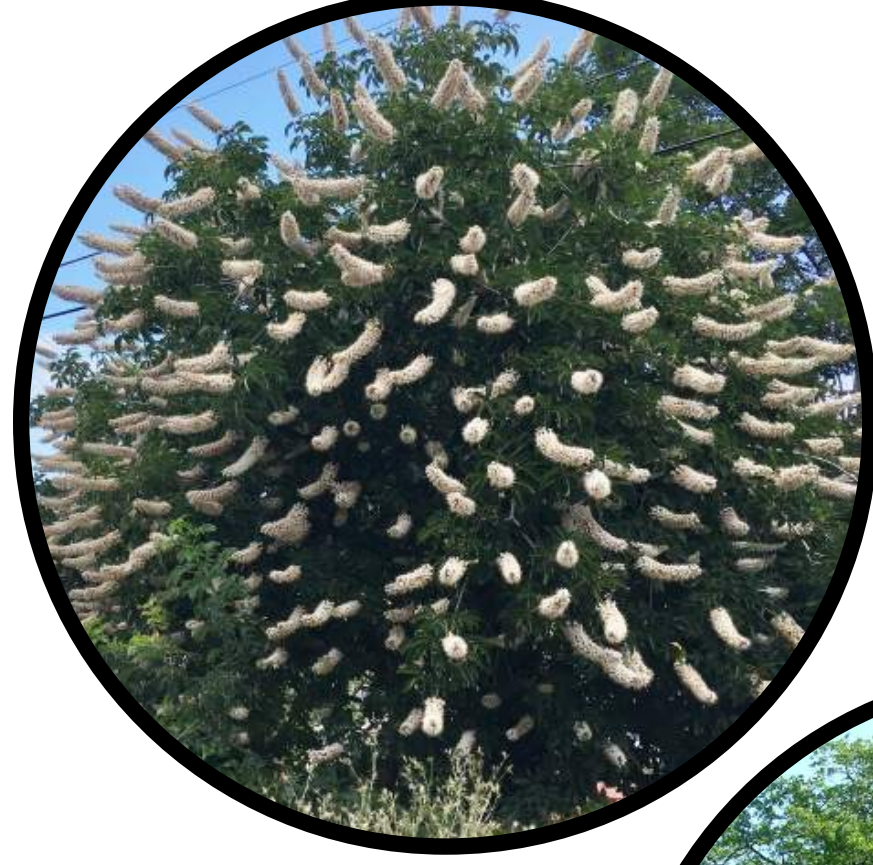

*Fraxinus 'Urbanite'*



*Lagerstroemia indica 'Tuscarora'*



*Olea europaea 'Monher' (Fruitless)*



*Quercus agrifolia*



*Quercus ilex*



*Quercus lobata*



*Quercus rugosa*



*Quercus suber*



*Tristania laurina*



*Ulmus parvifolia 'Drake'*

# SHRUBS AND GRASSES

NOT ALL PLANTS PICTURED

*Acacia cognata 'Cousin Itt'*



*Agave 'Blue Glow'*



*Alyogyne huegelii 'Mood Indigo'*



*Anigozanthos 'Bush Red'*



*Asparagus d. 'Myers'*



*Calamagrostis nutkaensis*



*Callistemon v. 'Little John'*



*Carex tumulicola*



*Chondropetalum tectorum*



*Dianella revoluta 'Baby Bliss'*



*Diets bicolor 'Orange Drop'*



*Eleagnus p. 'Silverberry'*



*Festuca californica 'Serpentine'*



*Hemerocallis - Gold*



*Hemerocallis - Red*



*Ilex vomitoria 'Stokes Dwarf'*



*Iris douglasiana*



*Juncus effusus*



*Lavandula x intermedia 'Alba'*



*Leucadendron 'Safari Sunset'*



# SHRUBS AND GRASSES

NOT ALL PLANTS PICTURED

*Lomandra longifolia* 'Breeze'



*Mimulus aurantiacus*

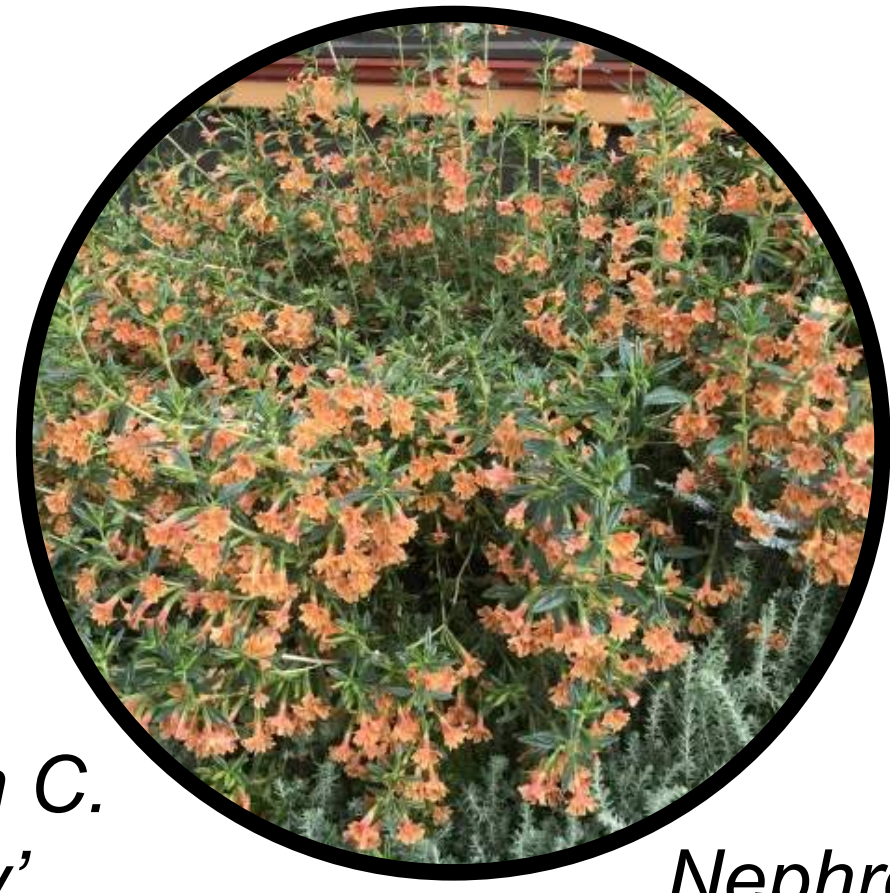

*Muhlenbergia* 'Regal Mist'



*Olea* 'Little Ollie'

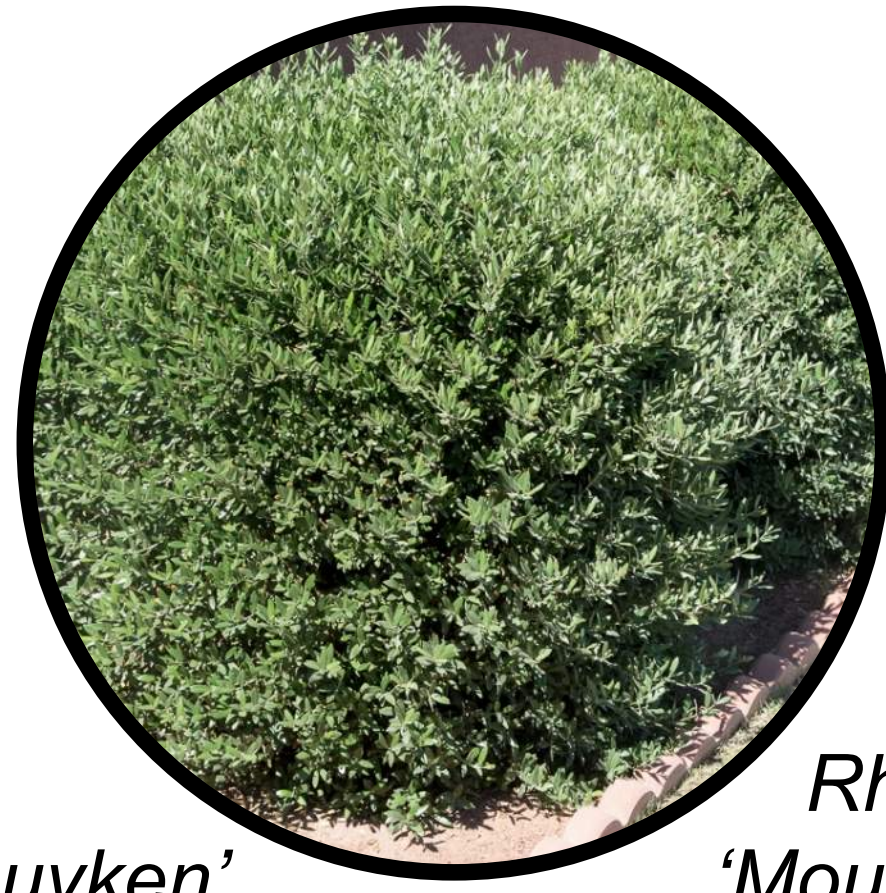

*Loropetalum C.* 'Burgundy'



*Nephrolepis cordifolia*



*Prunus I.* 'Otto Luyken'



*Rhamnus cal.* 'Mound San Bruno'



*Rosa californica*



*Salvia clevelandii*



*Strelitzia reginae*



*Viburnum awabuki* 'Chindo'



# GROUNDCOVERS AND VINES

NOT ALL PLANTS PICTURED

'No-Mow' Fescue



*Arctostaphylos* 'Pacific Mist'



*Erigeron* 'Wayne Roderick'

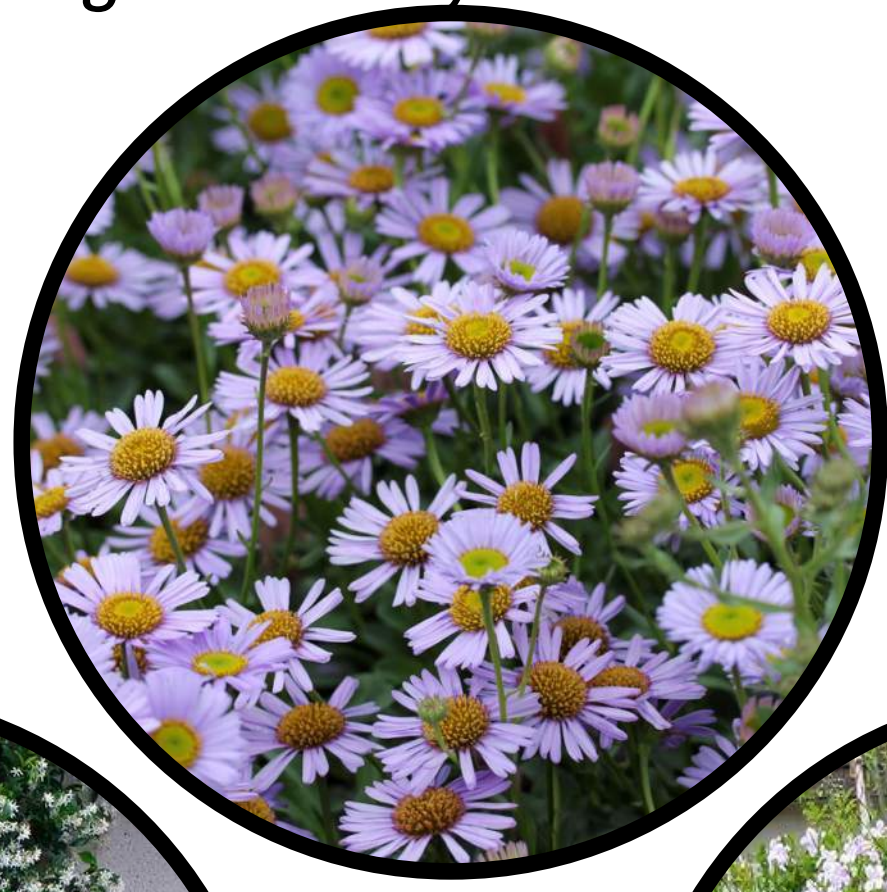

*Myoporum parvifolium*



*Sedum album*



*Sedum reflexum*



*Trachelospermum jasminoides*



*Clytostoma callistegioides*



*Macfadyena unguis-cati*



*Parthenocissus tricuspidata*



PLANT PALETTE				WUCOLS	SIZE
<b>TREES</b>					
AE	AESCULUS CALIFORNICA	CALIFORNIA BUCKEYE	VL		24" BOX
CR	CHIONANTHUS RETUSUS	CHINESE FRINGE TREE	M		24" BOX
FU	FRAXINUS URBANITE	URBANITE ASH	M		24" BOX
LI	LAGERSTOEMIA INDICA 'TUSCARORA'	CRAPE MYRTLE	M		24" BOX
OE	OLEA EUROPAEA 'MONHER'	SWAN HILL OLIVE	VL		24" BOX
QA	QUERCUS AGRIFOLIA	COAST LIVE OAK	L		24" BOX
QI	QUERCUS ILEX	HOLLY OAK	L		24" BOX
QL	QUERCUS LOBATA	VALLEY OAK	L		24" BOX
QR	QUERCUS RUGOSA	NETLEAF OAK	L		24" BOX
QS	QUERCUS SUBER	CORK OAK	L		24" BOX
TL	TRISTANIA LAURINA	WATER GUM	M		24" BOX
UP	ULMUS P. 'DRAKE'	DRAKE EVERGREEN ELM	L		24" BOX
<b>SHRUBS</b>					
	ACACIA C. 'COUSIN ITT'	COUSIN ITT ACACIA	L		5 GAL.
	AGAVE 'BLUE GLOW'	BLUE GLOW AGAVE	L		5 GAL.
	ALYOGYNE 'MOOD INDIGO'	BLUE HIBISCUS	L		5 GAL.
	ANIGOZANTHOS 'BUSH GOLD'	BUSH GOLD KANGAROO PAW	L		5 GAL.
	ARCTOSTAPHYLOS 'HOWARD MCMINN'	HOWARD MCMINN MANZANITA	L		5 GAL.
	ASPARAGUS D. MEYERS	MEYERS ASPARAGUS	L		1 GAL.
	BUXUS S. 'GREEN BEAUTY'	GREEN BEAUTY BOXWOOD	M		5 GAL.
	CALLISTEMON 'LITTLE JOHN'	LITTLE JOHN CALLISTEMON	L		5 GAL.
	DIANELLA R. 'BABY BLISS'	BABY BLISS DIANELLA	L		5 GAL.
	DIETES BICOLOR 'ORANGE DROP'	ORANGE DROP FORTNIGHT LILY	L		5 GAL.
	ELAEAGNUS P. 'SILVERBERRY'	FRUITLAND SILVERBERRY	L		5 GAL.
	HEMEROCALLIS 'HYBRIDS'	DAY LILY-VARIED COLORS	M		5 GAL.
	HETEROMELES ARBUTIFOLIA	TOYON	L		5 GAL.
	LAVANDULA X INTERMEDIA 'ALBA'	WHITE LAVENDER	L		5 GAL.
	LEUCADENDRON 'SAFARI SUNSET'	SAFARI SUNSET CONEBUSH	L		5 GAL.
	LEUCOPHYLLUM F. 'COMPACTA'	COMPACT SAGE	L		5 GAL.
	LEUCOSPERMUM 'SUNRISE'	SUNRISE PINCUSHION	L		5 GAL.
	LOROPETALUM C. 'BURGUNDY'	BURGUNDY FRINGE FLOWER	L		5 GAL.
	MIMULUS AURANTIACUS	MONKEY FLOWER-VARIED COLORS	L		5 GAL.
	NEPHROLEPIS CORDIFOLIA	SOUTHERN SWORD FERN	M		5 GAL.
	OLEA 'LITTLE OLLIE'	LITTLE OLLIE OLIVE	L		5 GAL.
	PRUNUS L. 'OTTO LUYKEN'	OTTO LUYKEN CHERRY	M		5 GAL.
	RHAMNUS 'SAN BRUNO MOUND'	COFFEEBERRY	L		5 GAL.
	RIBES SANGUINEUM	RED FLOWERING CURRENT	L		5 GAL.
	SALVIA CLEVELANDII	CLEVELAND SAGE	L		5 GAL.
	STRELITZIA REGINAE	BIRD OF PARADISE	M		5 GAL.
	VIBURNUM AWABUKI 'CHINDO'	CHINDO VIBURNUM	M		5 GAL.
	VITEX AGNUS CASTUS	CHASTE TREE	L		5 GAL.
	WOODWARDIA FIMBRIATA	GIANT CHAIN FERN	M		5 GAL.
<b>GRASSES</b>					
	CHONDROPETALUM TECTORUM	SMALL CAPE RUSH	L		5 GAL.
	JUNCUS EFFUSUS	SOFT RUSH	L		1 GAL.
	LOMANDRA L. 'BREEZE'	BREEZE BASKET GRASS	L		1 GAL.
	MUHLENBERGIA C. 'REGAL MIST'	PINK MUHLY	L		5 GAL.
<b>GROUNDCOVER</b>					
	ARCTOSTAPHYLOS 'PACIFIC MIST'	PACIFIC MIST MANZANITA	L		5 GAL.
	ERIGERON 'WAYNE RODERICK'	WAYNE RODERICK SEASIDE DAISY	L		1 GAL.
	MYOPORUM P. 'PUTAH CREEK'	CREeping MYOPORUM	L		1 GAL.
	TRACHELOSPERMUM JASMINOIDES	STAR JASMINE	M		5 GAL.
<b>VINES</b>					
	CLYTOSTOMA CALLISTEGIOIDES	LAVENDER TRUMPET VINE	M		15 GAL.
	FICUS PUMILA	CREeping FIG	M		5 GAL.
	MACFADYENA UNGUIS-CATI	CATS CLAW CREEPER	M		5 GAL.
	PARTHENOCISSUS TRICUSPIDATA	BOSTON IVY	M		5 GAL.
<b>SUCCULENTS</b>					
	ALOE PLICATILIS	ALOE	L		5 GAL.
	HESPERALOE PARVIFLORA	RED YUCCA	L		5 GAL.
	SENECIO MANDRALISCAE	BLUE CHALKSTICKS	L		5 GAL.

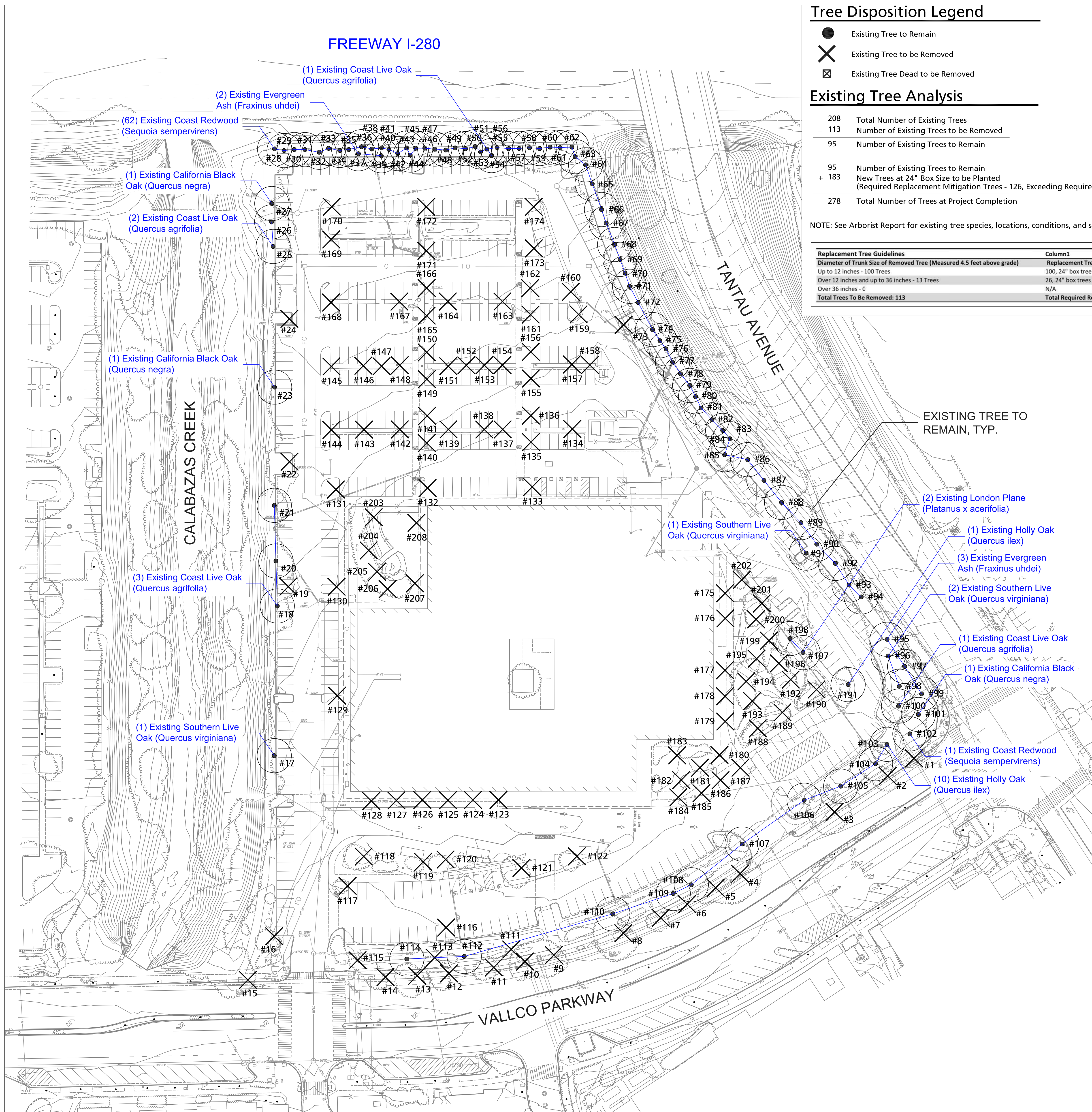

### Tree Disposition Legend

- Existing Tree to Remain
- ✕ Existing Tree to be Removed
- ☐ Existing Tree Dead to be Removed

### Existing Tree Analysis

208	Total Number of Existing Trees
- 113	Number of Existing Trees to be Removed
95	Number of Existing Trees to Remain
95	Number of Existing Trees to Remain
+ 183	New Trees at 24" Box Size to be Planted (Required Replacement Mitigation Trees - 126, Exceeding Requirement by 57 Trees)
278	Total Number of Trees at Project Completion

NOTE: See Arborist Report for existing tree species, locations, conditions, and sizes

Replacement Tree Guidelines	Column1	Column2
Diameter of Trunk Size of Removed Tree (Measured 4.5 feet above grade)	Replacement Trees Required	Replacement Trees Provided
Up to 12 inches - 100 Trees	100, 24" box trees	
Over 12 inches and up to 36 inches - 13 Trees	26, 24" box trees OR 13, 36" box trees	183, 24" box trees
Over 36 inches - 0	N/A	
<b>Total Trees To Be Removed: 113</b>	<b>Total Required Replacement Trees: 126, 24" box trees</b>	<b>Total: 183 Trees (70 Net Positive Trees)</b>

### TREE REPLACEMENT PLAN

NO.	TREE #	DBH	REPLACEMENT TREES		REQUIRED QUANTITY	SIZE
			TREE	TREE		
1	1	X	Fraxinus urbanite	Urbanite Ash	2	24" box
2	2	X	Fraxinus urbanite	Urbanite Ash	2	24" box
3	3	X	Fraxinus urbanite	Urbanite Ash	2	24" box
4	4	X	Fraxinus urbanite	Urbanite Ash	2	24" box
5	5	X	Fraxinus urbanite	Urbanite Ash	1	24" box
6	6	X	Fraxinus urbanite	Urbanite Ash	1	24" box
7	7	X	Fraxinus urbanite	Urbanite Ash	2	24" box
8	8	X	Fraxinus urbanite	Urbanite Ash	2	24" box
9	9	X	Fraxinus urbanite	Urbanite Ash	2	24" box
10	10	X	Fraxinus urbanite	Urbanite Ash	2	24" box
11	11	X	Fraxinus urbanite	Urbanite Ash	2	24" box
12	12	X	Fraxinus urbanite	Urbanite Ash	2	24" box
13	13	X	Fraxinus urbanite	Urbanite Ash	2	24" box
14	14	X	Fraxinus urbanite	Urbanite Ash	1	24" box
15	15	X	Fraxinus urbanite	Urbanite Ash	2	24" box
16	16	X	Quercus agrifolia	Coast Live Oak	1	24" box
17	19	X	Quercus lobata	Valley Oak	1	24" box
18	22	X	Aesculus californica	California Buckeye	1	24" box
19	24	X	Aesculus californica	California Buckeye	1	24" box
20	73	X	Quercus rugosa	Netleaf Oak	1	24" box
21	111	X	Quercus ilex	Holly Oak	1	24" box
22	113	X	Quercus ilex	Holly Oak	1	24" box
23	115	X	Quercus ilex	Holly Oak	1	24" box
24	116	X	Quercus ilex	Holly Oak	1	24" box
25	117	X	Olea europaea 'Monher'	Swan Hill Olive	1	24" box
26	118	X	Olea europaea 'Monher'	Swan Hill Olive	1	24" box
27	119	X	Olea europaea 'Monher'	Swan Hill Olive	1	24" box
28	120	X	Olea europaea 'Monher'	Swan Hill Olive	1	24" box
29	121	X	Olea europaea 'Monher'	Swan Hill Olive	2	24" box
30	122	X	Olea europaea 'Monher'	Swan Hill Olive	1	24" box
31	123	X	Tristania laurina	Water gum	1	24" box
32	124	X	Tristania laurina	Water gum	1	24" box
33	125	X	Tristania laurina	Water gum	1	24" box
34	126	X	Tristania laurina	Water gum	1	24" box
35	127	X	Tristania laurina	Water gum	1	24" box
36	128	X	Tristania laurina	Water gum	1	24" box
37	129	X	Ulmus Parvifolia 'Drake'	Drake Evergreen Elm	1	24" box
38	130	X	Ulmus Parvifolia 'Drake'	Drake Evergreen Elm	1	24" box
39	131	X	Ulmus Parvifolia 'Drake'	Drake Evergreen Elm	1	24" box
40	132	X	Ulmus Parvifolia 'Drake'	Drake Evergreen Elm	1	24" box
41	133	X	Quercus agrifolia	Coast Live Oak	1	24" box
42	134	X	Ulmus Parvifolia 'Drake'	Drake Evergreen Elm	1	24" box
43	135	X	Cercis canadensis var. texensis 'Oklahoma'	Oklahoma Redbud	1	24" box
44	136	X	Cercis canadensis var. texensis 'Oklahoma'	Oklahoma Redbud	1	24" box
45	137	X	Cercis canadensis var. texensis 'Oklahoma'	Oklahoma Redbud	1	24" box
46	138	X	Cercis canadensis var. texensis 'Oklahoma'	Oklahoma Redbud	1	24" box
47	139	X	Cercis canadensis var. texensis 'Oklahoma'	Oklahoma Redbud	1	24" box
48	140	X	Cercis canadensis var. texensis 'Oklahoma'	Oklahoma Redbud	1	24" box
49	141	X	Cercis canadensis var. texensis 'Oklahoma'	Oklahoma Redbud	1	24" box
50	142	X	Cercis canadensis var. texensis 'Oklahoma'	Oklahoma Redbud	1	24" box
51	143	X	Cercis canadensis var. texensis 'Oklahoma'	Oklahoma Redbud	1	24" box
52	144	X	Cercis canadensis var. texensis 'Oklahoma'	Oklahoma Redbud	1	24" box
53	145	X	Cercis canadensis var. texensis 'Oklahoma'	Oklahoma Redbud	1	24" box
54	146	X	Cercis canadensis var. texensis 'Oklahoma'	Oklahoma Redbud	1	24" box
55	147	X	Cercis canadensis var. texensis 'Oklahoma'	Oklahoma Redbud	1	24" box
56	148	X	Cercis canadensis var. texensis 'Oklahoma'	Oklahoma Redbud	1	24" box
57	149	X	Cercis canadensis var. texensis 'Oklahoma'	Oklahoma Redbud	1	24" box
58	150	X	Cercis canadensis var. texensis 'Oklahoma'	Oklahoma Redbud	1	24" box
59	151	X	Cercis canadensis var. texensis 'Oklahoma'	Oklahoma Redbud	1	24" box
60	152	X	Cercis canadensis var. texensis 'Oklahoma'	Oklahoma Redbud	1	24" box
61	153	X	Cercis canadensis var. texensis 'Oklahoma'	Oklahoma Redbud	1	24" box
62	154	X	Cercis canadensis var. texensis 'Oklahoma'	Oklahoma Redbud	1	24" box
63	155	X	Cercis canadensis var. texensis 'Oklahoma'	Oklahoma Redbud	1	24" box
64	156	X	Cercis canadensis var. texensis 'Oklahoma'	Oklahoma Redbud	1	24" box
65	157	X	Cercis canadensis var. texensis 'Oklahoma'	Oklahoma Redbud	1	24" box
66	158	X	Cercis canadensis var. texensis 'Oklahoma'	Oklahoma Redbud	1	24" box
67	159	X	Quercus rugosa	Netleaf Oak	1	24" box
68	160	X	Ulmus Parvifolia 'Drake'	Drake Evergreen Elm	1	24" box
69	161	X	Quercus rugosa	Netleaf Oak	1	24" box
70	162	X	Ulmus Parvifolia 'Drake'	Drake Evergreen Elm	1	24" box
71	163	X	Quercus rugosa	Netleaf Oak	1	24" box
72	164	X	Quercus rugosa	Netleaf Oak	1	24" box
73	165	X	Ulmus Parvifolia 'Drake'	Drake Evergreen Elm	1	24" box
74	166	X	Quercus rugosa	Netleaf Oak	1	24" box
75	167	X	Ulmus Parvifolia 'Drake'	Drake Evergreen Elm	1	24" box
76	168	X	Quercus rugosa	Netleaf Oak	1	24" box
77	169	X	Ulmus Parvifolia 'Drake'	Drake Evergreen Elm	1	24" box
78	170	X	Ulmus Parvifolia 'Drake'	Drake Evergreen Elm	1	24" box
79	171	X	Ulmus Parvifolia 'Drake'	Drake Evergreen Elm	1	24" box
80	172	X	Ulmus Parvifolia 'Drake'	Drake Evergreen Elm	1	24" box
81	173	X	Ulmus Parvifolia 'Drake'	Drake Evergreen Elm	1	24" box
82	174	X	Ulmus Parvifolia 'Drake'	Drake Evergreen Elm	1	24" box
83	175	X	Quercus suber	Cork Oak	1	24" box
84	176	X	Quercus suber	Cork Oak	1	24" box
85	177	X	Quercus suber	Cork Oak	1	24" box
86	178	X	Quercus suber	Cork Oak	1	24" box
87	179	X	Quercus suber	Cork Oak	1	24" box
88	180	X	Quercus suber	Cork Oak	1	24" box
89	181	X	Quercus suber	Cork Oak	1	24" box
90	182	X	Quercus suber	Cork Oak	1	24" box
91	183	X	Lagerstroemia Indica 'Tuscarora'	Crape Myrtle	1	24" box
92	184	X	Ulmus Parvifolia 'Drake'	Drake Evergreen Elm	1	24" box
93	185	X	Ulmus Parvifolia 'Drake'	Drake Evergreen Elm	1	24" box
94	186	X	Ulmus Parvifolia 'Drake'	Drake Evergreen Elm	1	24" box
95	187	X	Ulmus Parvifolia 'Drake'	Drake Evergreen Elm	1	24" box
96	188	X	Ulmus Parvifolia 'Drake'	Drake Evergreen Elm	1	24" box
97	189	X	Ulmus Parvifolia 'Drake'	Drake Evergreen Elm	1	24" box
98	190	X	Ulmus Parvifolia 'Drake'	Drake Evergreen Elm	1	24" box
99	192	X	Ulmus Parvifolia 'Drake'	Drake Evergreen Elm	1	24" box
100	193	X	Quercus suber	Cork Oak	1	24" box
101	194	X	Quercus suber	Cork Oak	1	24" box
102	195	X	Quercus suber	Cork Oak	1	24" box
103	196	X	Quercus suber	Cork Oak	1	24" box
104	199	X	Quercus suber	Cork Oak	1	24" box
105	200	X	Quercus suber	Cork Oak	1	24" box
106	201	X	Cercis canadensis var. texensis 'Oklahoma'	Oklahoma Redbud	1	24" box
107	202	X	Cercis canadensis var. texensis 'Oklahoma'	Oklahoma Redbud	1	24" box
108	203	X	Tristania laurina	Water gum	1	24" box
109	204	X	Tristania laurina	Water gum	1	24" box
110	205	X	Quercus ilex	Holly Oak	1	24" box
111	206	X	Cercis canadensis var. texensis 'Oklahoma'	Oklahoma Redbud	1	24" box
112	207	X	Cercis canadensis var. texensis 'Oklahoma'	Oklahoma Redbud	1	24" box
113	208	X	Cercis canadensis var. texensis 'Oklahoma'	Oklahoma Redbud	1	24" box
<b>TOTAL</b>	<b>100</b>	<b>13</b>	<b>0</b>	<b>126</b>	<b>24" box</b>	

\*See L02.0 and L02.1 Planting Plans for Replacement Tree Mitigation Specifications

## L06.0 - Tree Disposition Plan

Apple, Inc.

05.23.2022 Scale: 1" = 40'-0"



COPYRIGHT © 2020 BY STUDIOS ARCHITECTURE