

LEGEND

- 1 STRAW WATTLE SEDIMENT TRAP/FILTER
- 2 CATCH BASIN SEDIMENT BARRIER
- 3 STABILIZED CONSTRUCTION ENTRANCE

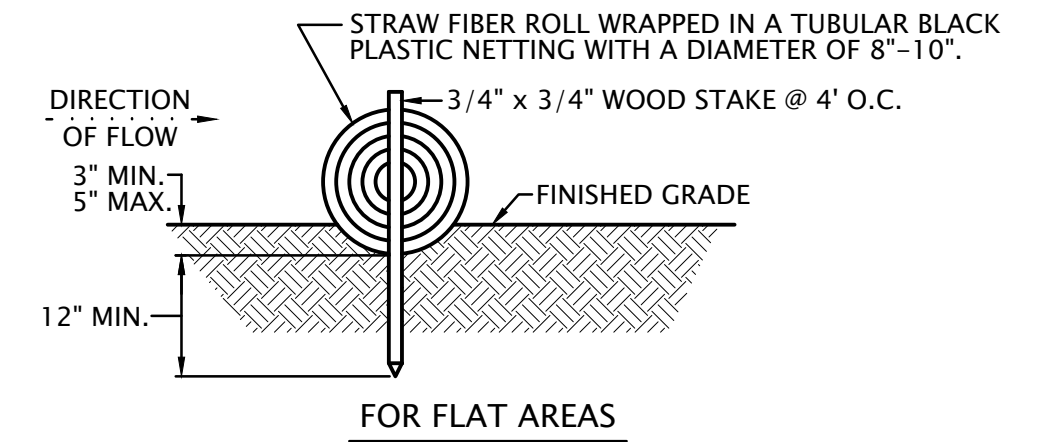

NOTES:

- FIBER ROLL COMPOSED OF BIO-DEGRADABLE FIBERS STUFFED INTO A PHOTO-DEGRADABLE OPEN WEAVE NETTING.
- FIBER ROLL EROSION BARRIER TRAPS SEDIMENT AND REDUCES SHEET AND HILL SIDE EROSION BY REDUCING SLOPE GRADIENT, IT INCREASING INFILTRATION RATES AND BY PRODUCING A FAVORABLE ENVIRONMENT FOR PLANT ESTABLISHMENT.
- FIBER ROLL INSTALLATION REQUIRES THE PLACEMENT AND SECURE STAKING OF THE FIBER ROLL IN A TRENCH 3"-5" DEEP, DUG ON CONTOUR. RUNOFF MUST NOT BE ALLOWED TO RUN UNDER OR AROUND FIBER ROLL.

STRAW WATTLE  
NOT TO SCALE

1

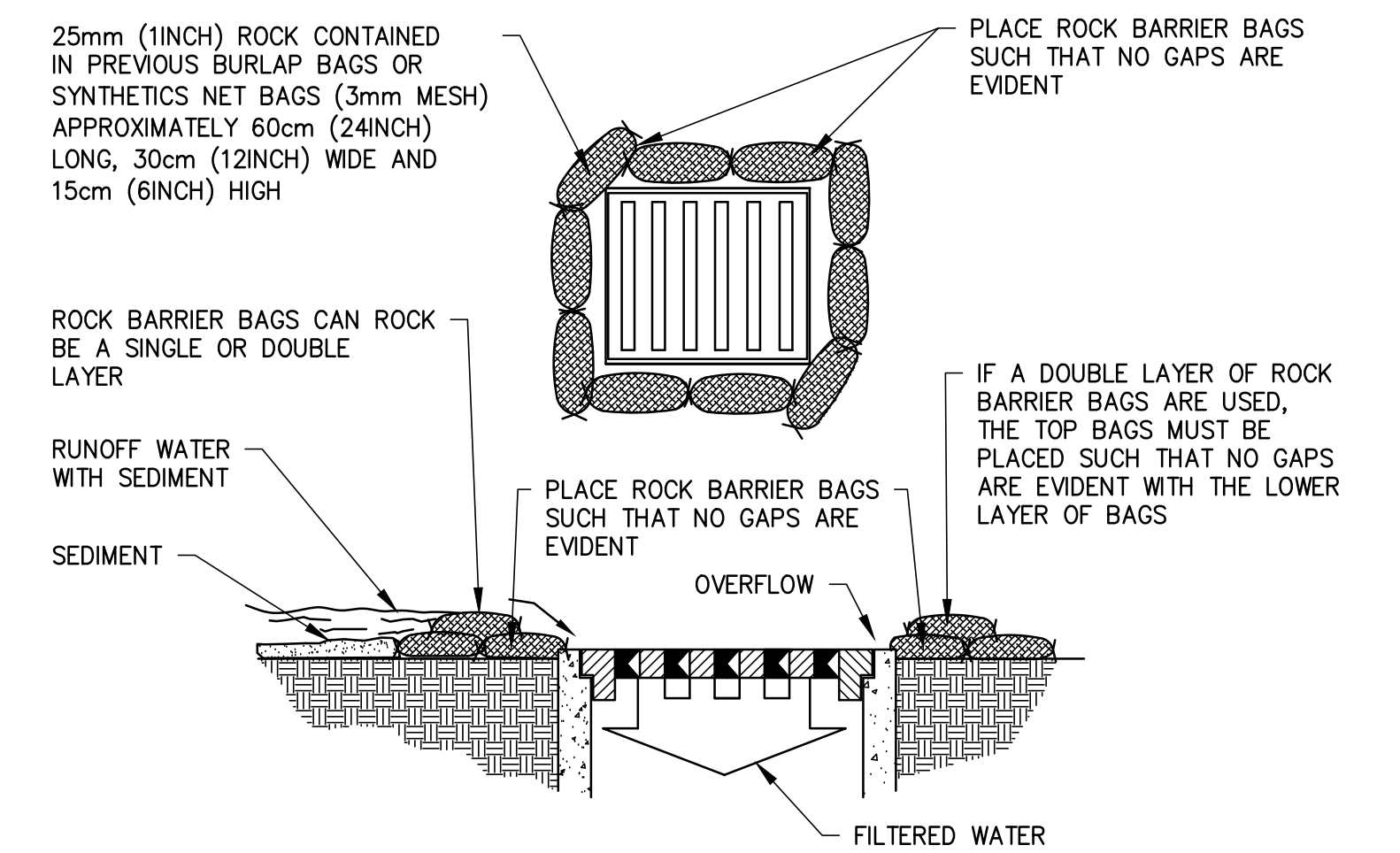

CATCH BASIN SEDIMENT BARRIER  
NOT TO SCALE

2

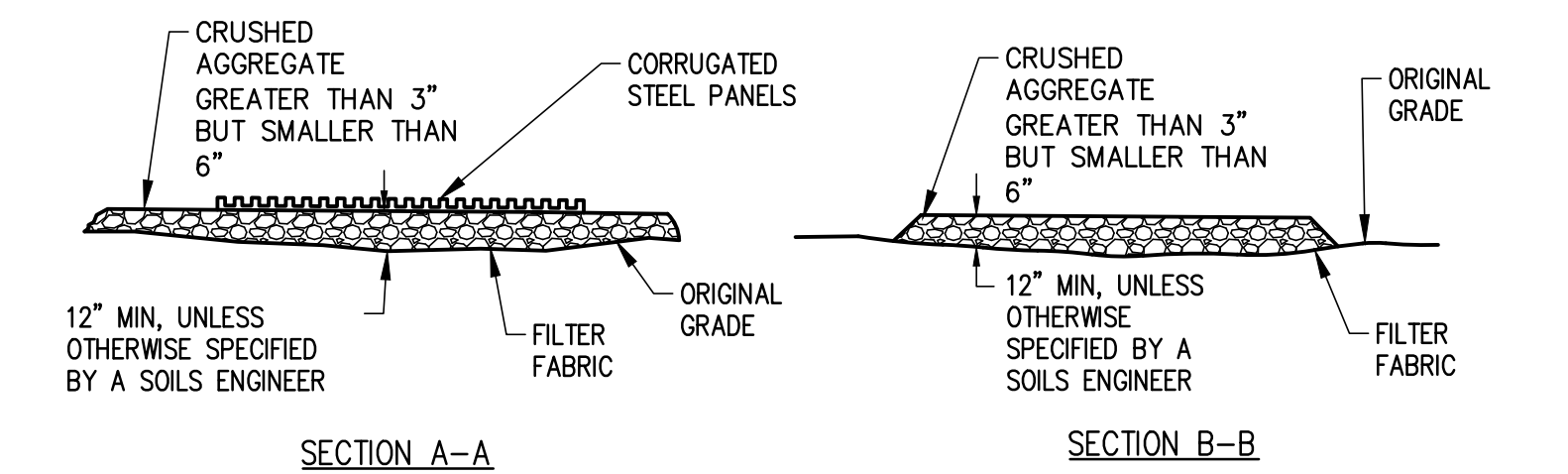

NOTE:  
MANY DESIGNS CAN BE FIELD FABRICATED, OR FABRICATED UNITS MAY BE USED.

STABILIZED CONSTRUCTION ENTRANCE  
NOT TO SCALE

3

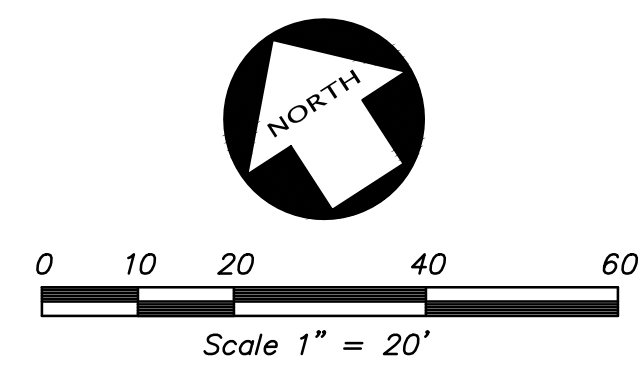

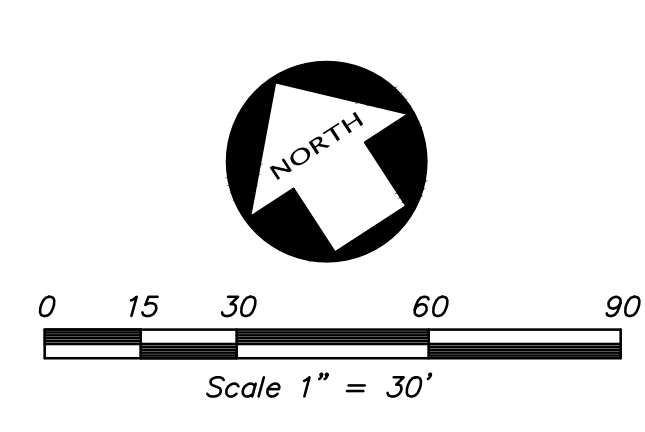
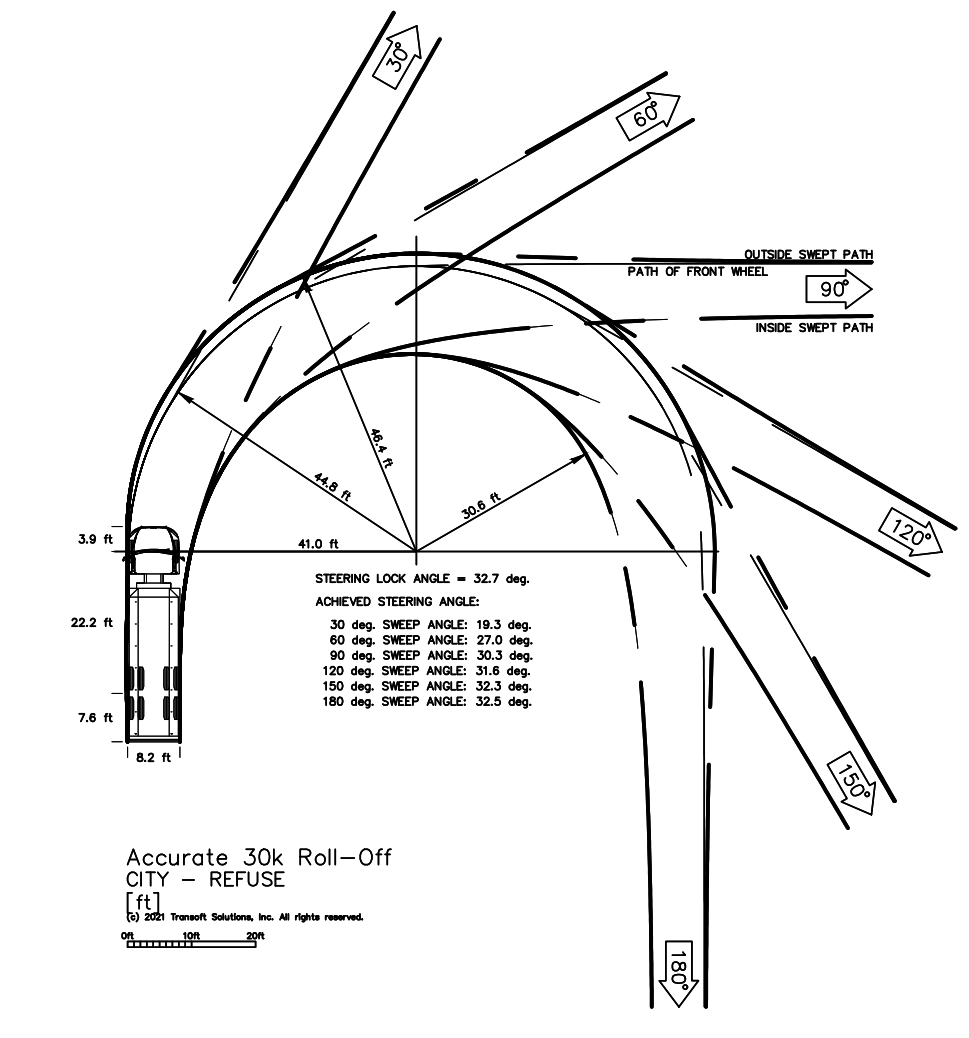
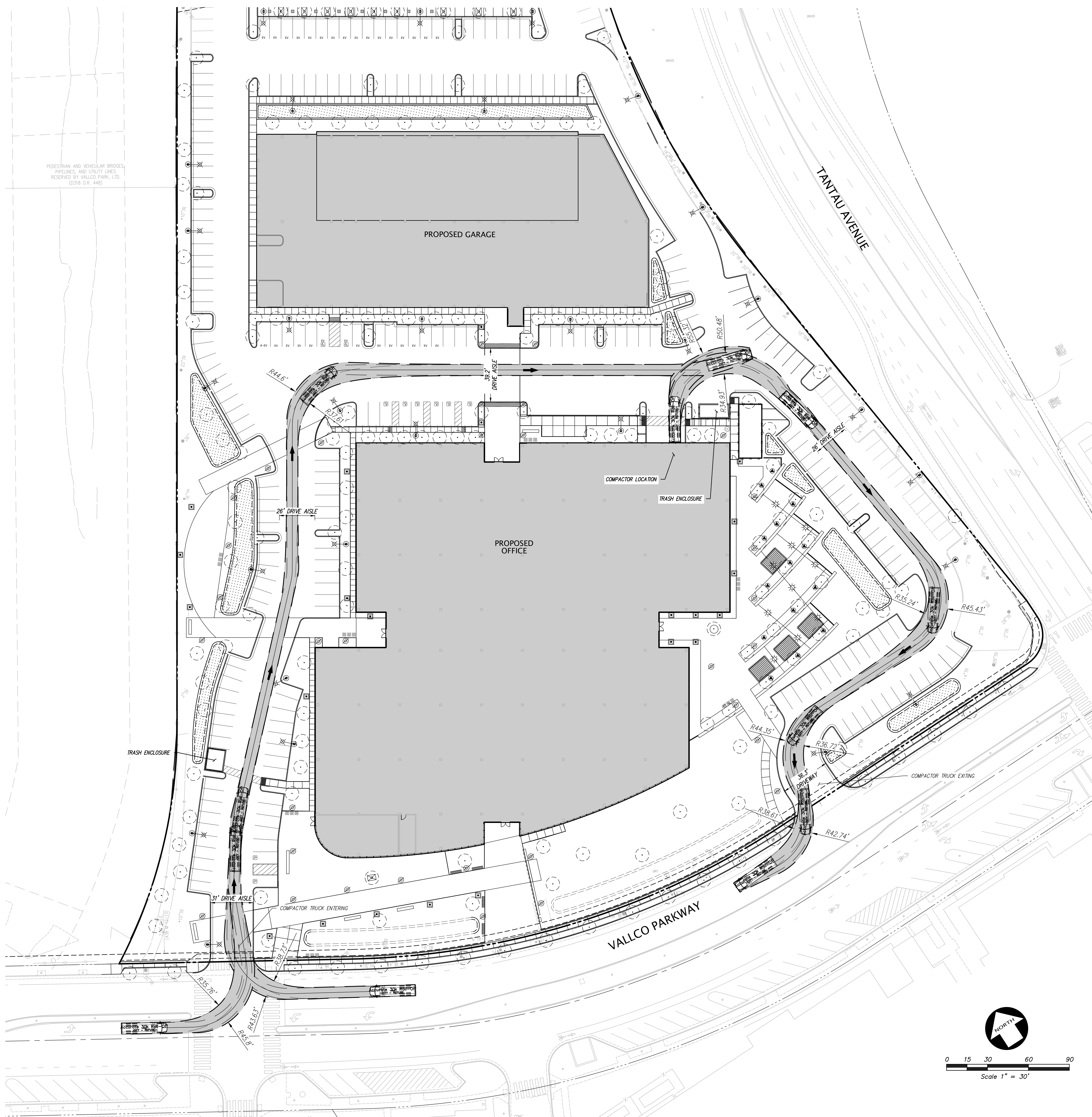

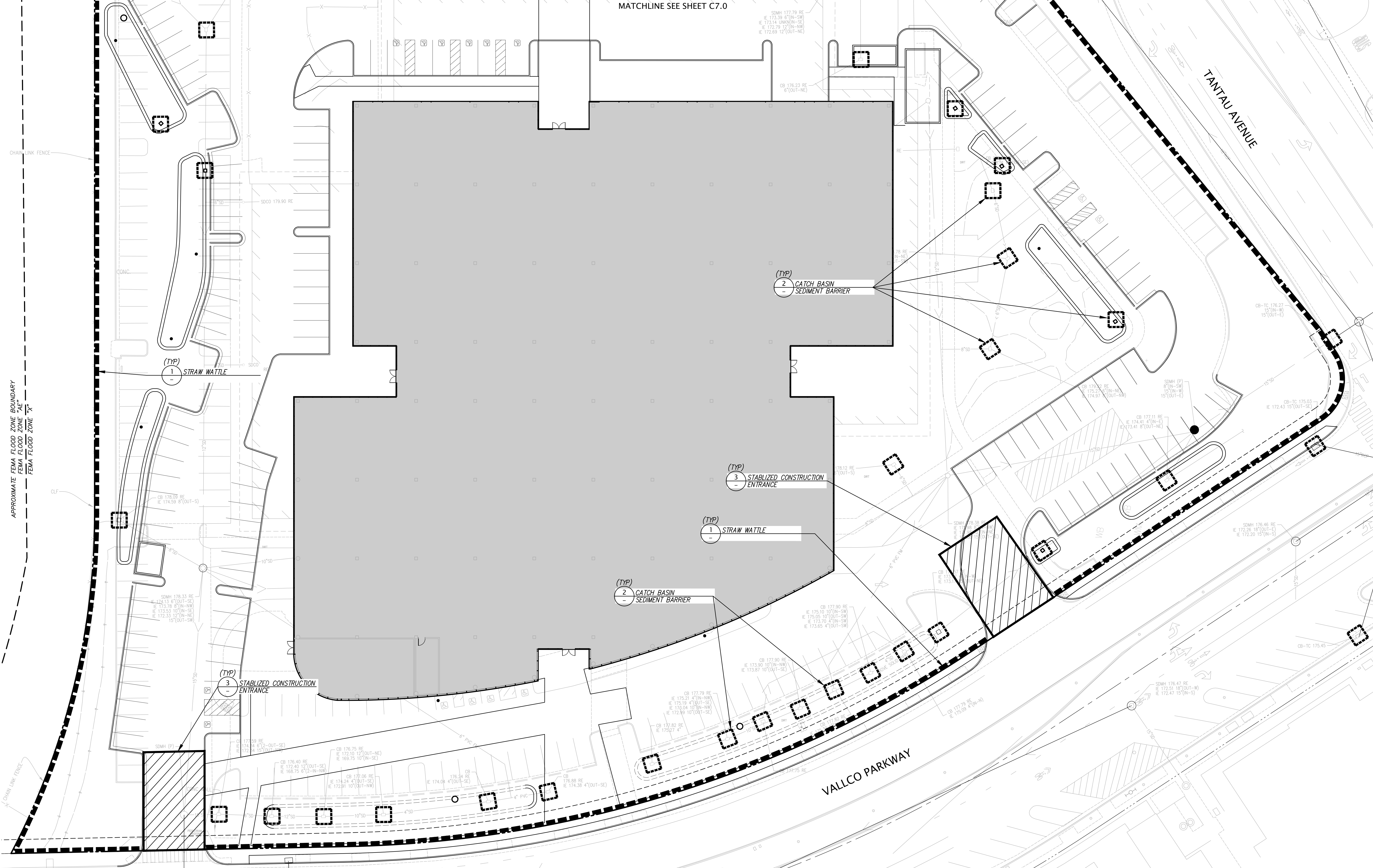

MATCHLINE SEE SHEET C7.0

APPROXIMATE FEMA FLOOD ZONE BOUNDARY  
 FEMA FLOOD ZONE 100  
 FEMA FLOOD ZONE X

TANTAU AVENUE

VALLCO PARKWAY



0 10 20 40 60  
 Scale 1" = 20'

PEDESTRIAN AND VEHICULAR BRIDGES, PIPELINES, AND UTILITY LINES RESERVED BY VALCO PARK, LTD. (318 G.R. 448)

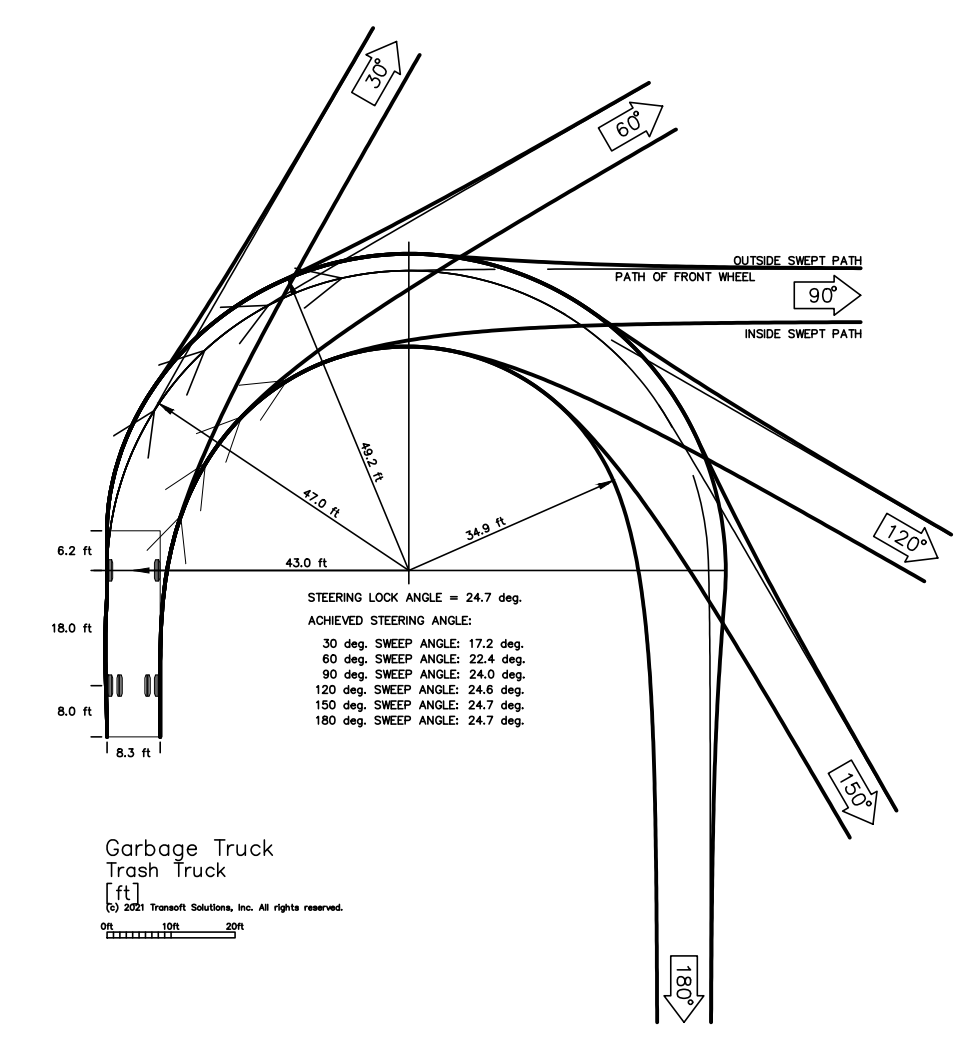
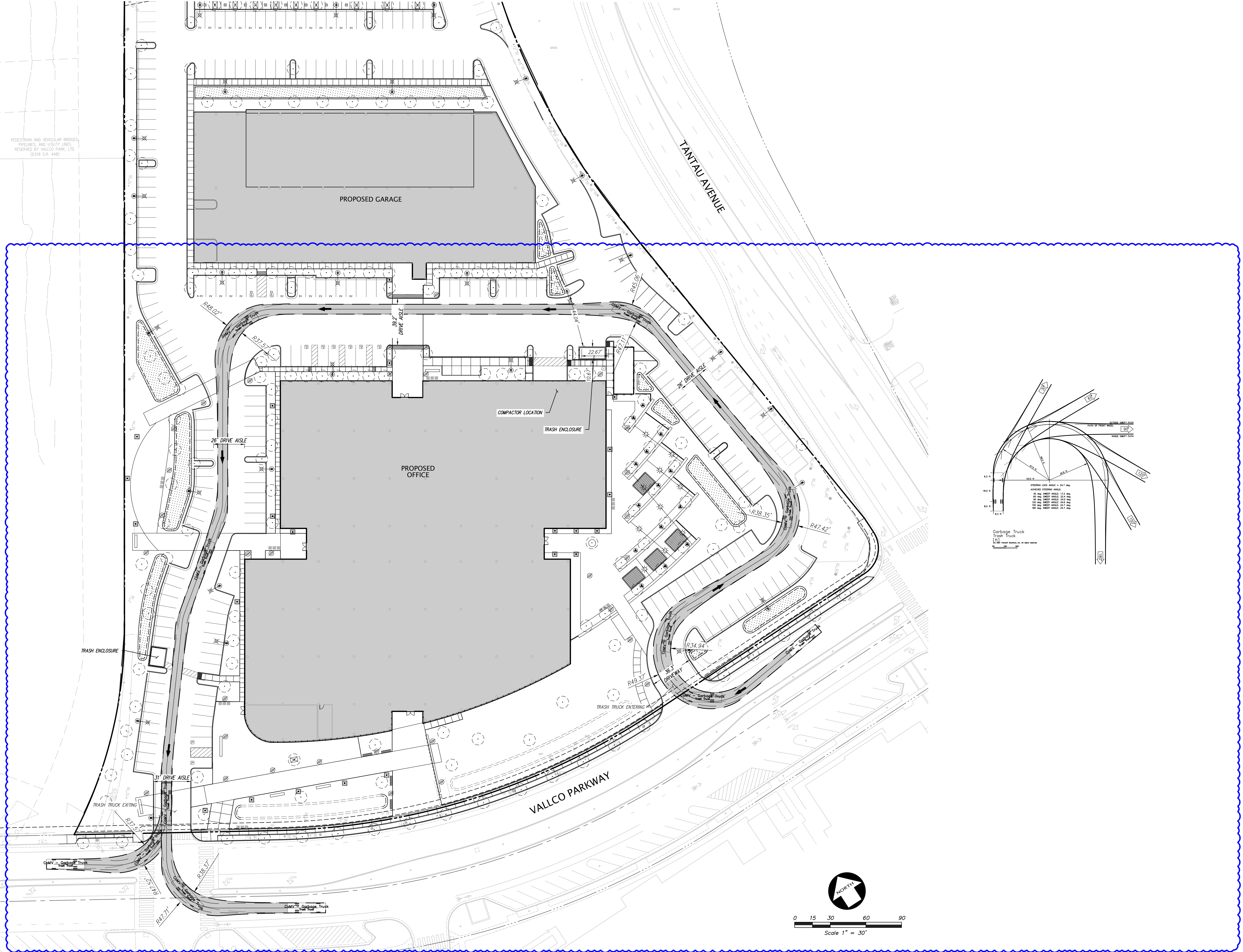

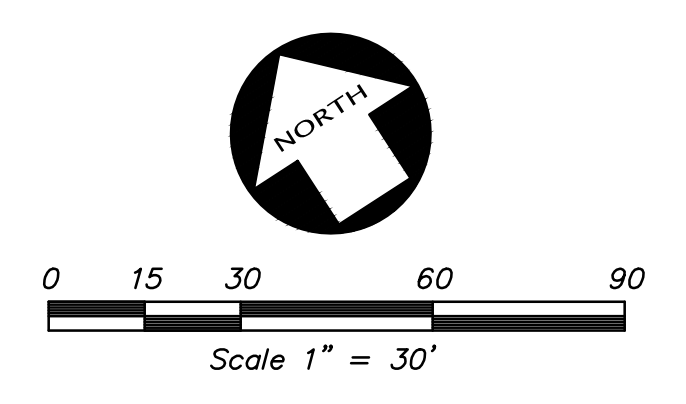
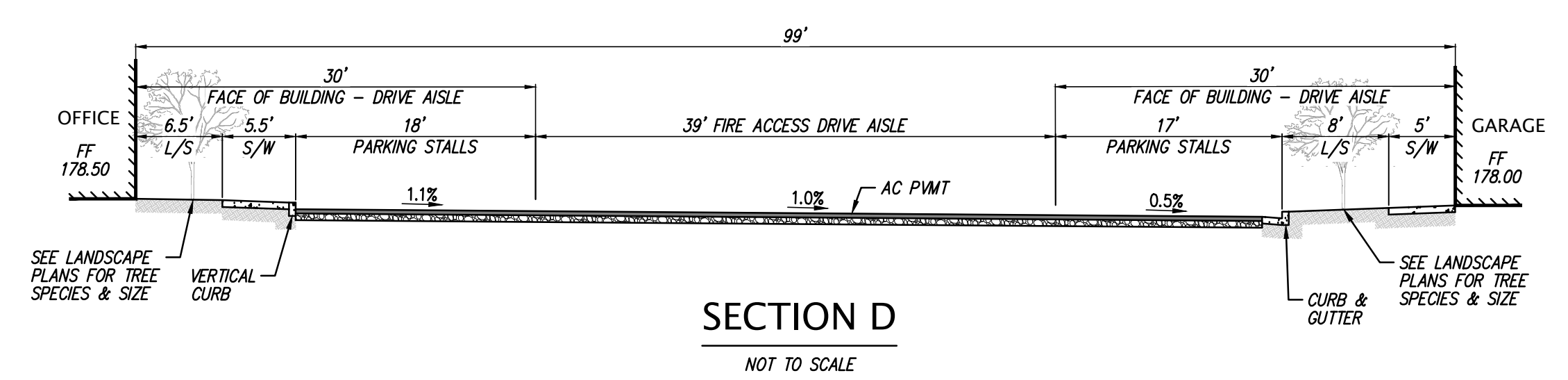
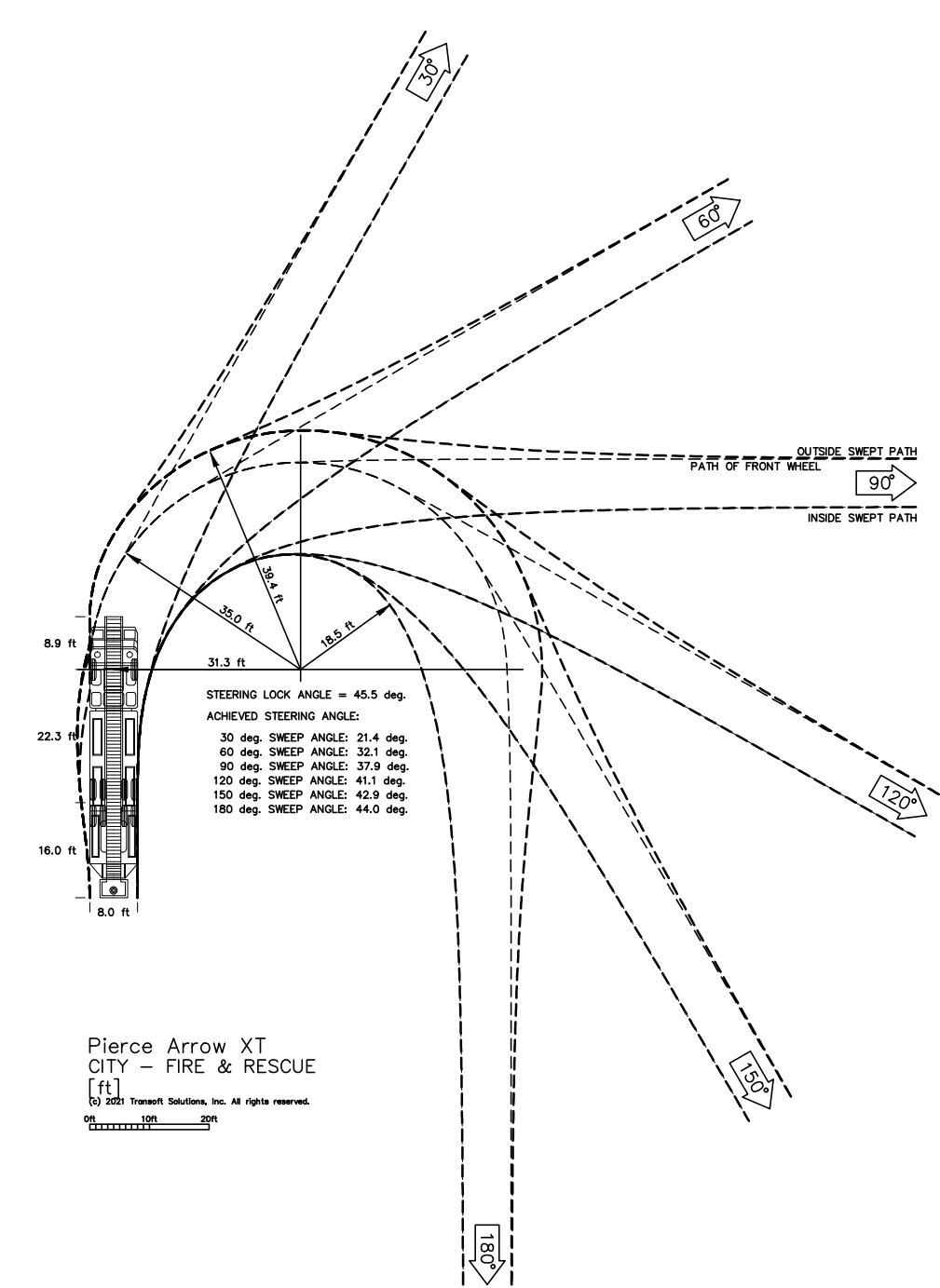
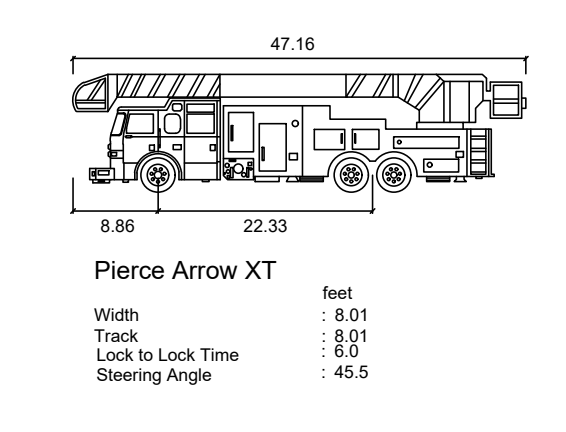
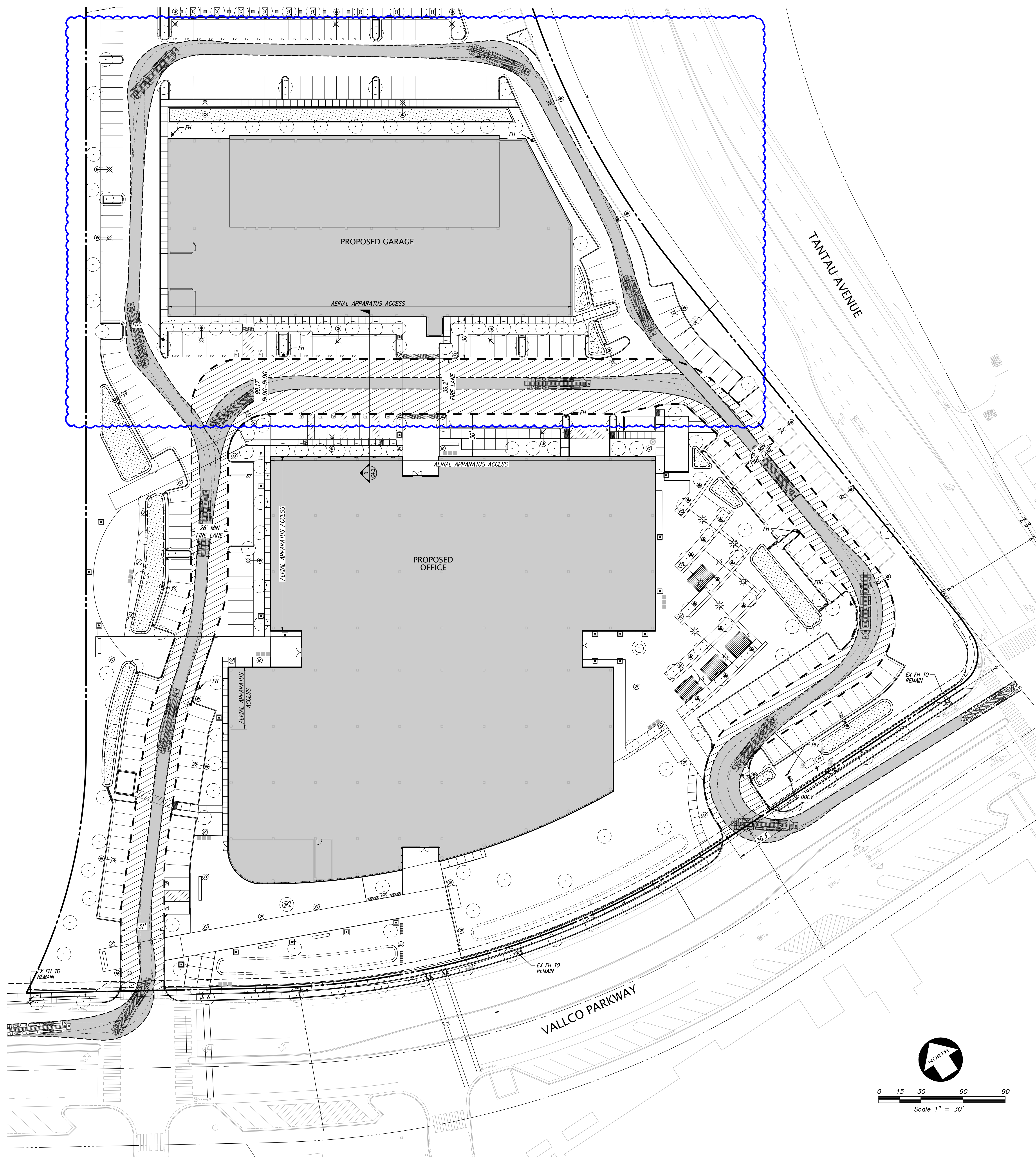

LEGEND

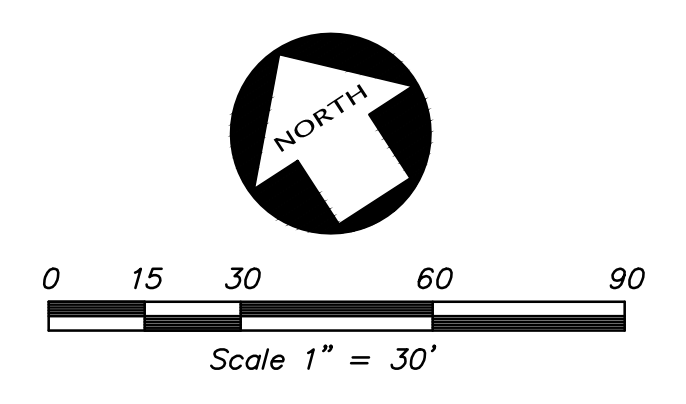
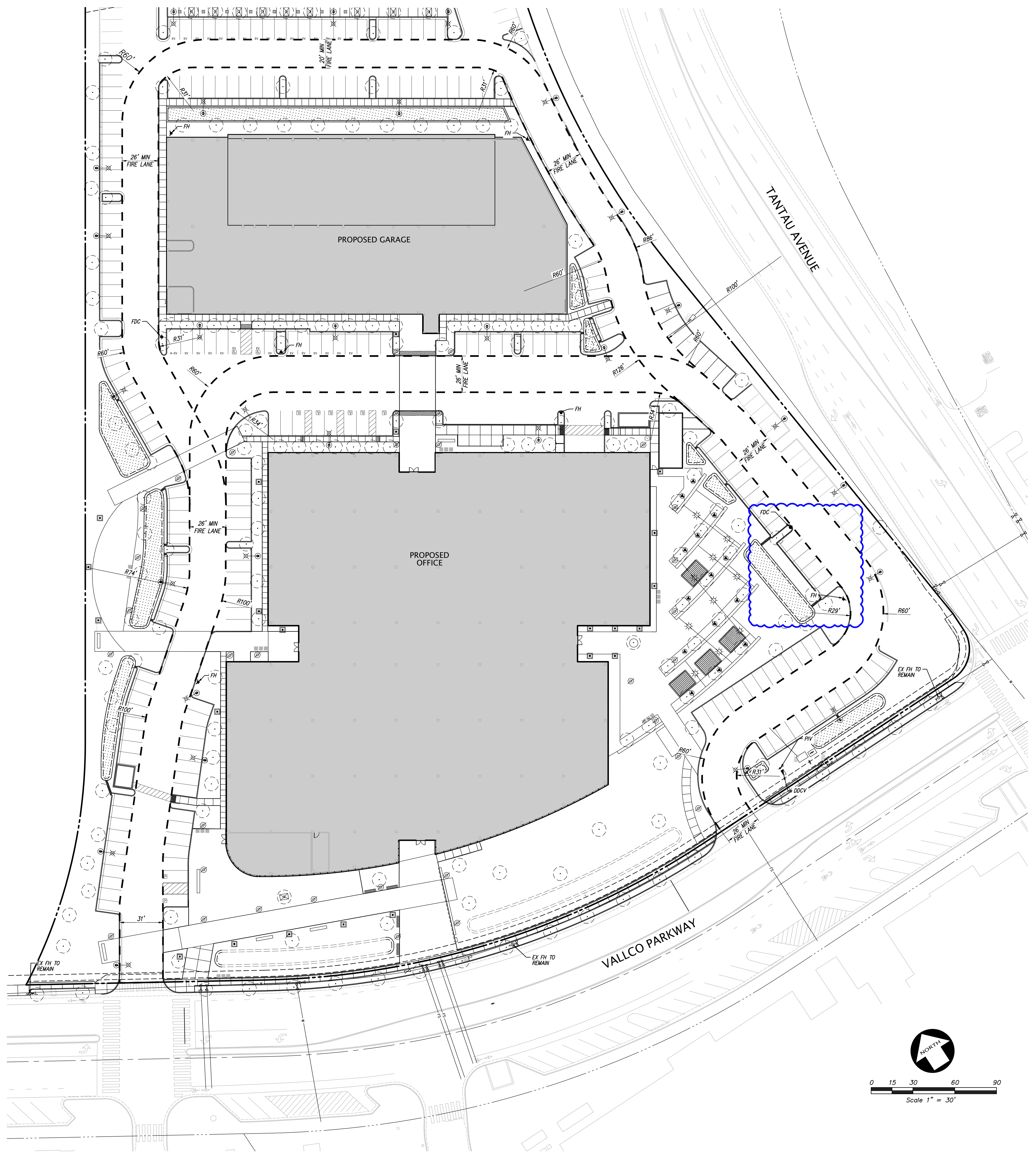

**FIRE ACCESS PLAN**  
**Apple, Inc.**

05.23.2022

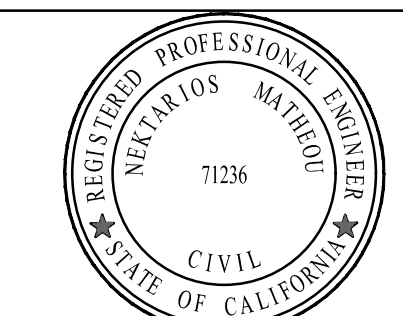

**C7.6**  **KIER+WRIGHT**

3330 Scott Boulevard, Building 22 Phone: (408) 727-6665  
Santa Clara, California 95054 www.kierwright.com

PEDESTRIAN AND VEHICULAR BRIDGES,  
PIPELINES, AND UTILITY LINES  
RESERVED BY VALCO PARK, LTD.  
(318 O.R. 448)

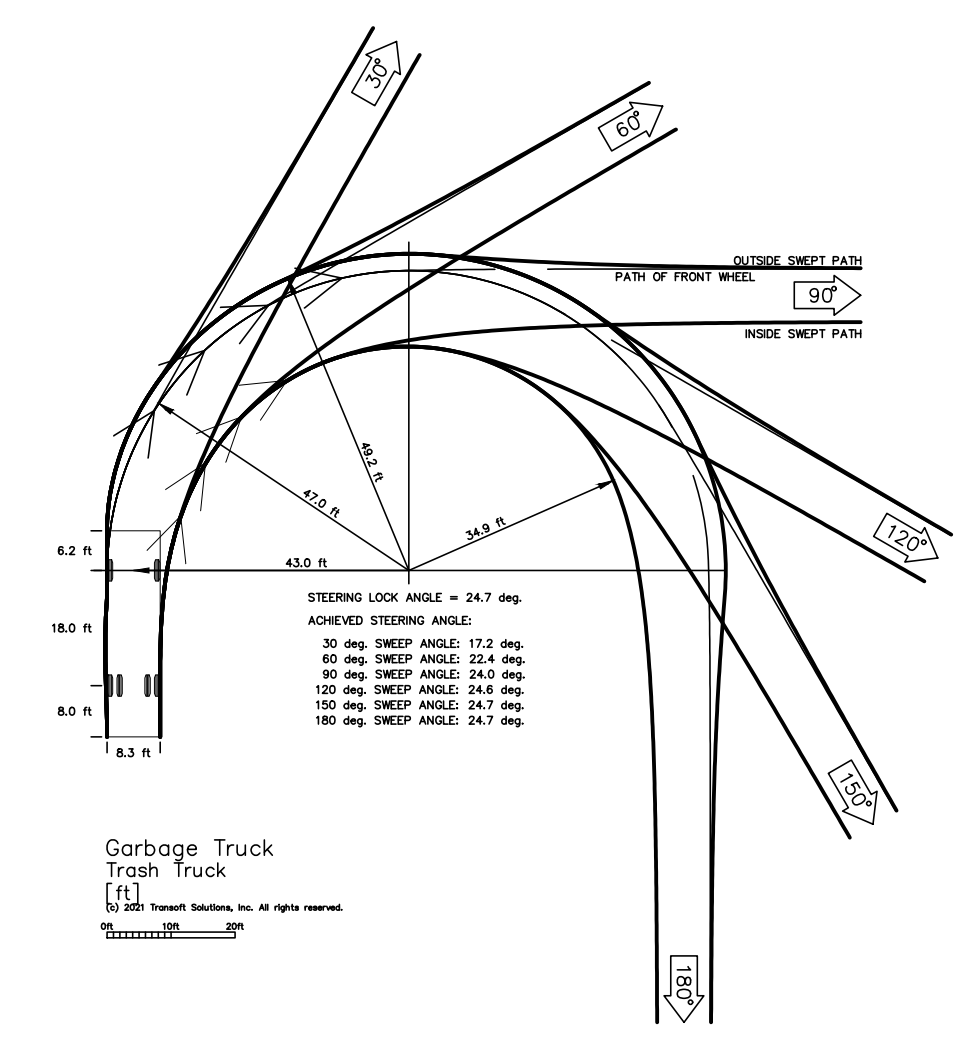
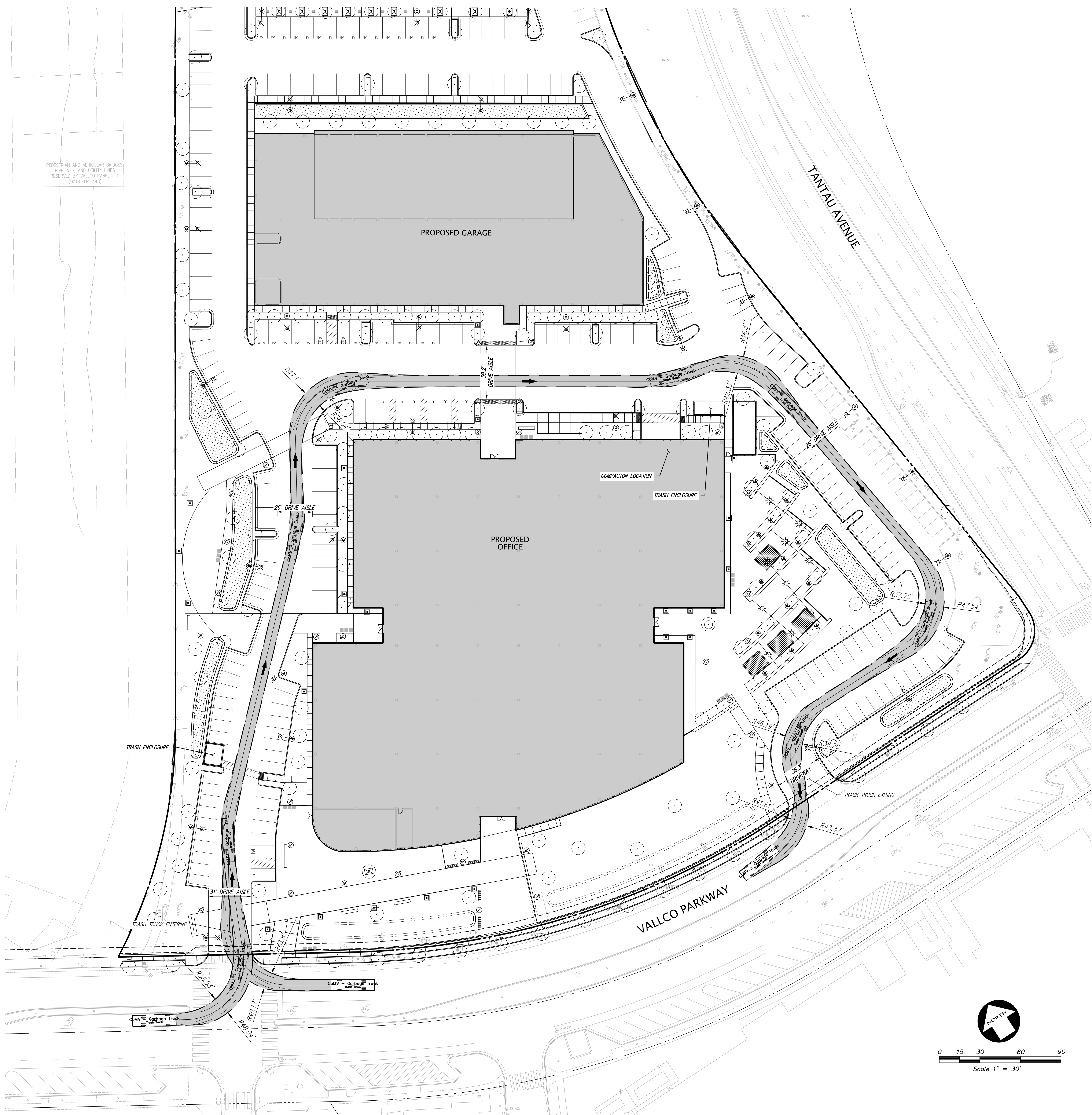



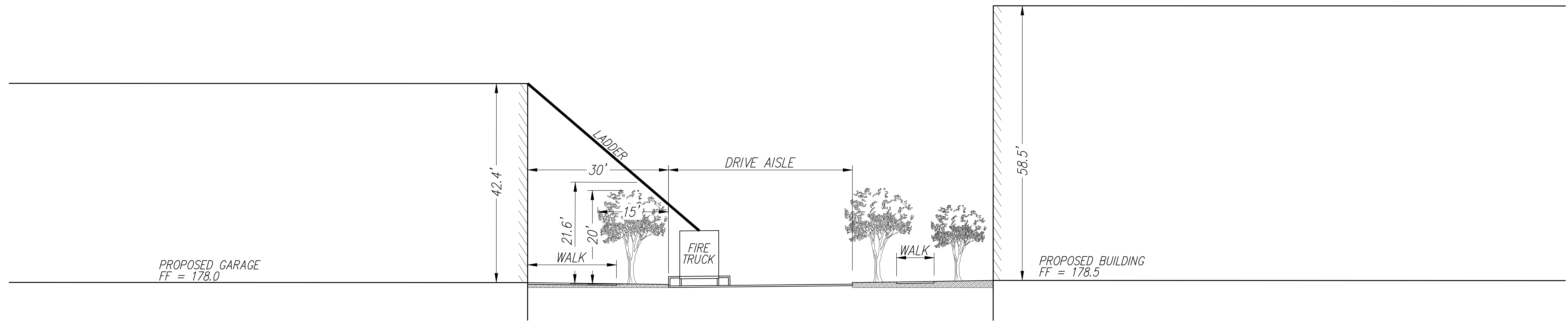

SECTION A-A  
1"=10"

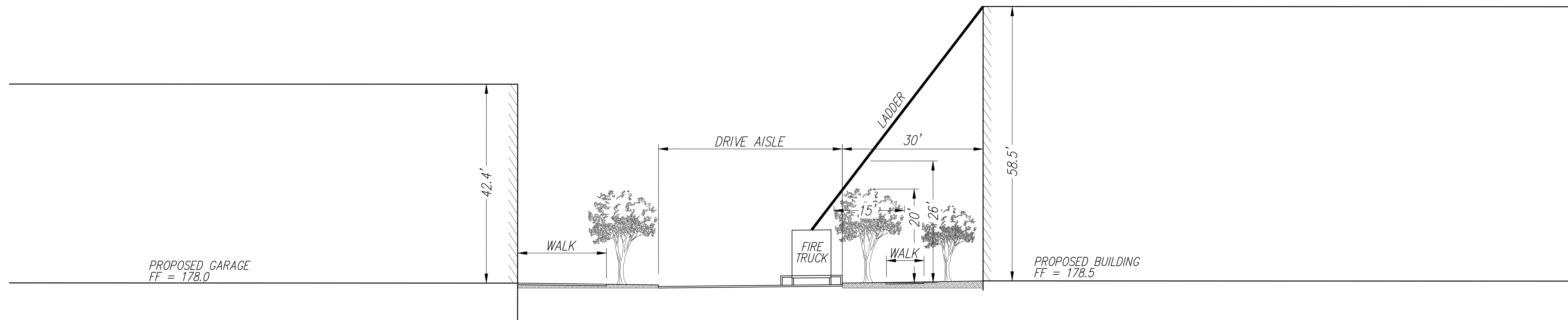

SECTION A-A  
1"=10"

NOTES

1. TREES SHALL BE 20' IN HEIGHT AND 15' IN DIAMETER AT MATURITY
2. TREES SHALL BE PRUNED TO MAINTAIN MINIMUM VERTICAL CLEARANCE OF 13' ABOVE THE DRIVE AISLE

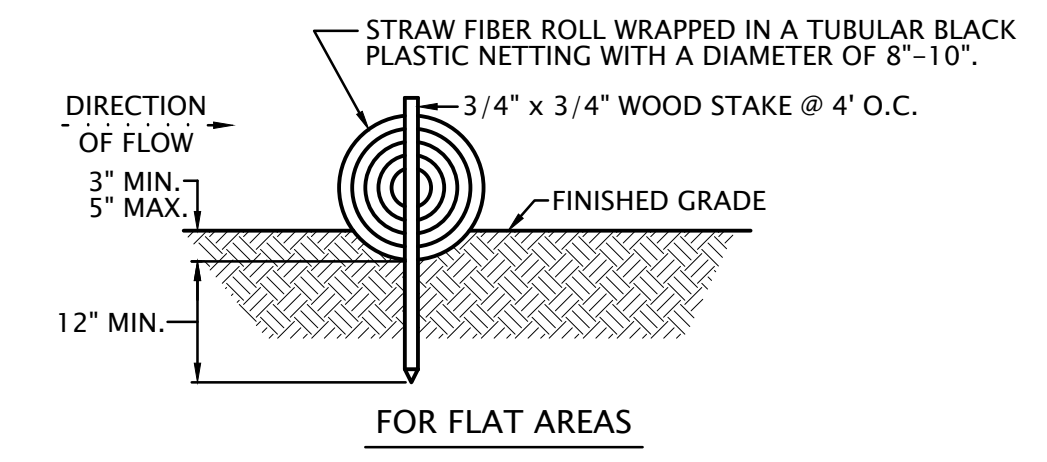
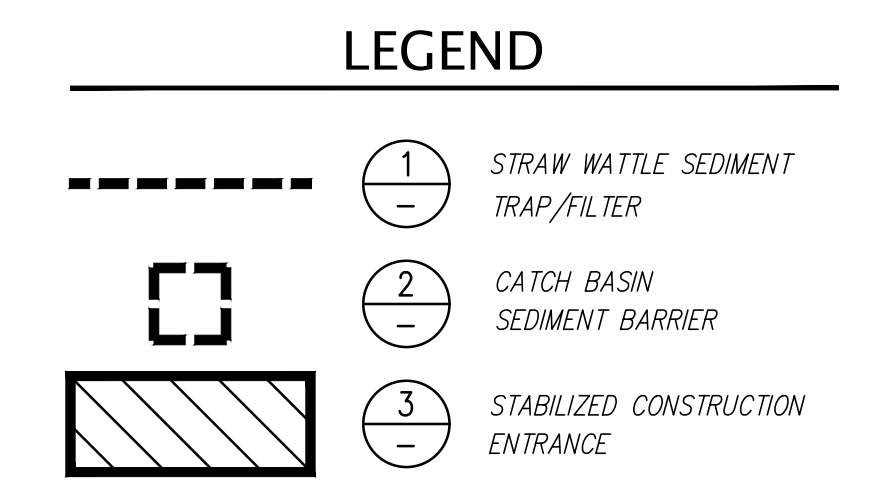
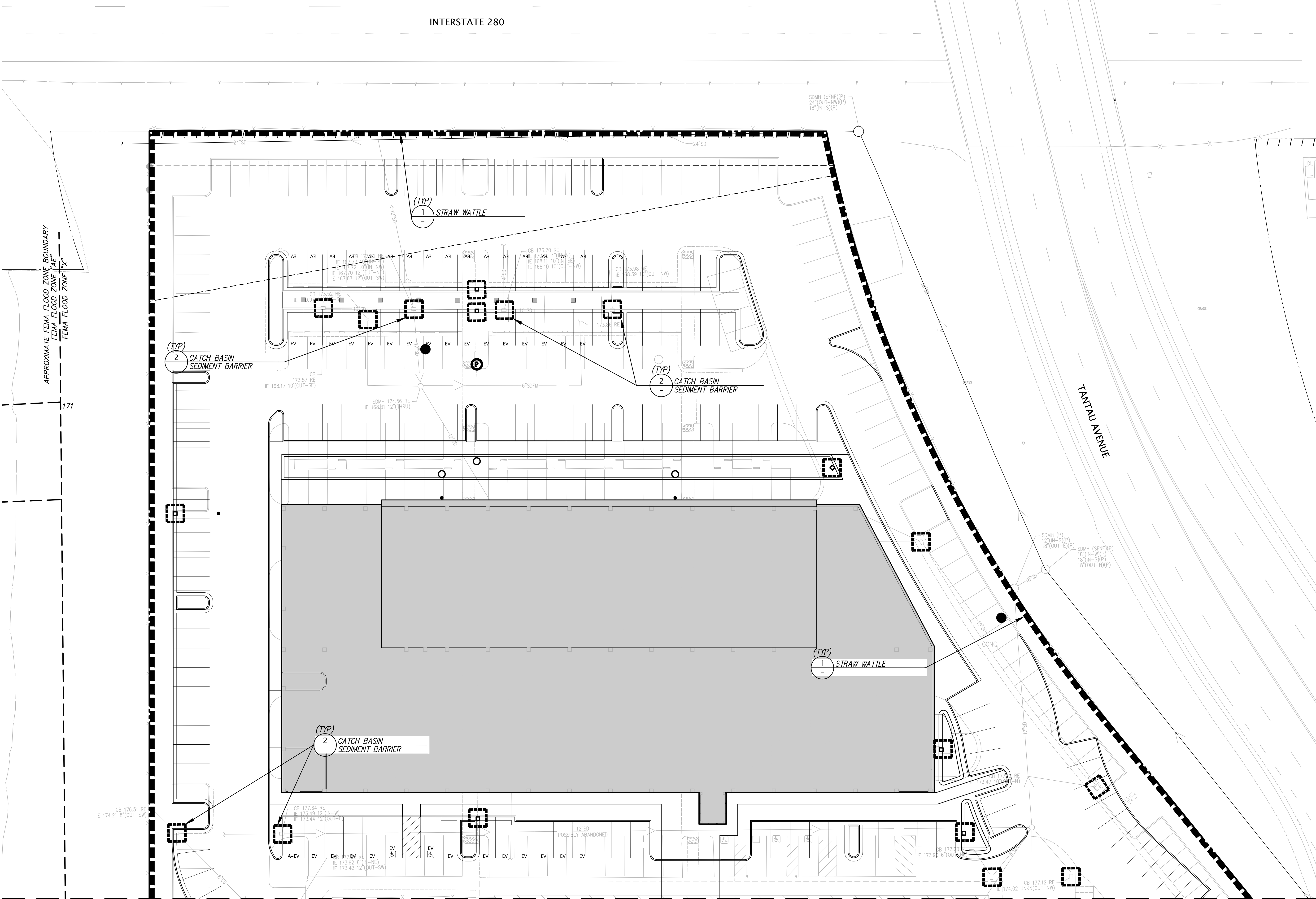

- NOTES:
- FIBER ROLL COMPOSED OF BIO-DEGRADABLE FIBERS STUFFED INTO A PHOTO-DEGRADABLE OPEN WEAVE NETTING.
  - FIBER ROLL EROSION BARRIER TRAPS SEDIMENT AND REDUCES SHEET AND HILL SIDE EROSION BY REDUCING SLOPE GRADIENT, IT INCREASING INFILTRATION RATES AND BY PRODUCING A FAVORABLE ENVIRONMENT FOR PLANT ESTABLISHMENT.
  - FIBER ROLL INSTALLATION REQUIRES THE PLACEMENT AND SECURE STAKING OF THE FIBER ROLL IN A TRENCH 3"-5" DEEP, DUG ON CONTOUR. RUNOFF MUST NOT BE ALLOWED TO RUN UNDER OR AROUND FIBER ROLL.

### STRAW WATTLE

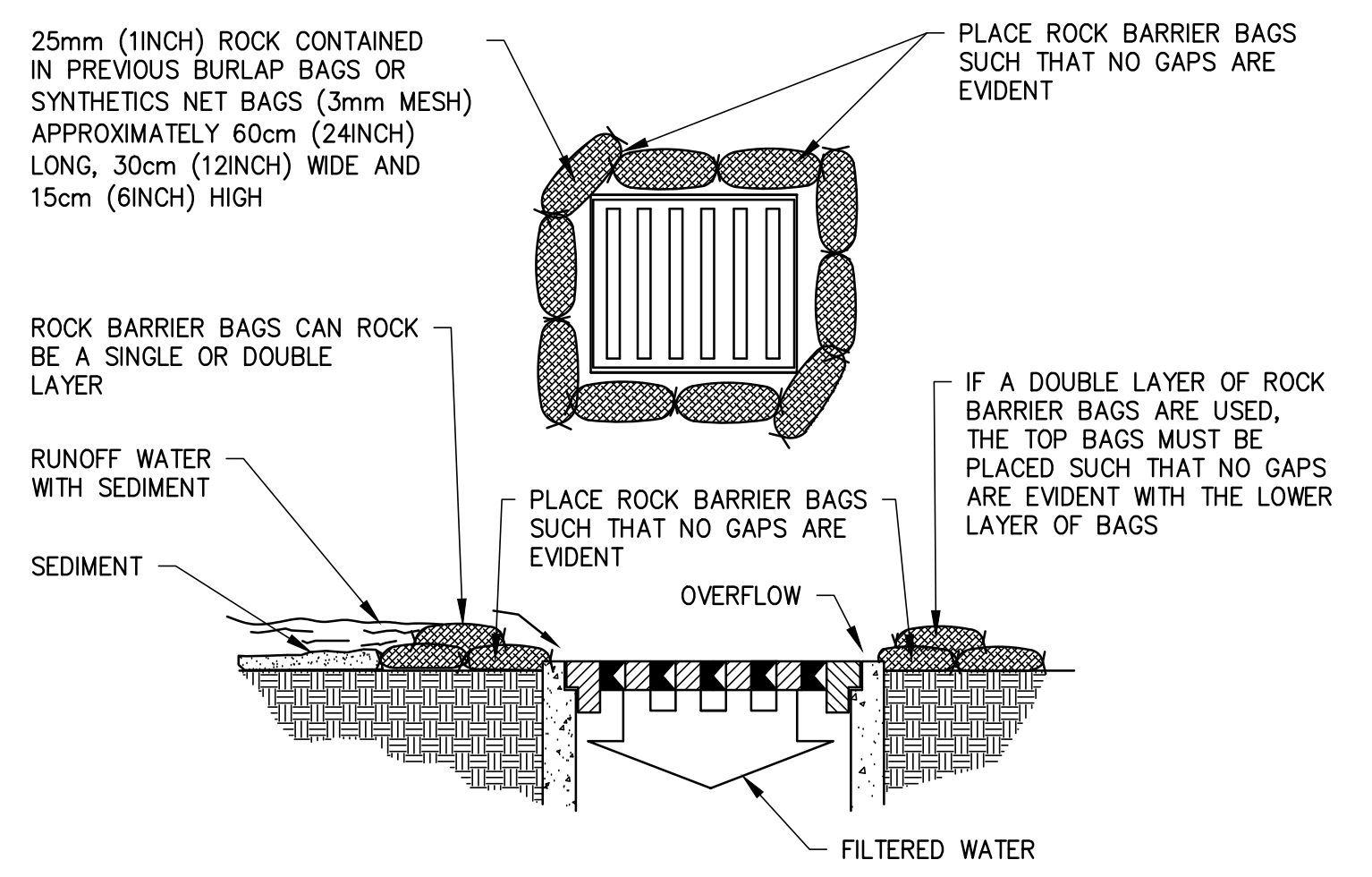

### CATCH BASIN SEDIMENT BARRIER

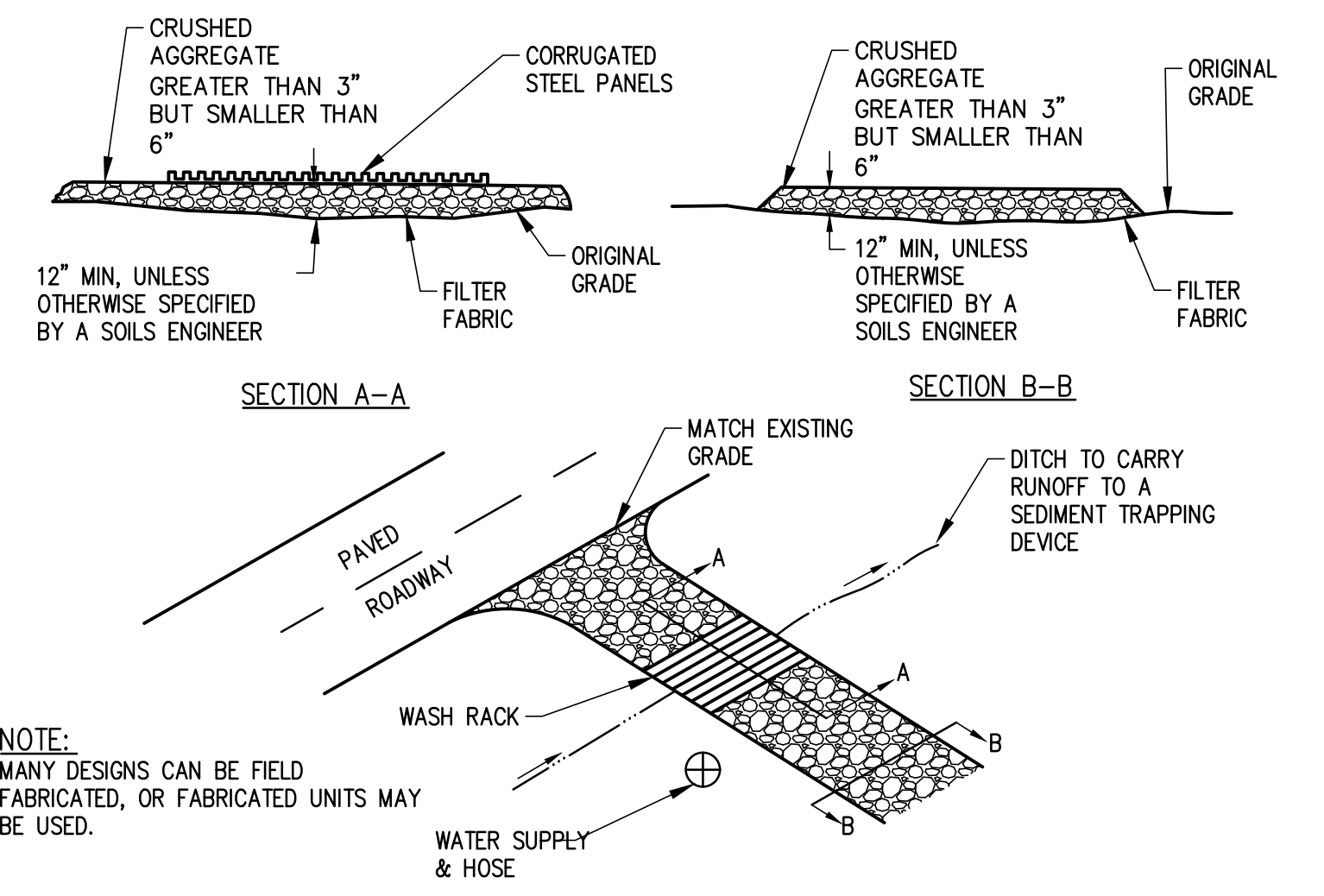

### STABILIZED CONSTRUCTION ENTRANCE

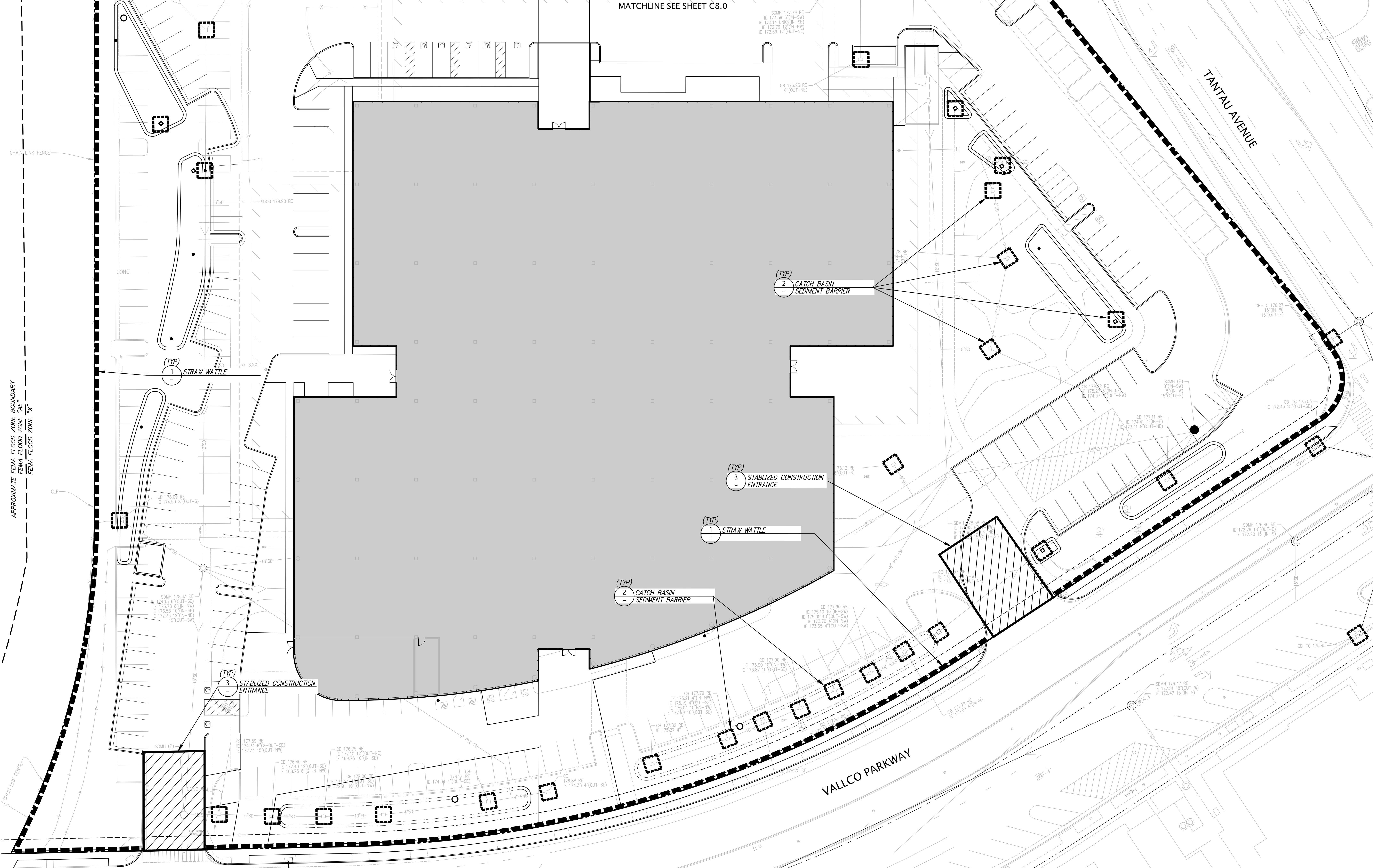

MATCHLINE SEE SHEET C8.0

SDMH 177.79 RE  
E 173.39 4' (N-SW)  
E 173.14 4' (N-NW)  
E 172.78 12' (N-NW)  
E 172.69 12' (O1-NE)

CB 176.23 RE  
6' (OUT-NE)

(TYP)  
2 CATCH BASIN  
SEDIMENT BARRIER

(TYP)  
3 STABILIZED CONSTRUCTION  
ENTRANCE

(TYP)  
1 STRAW WATTLE

(TYP)  
2 CATCH BASIN  
SEDIMENT BARRIER

(TYP)  
3 STABILIZED CONSTRUCTION  
ENTRANCE

CHAIN LINK FENCE

APPROXIMATE FEMA FLOOD ZONE BOUNDARY  
FEMA FLOOD ZONE 'A'  
FEMA FLOOD ZONE 'X'

TANTAU AVENUE

VALLCO PARKWAY



0 10 20 40 60  
Scale 1" = 20'